

# ANTENNA CORD SUB-ASSY REPLACEMENT

67067-01

HINT:

COMPONENTS: [See page 67-1](#)

1. ☐ SEPARATE BATTERY NEGATIVE TERMINAL ([See page 60-1](#))
2. ☐ INSPECT CENTER FRONT WHEEL ([See page 50-6](#))
3. REMOVE HORN BUTTON ASSY  
([See page 60-15](#))
4. ☐ REMOVE STEERING WHEEL ASSY  
([See page 50-6](#))  
SST 09950-50012 (09951-05010, 09952-05010, 09953-05020, 09954-05020)
5. REMOVE FRONT PILLAR GARNISH RH(W/O CURTAIN SHIELD AIR BAG)  
([See page 71-10](#))
6. REMOVE FRONT PILLAR GARNISH RH(W/ CURTAIN SHIELD AIR BAG)  
([See page 71-10](#))
7. REMOVE FRONT PILLAR GARNISH LH(W/O CURTAIN SHIELD AIR BAG)  
([See page 71-10](#))
8. REMOVE FRONT PILLAR GARNISH LH(W/ CURTAIN SHIELD AIR BAG)  
([See page 71-10](#))
9. REMOVE INSTRUMENT CLUSTER FINISH PANEL SUB-ASSY CENTER  
([See page 71-10](#))
10. REMOVE INSTRUMENT CLUSTER FINISH PANEL END  
([See page 71-10](#))
11. REMOVE AIR CONDITIONING CONTROL ASSY  
([See page 71-10](#))
12. ☐ REMOVE RADIO BRACKET NO.1&NO.2 ([See page 71-10](#))
13. REMOVE INSTRUMENT CLUSTER FINISH PANEL  
([See page 71-10](#))
14. ☐ REMOVE COMBINATION METER ASSEMBLY ([See page 71-10](#))
15. REMOVE GLOVE COMPARTMENT DOOR STOPPER SUB-ASSY  
([See page 71-10](#))
16. REMOVE GLOVE COMPARTMENT DOOR ASSY  
([See page 71-10](#))
17. ☐ SEPARATE PASSENGER AIRBAG CONNECTOR ([See page 71-10](#))
18. REMOVE COOLER (SOLAR SENSOR) THERMISTOR(AUTO AIR CONDITIONER)  
([See page 71-10](#))
19. REMOVE INSTRUMENT PANEL REGISTER ASSY NO.1  
([See page 71-10](#))
20. REMOVE INSTRUMENT PANEL REGISTER ASSY NO.2  
([See page 71-10](#))
21. REMOVE INSTRUMENT PANEL SUB-ASSY  
([See page 71-10](#))
22. REMOVE FRONT DOOR SCUFF PLATE RH  
([See page 71-10](#))
23. REMOVE FRONT DOOR SCUFF PLATE LH  
([See page 71-10](#))
24. REMOVE COWL SIDE TRIM SUB-ASSY RH  
([See page 71-10](#))

25. REMOVE COWL SIDE TRIM BOARD LH  
(See page 76-23)
26. REMOVE FRONT DOOR OPENING TRIM WEATHERSTRIP RH  
(See page 76-23)
27. REMOVE FRONT DOOR OPENING TRIM WEATHERSTRIP LH  
(See page 76-23)
28. REMOVE INNER REAR VIEW MIRROR STAY HOLDER COVER  
(See page 76-23)
29. REMOVE INNER REAR VIEW MIRROR ASSY  
(See page 76-23)
30. REMOVE RH VISOR ASSY  
(See page 76-23)
31. REMOVE LH VISOR ASSY  
(See page 76-23)
32. REMOVE MAP LAMP ASSY  
(See page 76-23)
33. REMOVE ASSIST GRIP COVER  
(See page 76-23)
34. REMOVE ASSIST GRIP SUB-ASSY  
(See page 76-23)
35. REMOVE VISOR HOLDER  
(See page 76-23)

### 36. REMOVE W/HOLDER ANTENNA ASSY

- (a) Pull down front part of the roof headlining.
- (b) Disengage the clamps.
- (c) Remove the nut and antenna cord sub-assy from the w/holder antenner assy.

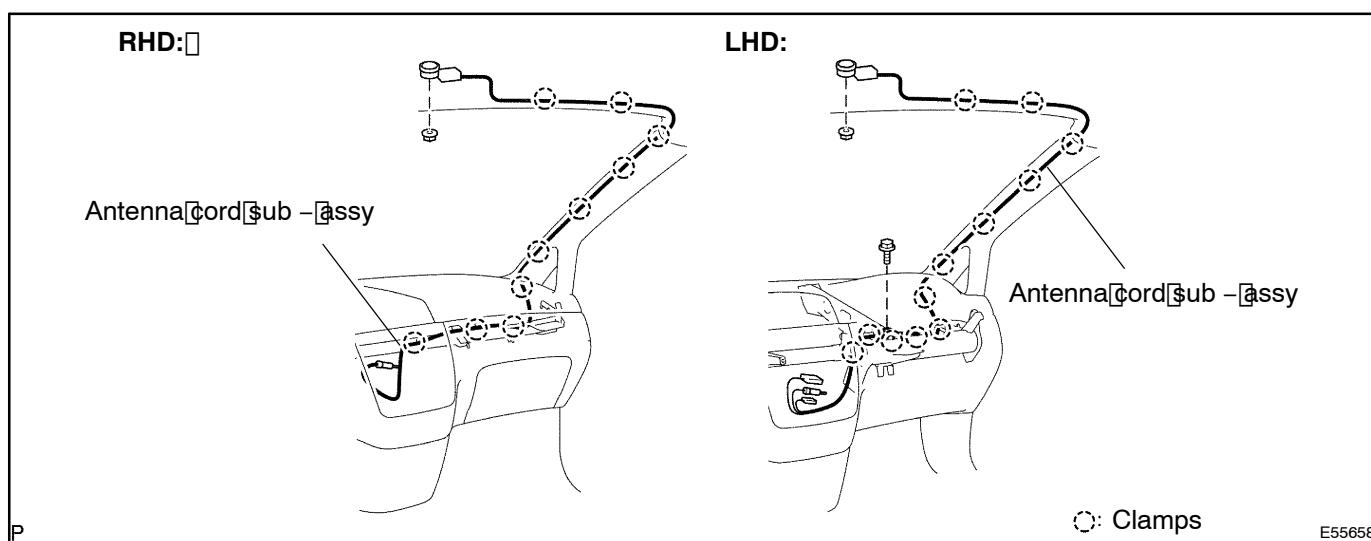

### 37. INSTALL INSTRUMENT PANEL SUB-ASSY

### 38. INSTALL FRONT PILLAR GARNISH LH(W/ CURTAIN SHIELD AIR BAG) (See page 71-10)

- 39. □ INSTALL FRONT PILLAR GARNISH RH(W/ CURTAIN SHIELD AIR BAG)  
(See page 71-10)
- 40. □ CENTER SPIRAL CABLE (See page 71-10)
- 41. INSTALL STEERING WHEEL ASSY  
(See page 50-6)
- 42. □ INSPECT STEERING WHEEL CENTER POINT (See page 50-6)
- 43. INSPECT HORN BUTTON ASSY  
(See page 60-15)
- 44. INSTALL HORN BUTTON ASSY  
(See page 60-15)
- 45. INSPECT SRS WARNING LIGHT