

OVERHAUL

HINT:

COMPONENTS: [See page 55-53](#)

1. REMOVE INSTRUMENT PANEL LOWER

([See page 71-10](#))

HINT:

Refer to the instructions for removal of the instrument panel lower.

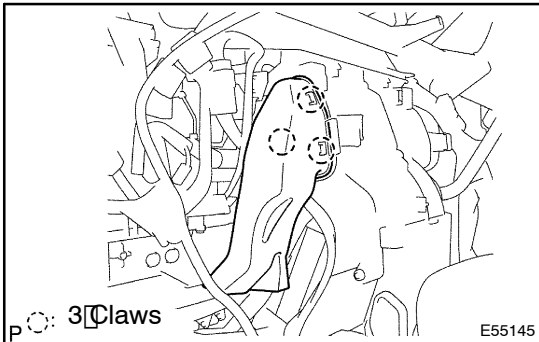

2. REMOVE AIR DUCT NO. 1

- (a) Release the 3 claw fittings, remove the air duct No. 1.

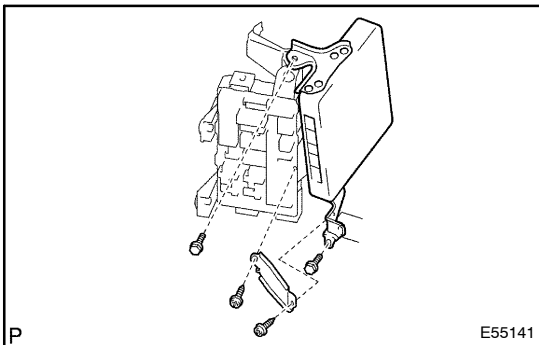

3. SEPARATE ECM

- (a) Remove the 2 screws and engine control computer bracket No. 4.
(b) Remove the 2 bolts and ECM with connectors still connected.

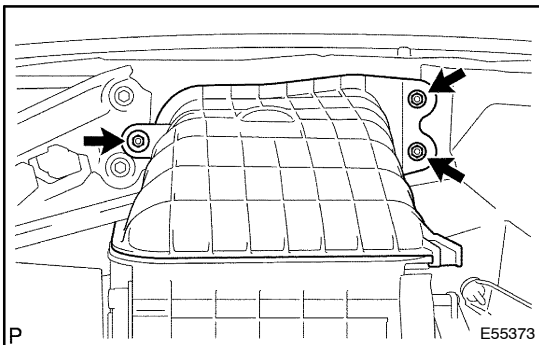

4. REMOVE AIR DUCT SUB-ASSY

- (a) Remove the 3 nuts and air duct sub-assy.

5. REMOVE BLOWER ASSY

- (a) Disconnect the connector and clamp of the cooling unit motor w/ fan sub-assy and blower damper servo sub-assy.
(b) Except 2 way flow heater:
Disconnect the blower resistor connector.
(c) Remove the screw and blower relay bracket.

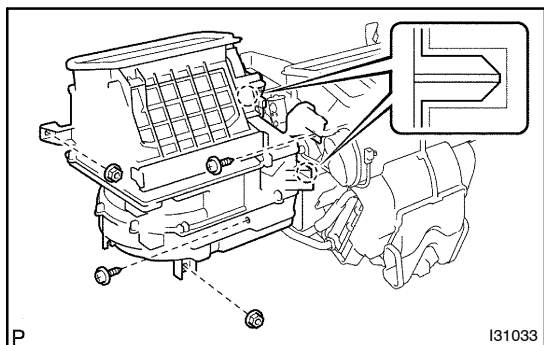

- (d) Remove the 2 screws and 2 nuts.
- (e) Disconnect the part fit to the air conditioner radiator assy and remove the blower assy.

6. REMOVE AIR REFINER ELEMENT

- (a) Remove the air refiner sub-assy from the blower assy.
- (b) Remove the air refiner element from the air refiner sub-assy.

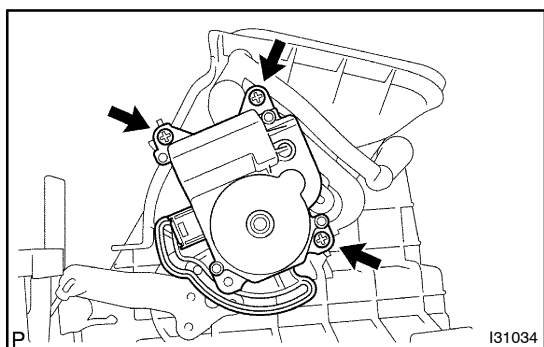

7. REMOVE BLOWER DAMPER SERVO SUB-ASSY

- (a) Remove the 3 screws and blower damper servo sub-assy.

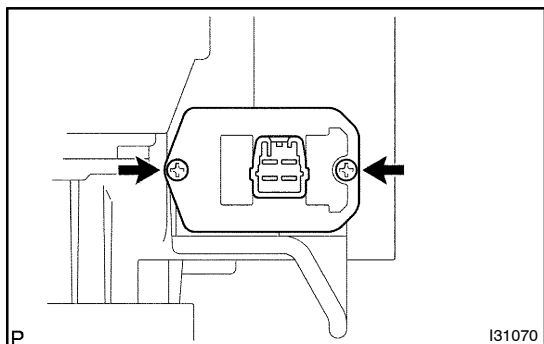

8. REMOVE BLOWER RESISTOR(EXCEPT 2 WAY FLOW HEATER)

- (a) Remove the 2 screws and blower resistor.

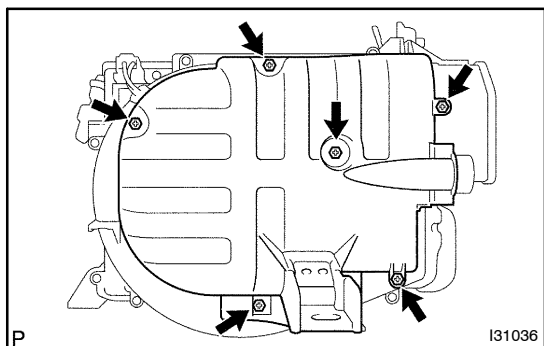

9. REMOVE BLOWER W/FAN MOTOR SUB-ASSY

- (a) 2 way flow heater:
Remove the 6 screws and blower motor case.
- (b) 2 way flow heater:
Disconnect the connector, remove the cooler wiring No. 1.

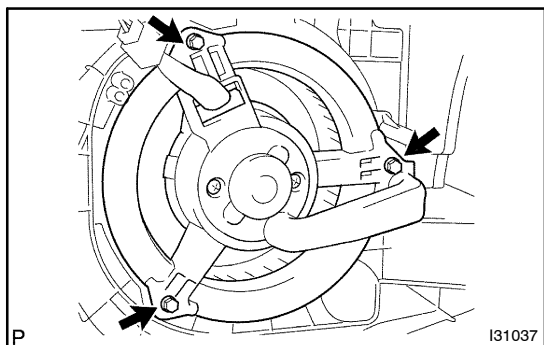

(c) Remove the 3 screws and blower w/fan motor sub-assy.

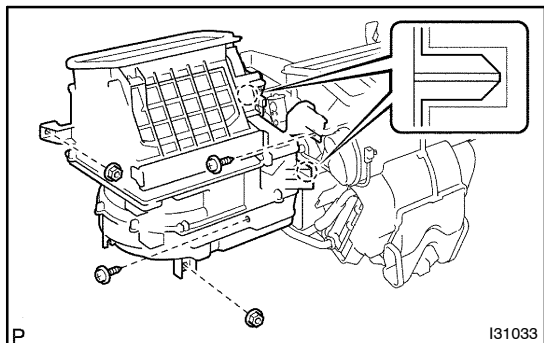

10. INSTALL BLOWER ASSY

- Aligning the part to be fit with that of the air conditioner radiator Assy, install the blower Assy.
- Install the blower Assy with the 2 nuts and 2 screws.
- Install the blower relay bracket with the screw.
- Except 2-way flow heater:
Connect the blower resistor connector.
- Install the connector and clamp.

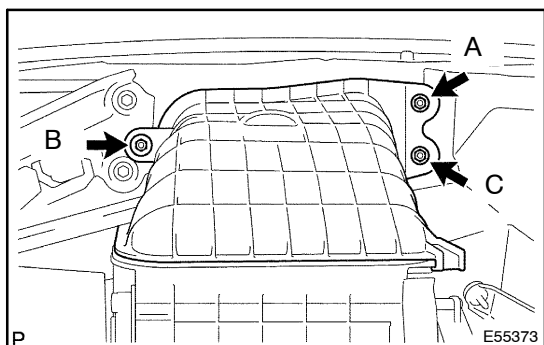

11. INSTALL AIR DUCT SUB-ASSY

- Install the air duct sub-assy with the 3 nuts.

HINT:

Tighten in the order of A, B, C.

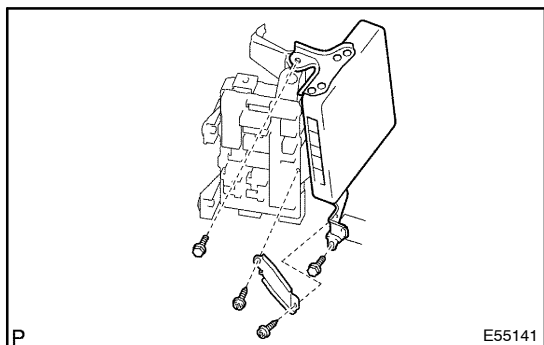

12. INSTALL ECM

- Install the ECM with the 2 bolts.
Torque: 5.5 N·m (55 kgf·cm, 49 in.·lb)
- Install the engine control computer bracket No. 4 with the 2 screws.

13. INSTALL INSTRUMENT PANEL SUB-ASSY

(See page 71-10)