

CLUTCH PEDAL SUB-ASSY (LHD)

REPLACEMENT

42011-01

1. REMOVE INSTRUMENT CLUSTER FINISH PANEL
(See page 71-10)
2. REMOVE COMBINATION METER ASSEMBLY (See page 71-19)
3. REMOVE INSTRUMENT PANEL FINISH LOWER PANEL LH
(See page 71-10)
4. DRAIN CLUTCH FLUID
5. SEPARATE CLUTCH RESERVOIR TUBE

(a) Loosen the clip and separate the clutch reservoir tube from the clutch master cylinder.

HINT:

Use a container to catch the fluid.

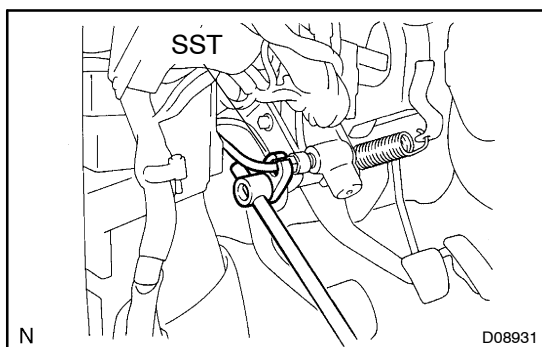

6. SEPARATE CLUTCH MASTER CYLINDER TO FLEXIBLE HOSE TUBE

- (a) Using SST, disconnect the flexible hose tube.
SST 09023-00100

HINT:

Use a container to catch the fluid.

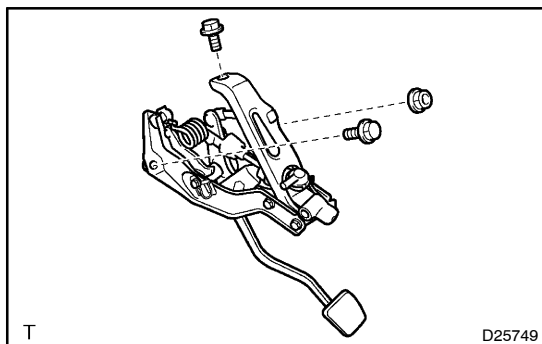

7. REMOVE CLUTCH PEDAL SUPPORT SUB-ASSY

- (a) Remove the 2 bolts and nut.
- (b) Remove the clutch pedal support.

8. REMOVE CLUTCH MASTER CYLINDER PUSH ROD CLEVIS W/HOLE PIN

- (a) Remove the clip and hole pin.

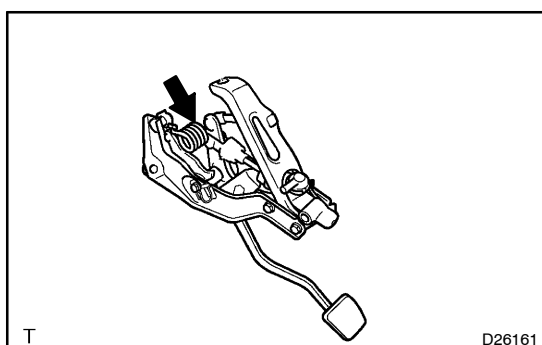

9. REMOVE TURN OVER SPRING SEAT COMPRESSION SPRING

- (a) Remove the turn over spring.

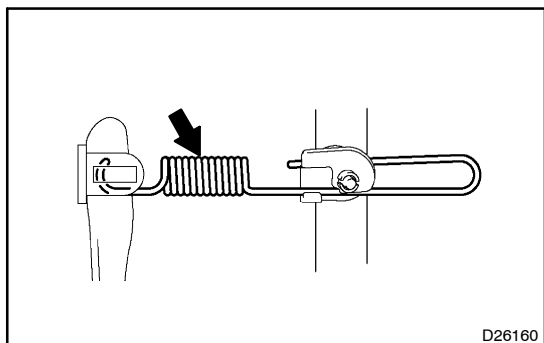

10. REMOVE CLUTCH PEDAL SPRING(1CD-FTV ENGINE TYPE)

- (a) Remove the clutch pedal spring.

11. REMOVE CLUTCH PEDAL SUB-ASSY

- (a) Mount the clutch pedal in a soft jaw vise.
- (b) Remove the bolt, nut and washer.
- (c) Remove the clutch pedal from the clutch pedal support.

12. REMOVE CLUTCH PEDAL BUSH

- (a) Remove the 2 bushes from the clutch pedal.

13. REMOVE CLUTCH PEDAL SHAFT COLLAR

14. REMOVE CLUTCH PEDAL TURNOVER BUSH

15. REMOVE CLUTCH PEDAL PAD

16. REMOVE PEDAL SPRING HOOK(1CD-FTV ENGINE TYPE)

17. REMOVE CLUTCH PEDAL NO.1 CUSHION

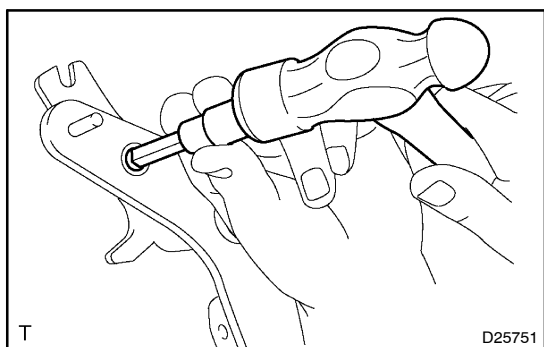

18. REMOVE CLUTCH MASTER CYLINDER PUSH ROD CLEVIS BUSH

- (a) Using 8 mm hexagon wrench and hammer, remove the bush from the clutch pedal.

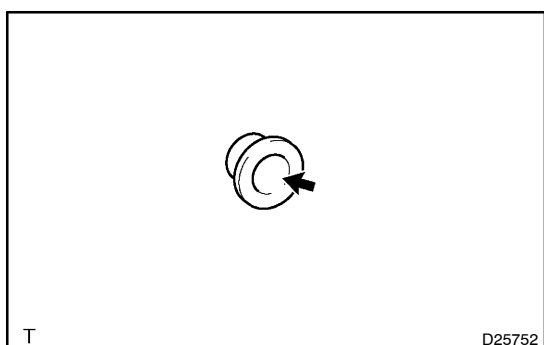

19. INSTALL CLUTCH MASTER CYLINDER PUSH ROD CLEVIS BUSH

- (a) Apply MP grease to inside of a new bush.
- (b) Install the bush to the clutch pedal.

20. INSTALL CLUTCH PEDAL NO.1 CUSHION**21. INSTALL PEDAL SPRING HOOK(1CD-FTV ENGINE TYPE)****22. INSTALL CLUTCH PEDAL PAD****23. INSTALL CLUTCH PEDAL TURNOVER BUSH**

- (a) Apply MP grease to inside of a new bush.
- (b) Install the bush to the clutch pedal.

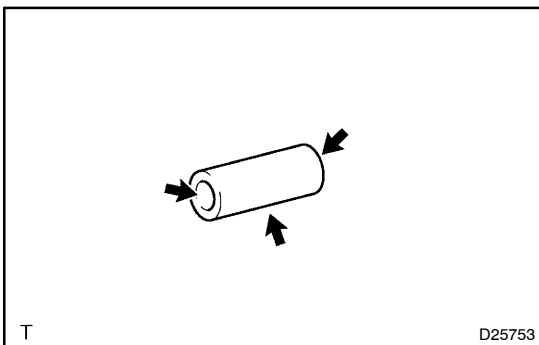
**24. INSTALL CLUTCH PEDAL SHAFT COLLAR**

- (a) Apply MP grease to inside and outside of a collar.
- (b) Install the collar to the clutch pedal.

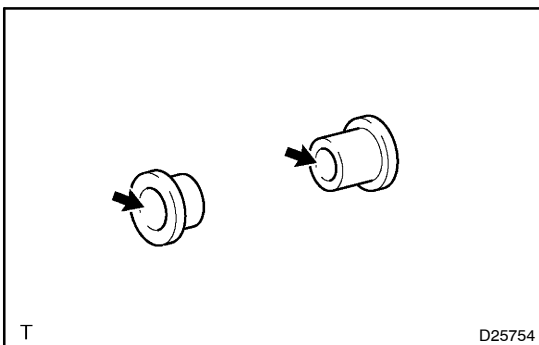
**25. INSTALL CLUTCH PEDAL BUSH**

- (a) Apply MP grease to both side of 2 new bushes.
- (b) Install the 2 new bushes to the clutch pedal.

26. INSTALL CLUTCH PEDAL SUB-ASSY

- (a) Install the clutch pedal to the clutch pedal support with the bolt, washer and nut.

Torque: 25.5 N·m (260 kgf·cm, 18 ft·lbf)

HINT:

Install the bolt from the left side of the vehicle.

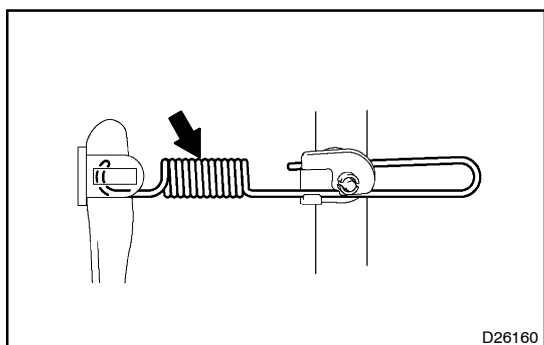

27. INSTALL CLUTCH PEDAL SPRING(1CD-FTV ENGINE TYPE)

- (a) Install the clutch pedal spring.

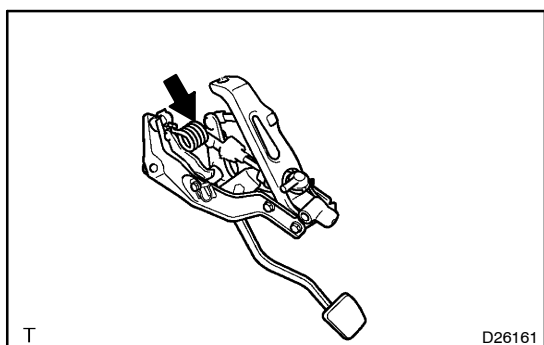

28. INSTALL TURN OVER SPRING SEAT COMPRESSION SPRING

- (a) Apply MP grease to the contact surface of the bush and spring.
- (b) Install the turn over spring to the clutch pedal and clutch pedal support.

29. INSTALL CLUTCH MASTER CYLINDER PUSH ROD CLEVIS W/HOLE PIN

- (a) Apply MP grease to the contact surface of the push rod clevis and bush.
- (b) Connect the clevis to the clutch pedal with the hole pin.

HINT:

Install the hole pin from the left side of the vehicle.

- (c) Install the clip to the hole pin.

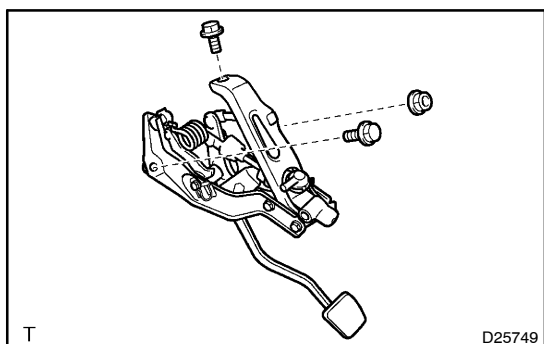

30. INSTALL CLUTCH PEDAL SUPPORT SUB-ASSY

- (a) Install the clutch pedal support to the vehicle with the 2 bolts and nut.

Torque:

Bolt: 19 N·m (194 kgf·cm, 14 ft·lbf)

Nut: 12.7 N·m (130 kgf·cm, 9 ft·lbf)

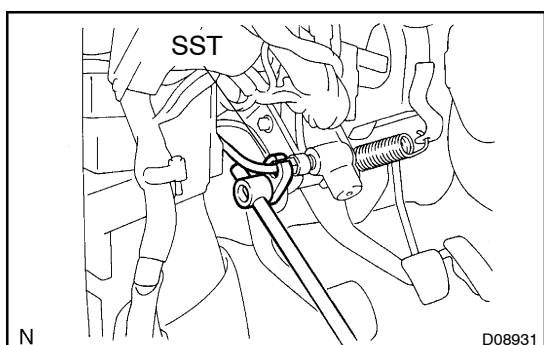

31. INSTALL CLUTCH MASTER CYLINDER TO FLEXIBLE HOSE TUBE

- (a) Using SST, connect the flexible hose tube.

SST 09023-00100

Torque: 15 N·m (155 kgf·cm, 11 ft·lbf)

32. INSTALL CLUTCH RESERVOIR TUBE

- (a) Connect the clutch reservoir tube with the clip to the clutch master cylinder.

NOTICE:

Connect the clutch reservoir tube so that it will not be twisted.

33. BLEED CLUTCH PIPE LINE

- (a) Fill the brake reservoir tank with brake fluid and bleed clutch system.

Torque: 8.3 N·m (85 kgf·cm, 73 in·lbf)

34. INSPECT AND ADJUST CLUTCH PEDAL SUB-ASSY

(See [page 42-2](#))

35. CHECK CLUTCH FLUID LEAKAGE**36. CHECK FLUID LEVEL IN RESERVOIR**