

ON-VEHICLE INSPECTION

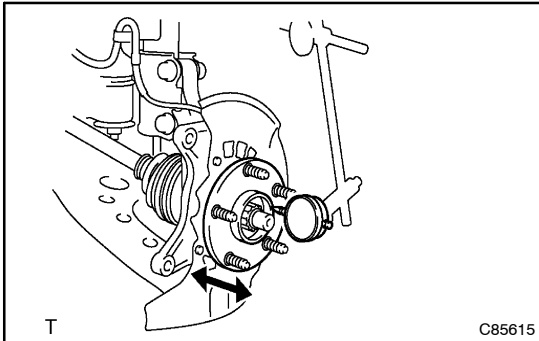

1. INSPECT FRONT AXLE HUB BEARING BACKLASH

- (a) Using a dial indicator, check the backlash near the center of the axle hub.

Maximum: 0.05 mm (0.0020 in.)

If the backlash exceeds the maximum, replace the bearing.

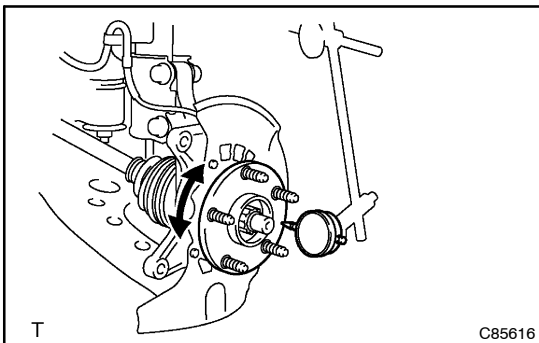

2. INSPECT FRONT AXLE HUB DEVIATION

- (a) Using a dial indicator, check the deviation at the surface of the axle hub outside the hub bolt.

Maximum: 0.07 mm (0.0027 in.)

If the backlash exceeds the maximum, replace the axle hub.

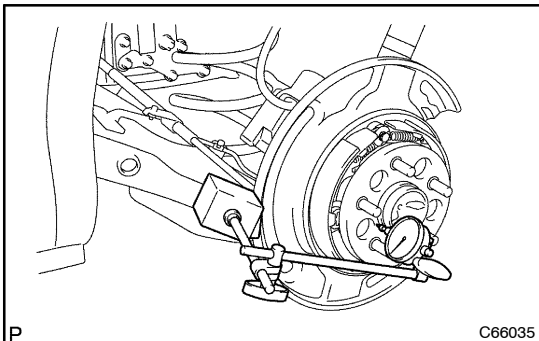

3. INSPECT REAR AXLE HUB BEARING BACKLASH

- (a) Set a dial indicator near the center of the axle hub and check the backlash in the bearing shaft direction.

Maximum: 0.05 mm (0.0020 in.)

If the backlash exceeds the maximum, replace the axle hub assembly.

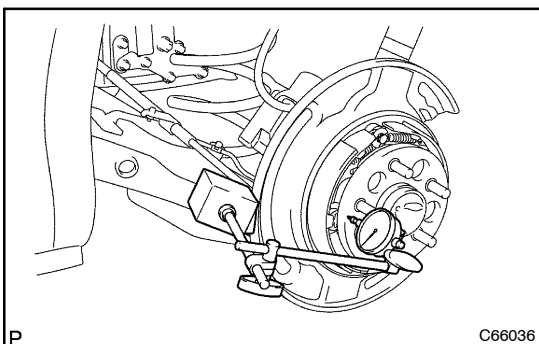

4. INSPECT REAR AXLE HUB DEVIATION

- (a) Using a dial indicator, check the deviation at the surface of the axle hub outside the hub bolt.

Maximum: 0.07 mm (0.0027 in.)

If the backlash exceeds the maximum, replace the axle hub assembly.