

TURBOCHARGER SUB-ASSY (1CD-FTV)

1301P-01

REPLACEMENT

1. DRAIN ENGINE COOLANT (See page 6-6)
2. REMOVE BATTERY
3. REMOVE AIR CLEANER ASSY
4. REMOVE HOOD SUB-ASSY
5. REMOVE FR WIPER ARM RH
(See page 6-9)
6. REMOVE FR WIPER ARM LH
(See page 6-9)
7. REMOVE COWL TOP VENTILATOR LOUVER SUB-ASSY
8. REMOVE WINDSHIELD WIPER MOTOR ASSY
(See page 6-9)
9. REMOVE COWL TOP PANEL SUB-ASSY OUTER
(See page 1-23)
10. REMOVE AIR TUBE NO.1
 - (a) Disconnect the 5 vacuum hoses.
 - (b) Disconnect the connector.
 - (c) Remove the bolt, nut and air tube.
11. REMOVE EXHAUST PIPE ASSY FRONT
12. REMOVE EXHAUST PIPE ASSY CENTER

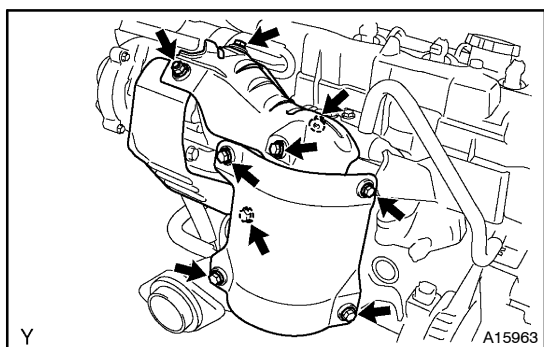

13. REMOVE MANIFOLD CONVERTER SUB-ASSY

- (a) Remove 4 bolts and No. 2 turbo heat insulator.
- (b) Remove the nut, 3 bolts and No. 1 turbo heat insulator.
- (c) Remove the 2 bolts and No. 2 exhaust manifold heat insulator.
- (d) Remove 3 bolts and No. 2 exhaust manifold converter stay from the cylinder head.

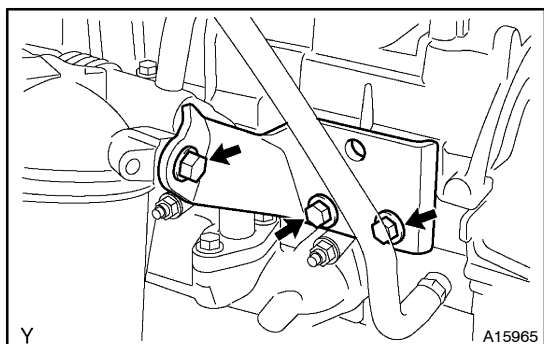

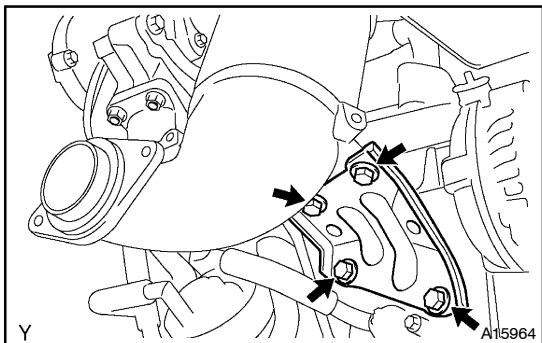

- (e) Remove 4 bolts and No. 1 exhaust manifold converter stay from the cylinder block.

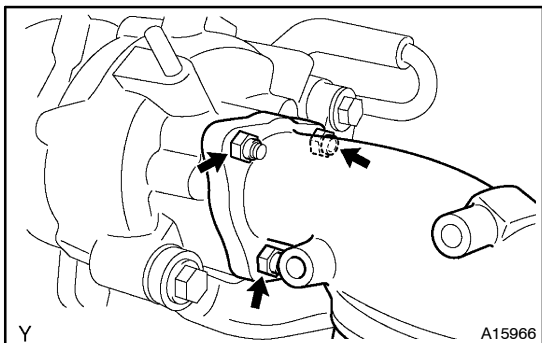

- (f) Remove 3 nuts, exhaust manifold converter and gasket.

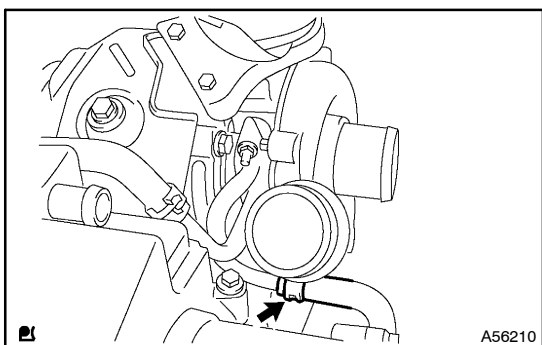

14. SEPARATE TURBO WATER HOSE NO.2

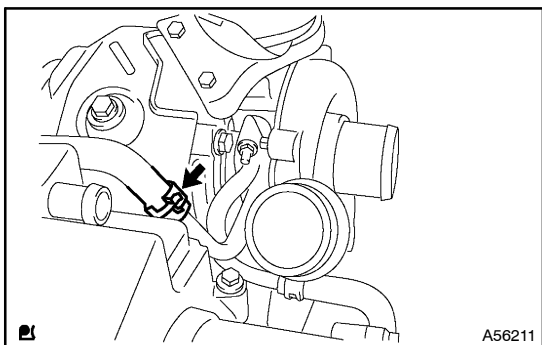

15. SEPARATE TURBO WATER HOSE NO.1

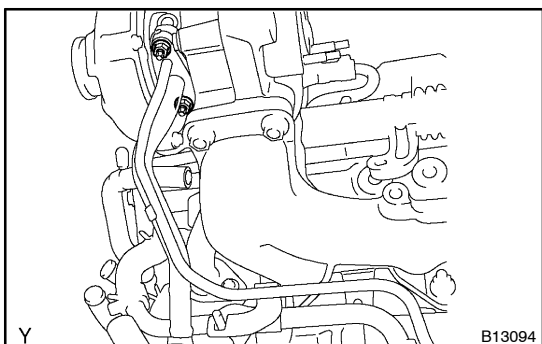

16. SEPARATE TURBO OIL INLET PIPE SUB-ASSY

- (a) Remove the 2 nuts, gasket and turbo oil pipe.

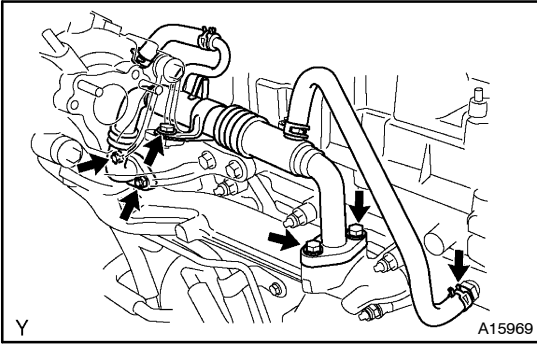
**17. REMOVE EGR PIPE SUB-ASSY NO.1**

- (a) Disconnect the hose from the PCV valve.
- (b) Remove the EGR cooler pipe stay bolt from the turbo-charger bracket.
- (c) Remove the 2 bolts and gasket, disconnect the EGR cooler pipe from the exhaust manifold.
- (d) Remove the 2 nuts, EGR cooler pipe and gasket from the cylinder head.

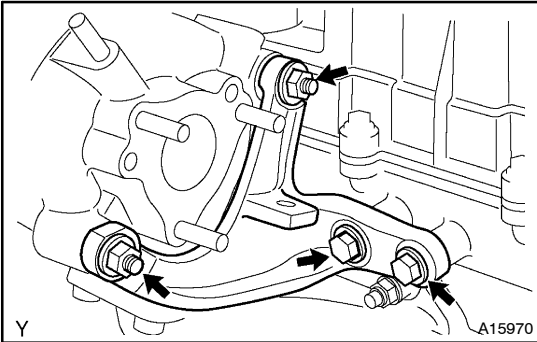
**18. REMOVE TURBOCHARGER STAY**

- (a) Remove the 2 bolts, 2 nuts and turbocharger stay.

19. REMOVE TURBOCHARGER SUB-ASSY

- (a) Remove 3 nuts, gasket and turbo charger sub-assy.

20. REMOVE TURBO WATER PIPE SUB-ASSY NO.1

- (a) Remove 2 nuts, gasket and turbo water pipe.

21. INSTALL TURBO WATER PIPE SUB-ASSY NO.1

- (a) Install a new gasket and the water pipe with the 2 nuts.

Torque: 13 N·m (135 kgf·cm, 10 ft·lbf)

22. INSTALL TURBOCHARGER SUB-ASSY

- (a) Install a new gasket and the turbo charger sub-assy with the 3 nuts.

Torque: 53 N·m (530 kgf·cm, 39 ft·lbf)

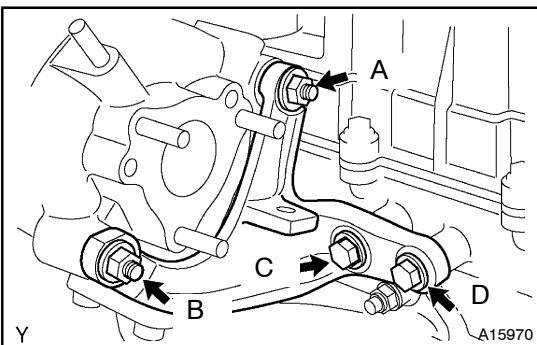
**23. INSTALL TURBOCHARGER STAY**

- (a) Install the turbocharger stay with the 2 bolts and 2 nuts.
 - (1) Install the turbocharger stay and temporarily tighten the D bolts.

Torque: 15 N·m (153 kgf·cm, 11 ft·lbf)

- (2) Temporarily tighten the A nut.

Torque: 15 N·m (153 kgf·cm, 11 ft·lbf)

- (3) Tighten the C and D bolts.

Torque: 56 N·m (571 kgf·cm, 41 ft·lbf)

- (4) Tighten the A and B nuts.

Torque: 56 N·m (571 kgf·cm, 41 ft·lbf)

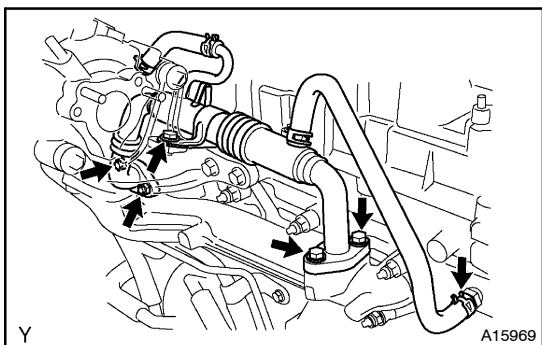

24. INSTALL EGR PIPE SUB-ASSY NO.1

- (a) Install a new gasket and connect the EGR cooler pipe with the 2 nuts to the cylinder head.
Torque: 25 N·m (255 kgf·cm, 18 ft·lbf)
- (b) Install a new gasket, and connect the EGR cooler pipe to the exhaust manifold with the 2 bolts.
Torque: 25 N·m (255 kgf·cm, 18 ft·lbf)
- (c) Install the EGR cooler pipe stay bolt.

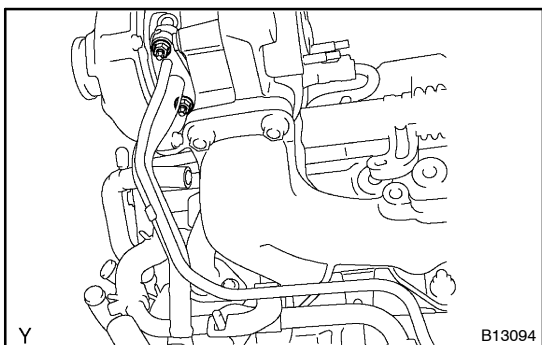

25. INSTALL TURBO OIL INLET PIPE SUB-ASSY

- (a) Install a new gasket and the turbo oil pipe sub-assy with the 2 nuts.
Torque: 13 N·m (133 kgf·cm, 9.6 ft·lbf)

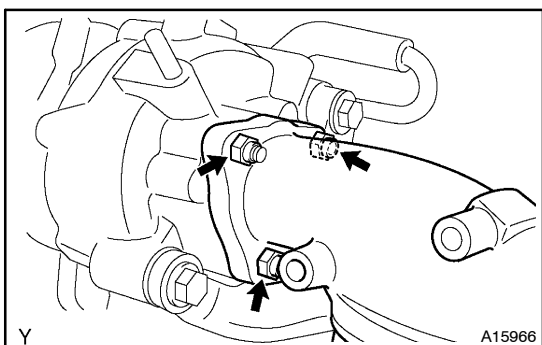

26. INSTALL MANIFOLD CONVERTER SUB-ASSY

- (a) Install a new gasket and the exhaust manifold converter with the 3 nuts.
Torque: 25 N·m (255 kgf·cm, 18 ft·lbf)

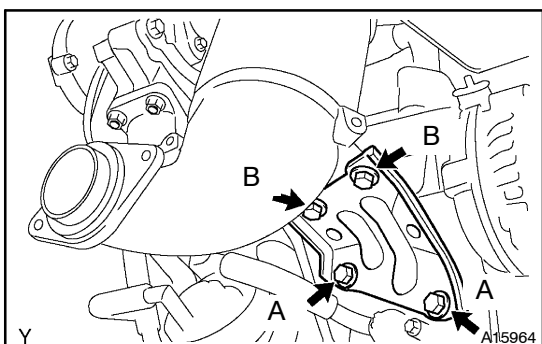

- (b) Install the No. 1 exhaust manifold converter stay with the 4 bolts to the cylinder block.
 - (1) Install the No. 1 exhaust manifold converter stay and temporarily tighten the 4 bolts.
 - (2) Tighten the 2 bolts while pushing the No.1 exhaust manifold converter stay toward the engine block.
Torque: 61 N·m (620 kgf·cm, 45 ft·lbf)
 - (3) Tighten the 2 A bolts.
Torque: 61 N·m (620 kgf·cm, 45 ft·lbf)

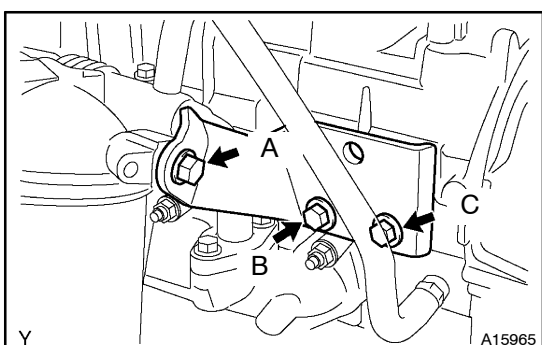

- (c) Install the No. 2 exhaust manifold converter stay with the 3 bolts to the cylinder head.
 - (1) Install the No. 2 exhaust manifold converter stay and temporarily tighten the 3 bolts.
 - (2) Temporarily tighten the B bolt while pushing the No. 2 exhaust manifold converter stay toward the manifold converter.
Torque: 15 N·m (153 kgf·cm, 11 ft·lbf)
 - (3) Tighten the A bolt.
Torque: 56 N·m (571 kgf·cm, 41 ft·lbf)

- (4) Tighten the B and C bolts.
Torque: 56 N·m (571 kgf·cm, 41 ft·lbf)

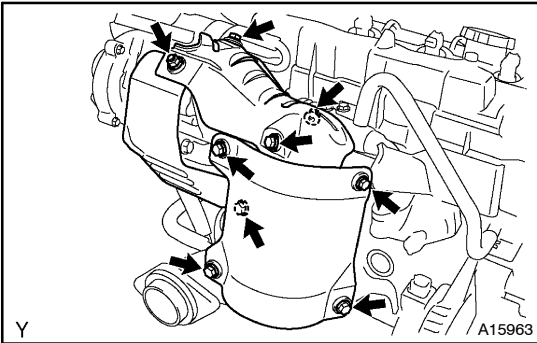

- (d) Install the exhaust manifold insulator with the 2 bolts.
Torque: 12 N·m (122 kgf·cm, 8.8 ft·lbf)
- (e) Install the turbo insulator No. 1 with the 3 bolts and the nut.
Torque:
25 N·m (255 kgf·cm, 18 ft·lbf) for bolt
18 N·m (184 kgf·cm, 13 ft·lbf) for nut
- (f) Install the turbo insulator No. 2 with the 4 bolts.
Torque: 25 N·m (255 kgf·cm, 18 ft·lbf)

27. INSTALL EXHAUST PIPE ASSY CENTER

(See [page 15-2](#))

28. INSTALL EXHAUST PIPE ASSY FRONT

(See [page 15-2](#))

29. INSTALL AIR TUBE NO.1

- (a) Install the bolt, nut and air tube.
 (b) Connect the connector.
 (c) Connect the 5 vacuum hoses.

30. INSTALL COWL TOP PANEL SUB-ASSY OUTER

(See [page 11-23](#))

31. INSTALL WINDSHIELD WIPER MOTOR ASSY

(See [page 66-9](#))

32. □ INSTALL FR WIPER ARM RH

(See [page 66-9](#))

33. INSTALL FR WIPER ARM LH

(See [page 66-9](#))

34. INSPECT HOOD SUB-ASSY

(See [page 75-1](#))

35. ADJUST HOOD SUB-ASSY

(See [page 75-1](#))

36. □ ADD COOLANT (See [page 16-19](#))

37. □ CHECK ENGINE COOLANT LEAK (See [page 16-13](#))

38. CHECK ENGINE OIL LEVEL

39. CHECK EXHAUST GAS LEAK