

Removal & Installation and Disassembly & Reassembly

1. DRAIN COOLANT (See page 16-6)
2. REMOVE AIR CLEANER CAP WITH AIR CLEANER HOSE
3. SEPARATE ACCELERATOR CONTROL CABLE ASSY

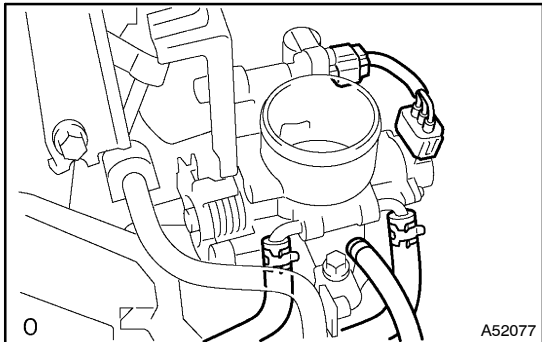

4. REMOVE THROTTLE BODY ASSY

- (a) Disconnect the throttle position sensor connector and ISC valve connector.
- (b) Disconnect the vacuum hose from the throttle body.
- (c) Disconnect 2 water by pass hoses.

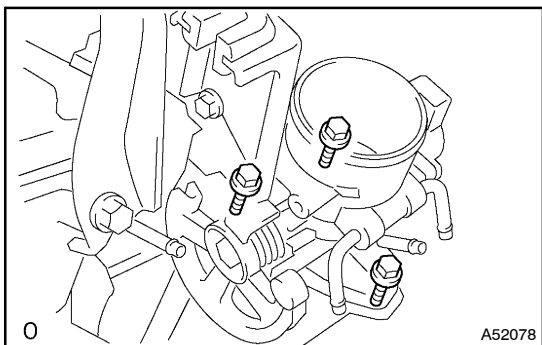

- (d) Remove 3 bolts and throttle body from intake manifold.
- (e) Remove the throttle body gasket.

5. REMOVE E.F.I. THROTTLE POSITION SENSOR

- (a) Remove 2 screw and throttle position sensor.

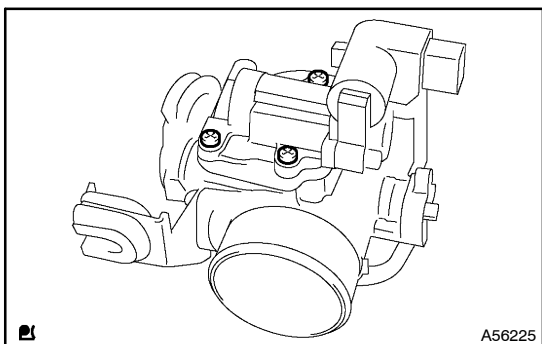

6. REMOVE THLOTTLE BODY IDLE SPEED CONTROL VALVE ASSY

- (a) Remove 3 screw and idle speed control valve.

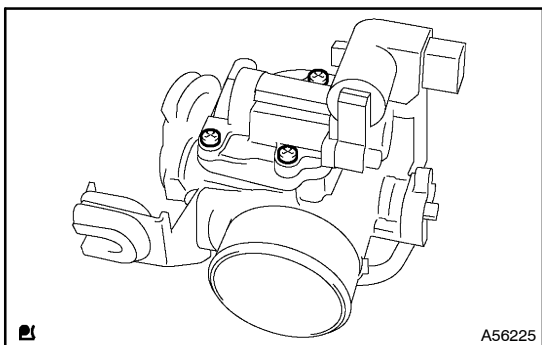

7. INSTALL THROTTLE BODY IDLE SPEED CONTROL VALVE ASSY

- (a) Install the idle speed control valve with a new gasket.

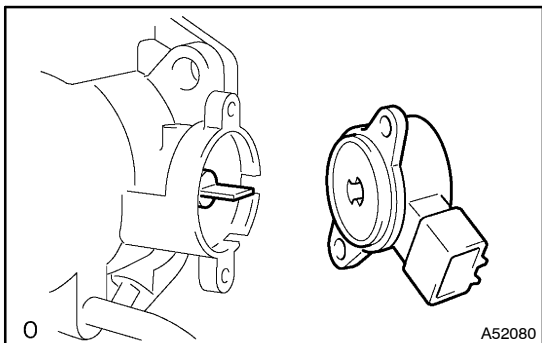

8. INSTALL E.F.I. THROTTLE POSITION SENSOR

- (a) Confirm the throttle valve is fully closed.
- (b) Revolve the sensor 45° in the left direction to the throttle valve fully closed position, and insert the sensor to the throttle body.
- (c) Revolve the sensor 45° in the right direction and install it 2 screw.

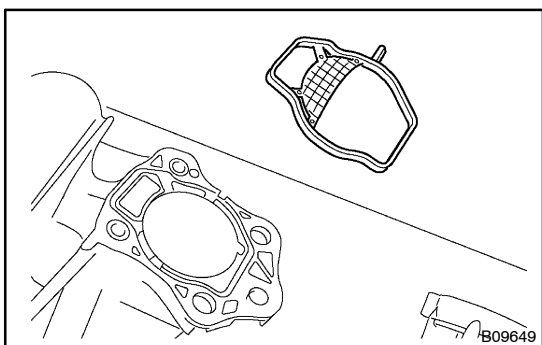

9. INSTALL THROTTLE BODY ASSY

- (a) Install a new gasket on the intake manifold, as shown in the illustration.

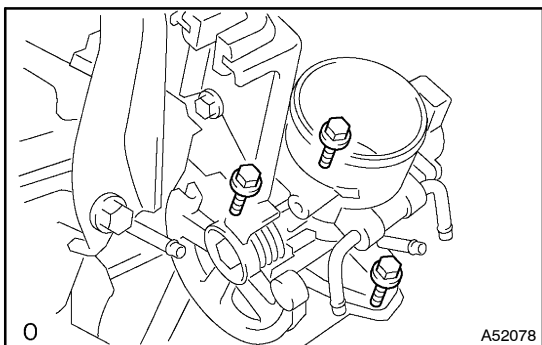

- (b) install the throttle body with 3 bolts.
Torque: 30 N·m (306 kgf·cm, 22 ft·lbf)

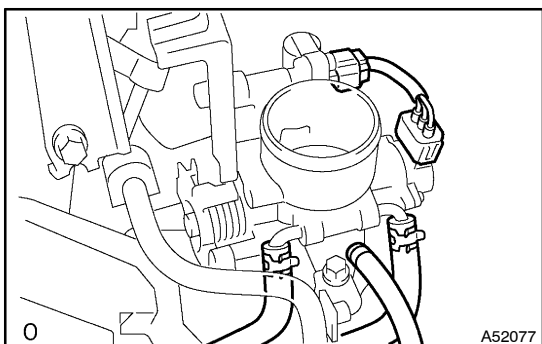

- (c) Connect 2 water by-pass hoses to the throttle body.
- (d) Connect the ISC valve connector.
- (e) Connect the vacuum hose to the throttle body.

10. DRAIN COOLANT ([See page 6-6](#))

11. INSPECT CHECK ENGINE COOLANT LEAK ([See page 6-1](#))