

OVERHAUL

CAUTION:

Wear protective gloves. Sharp surfaces on the seatback frame and seat adjuster can cause injuries to your hands.

HINT:

- The installation procedures are the removal procedures in reverse order. However, only installation procedures requiring additional information are included.
- A bolt without a torque specification is shown in the standard bolt chart (see page 03-2).

1. REMOVE REAR SEAT HEADREST ASSY

2. REMOVE REAR SEAT HEADREST ASSY CENTER

3. REMOVE REAR NO. 1 SEAT ASSY RH

- (a) Using a screwdriver, disengage the 4 claws and remove the 4 seat track covers.

HINT:

Tape the screwdriver tip before use.

- (b) Remove the 4 bolts and seat assy.

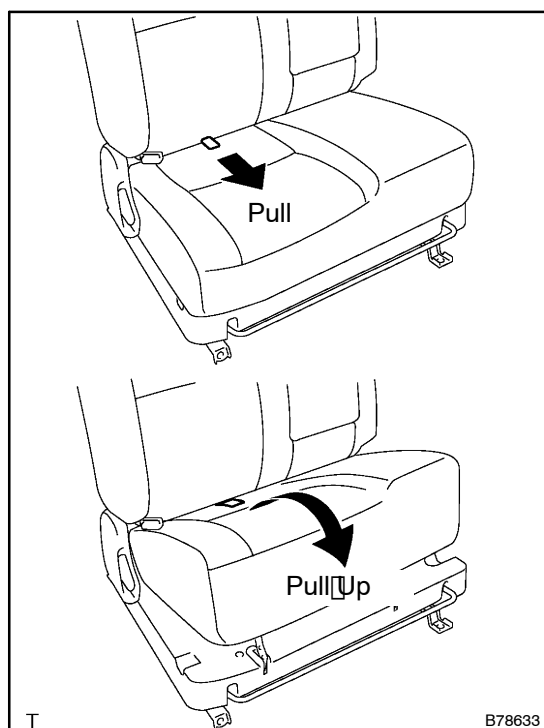

4. REMOVE REAR NO. 1 SEAT CUSHION ASSY

- (a) Pull up the seat cushion, as shown in the illustration.

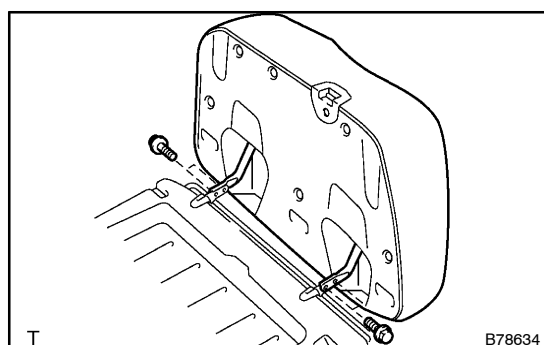

- (b) Remove the 4 bolts and seat cushion.

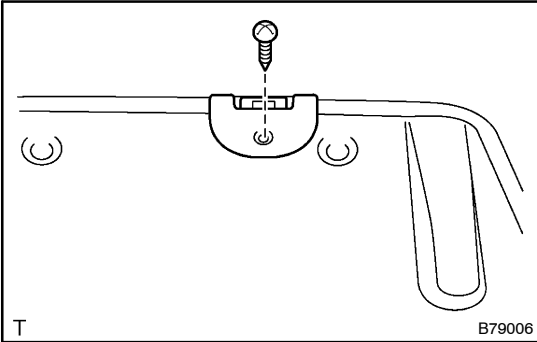

5. REMOVE REAR NO. 1 SEAT CUSHION COVER

- (a) Remove the screw and rear seat cushion lock cover.

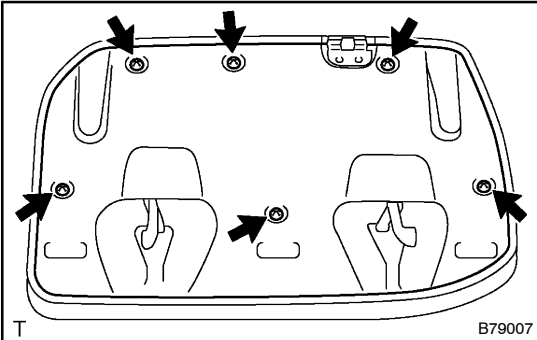

- (b) Remove the 6 clips and rear seat cushion carpet under.

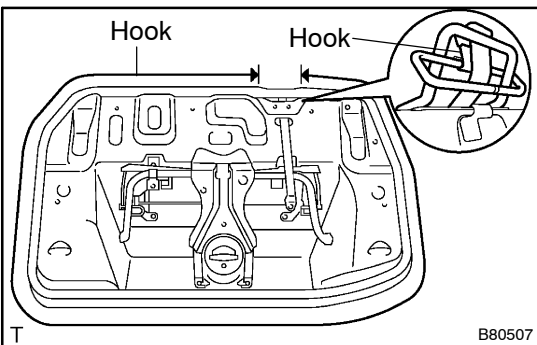

- (c) Using a screwdriver, disengage the hooks and seat cushion cover together with the pad.

HINT:

Tape the screwdriver tip before use.

- (d) Remove the hog rings and seat cushion cover.

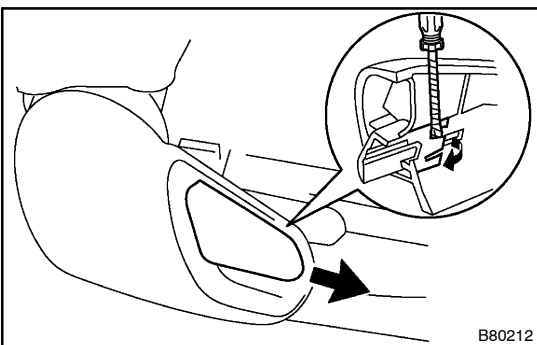

6. REMOVE RECLINING ADJUSTER RELEASE HANDLE NO.1 RH

- (a) Using a screwdriver, pry out the reclining adjuster release handle.

HINT:

Tape the screwdriver tip before use.

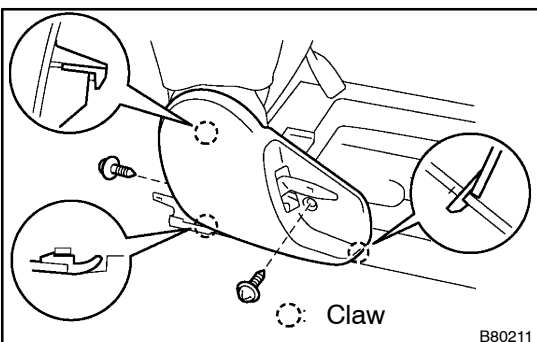

7. REMOVE RECLINING ADJUSTER COVER RH

- (a) Remove the 2 screws.
(b) Using a screwdriver, disengage the 3 claws and remove the cover.

HINT:

Tape the screwdriver tip before use.

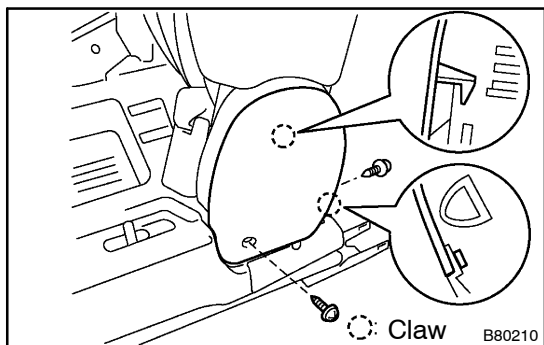
**8. REMOVE RECLINING ADJUSTER COVER LH**

- (a) Remove the 2 screws.
- (b) Using a screwdriver, disengage the 2 claws and remove the cover.

HINT:

Tape the screwdriver tip before use.

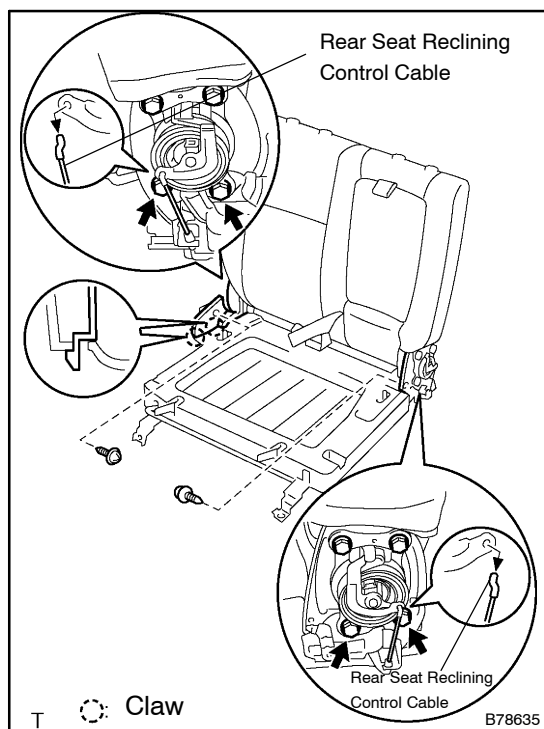
**9. REMOVE REAR NO. 1 SEATBACK ASSY**

- (a) Remove the 2 screws.
- (b) Remove the 4 bolts.
- (c) Disconnect the rear seat reclining control cable.
- (d) Using a screwdriver, disengage the 2 claws and remove the seatback.

HINT:

Tape the screwdriver tip before use.

10. REMOVE RECLINING CONNECTING PIPE

- (a) Remove the 4 bolts and rear No. 1 seat reclining adjuster LH and RH together with the reclining connecting pipe.

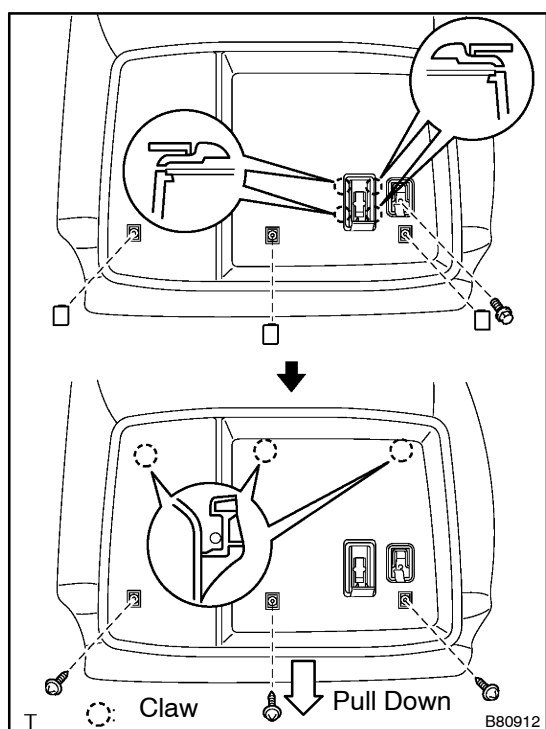
**11. REMOVE REAR SEATBACK BOARD**

- (a) Remove the 3 rear seat caps.
- (b) Remove the bolt and seatback hook.
- (c) Using a screwdriver, disengage the 4 claws and remove the seatback cover.

HINT:

Tape the screwdriver tip before use.

- (d) Remove the 3 screws.

- (e) Using a screwdriver, disengage the 3 claws and remove the seatback board, as shown in the illustration.

HINT:

Tape the screwdriver tip before use.

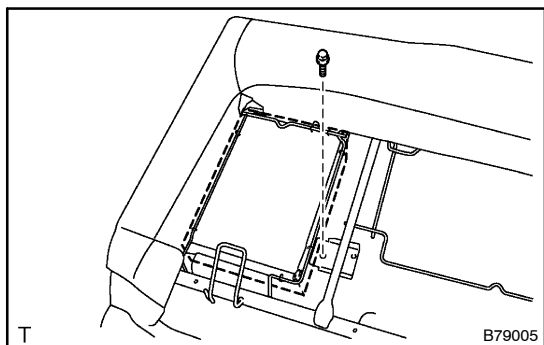
**12. REMOVE REAR SEAT ARMREST ASSY CENTER**

- (a) Remove the bolt and armrest.

13. REMOVE REAR NO. 1 SEATBACK COVER

- (a) Remove the 2 headrest supports.
(b) Remove the hog rings and seatback cover together with the pad from the seatback spring.
(c) Remove the hog rings and seatback cover.

14. REMOVE REAR SEAT BELT ASSY INNER

- (a) Remove the nut and belt.

15. REMOVE REAR SEAT BELT ASSY OUTER CENTER

- (a) Remove the nut and belt.

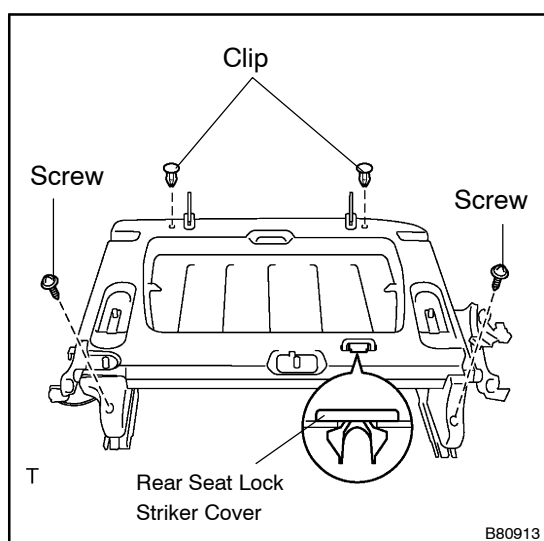
**16. REMOVE REAR UNDER SIDE COVER RH**

- (a) Remove the 2 screws and 2 seat track upper rail covers.
(b) Using a screwdriver, remove the rear seat lock striker cover.

HINT:

Tape the screwdriver tip before use.

- (c) Remove the 2 clips and under side cover.

17. REMOVE SEAT TRACK HANDLE SUB-ASSY RH

- (a) Using a screwdriver, pull up the spring then remove the seat track handle.

HINT:

Tape the screwdriver tip before use.

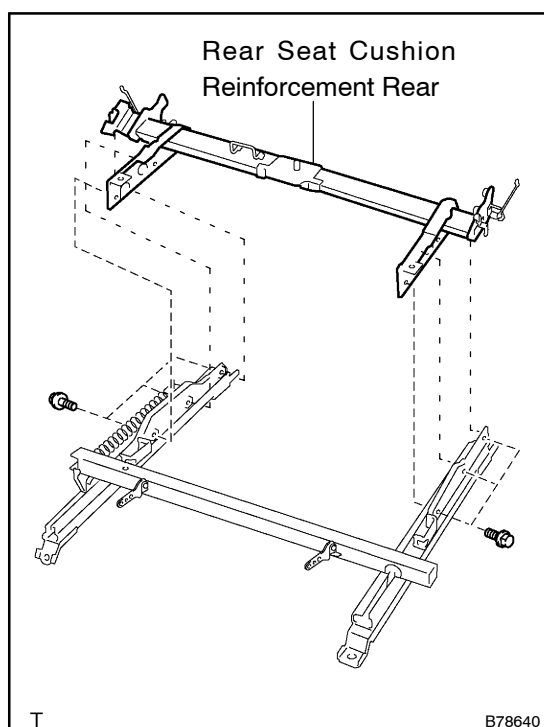
**18. REMOVE REAR SEAT CUSHION REINFORCEMENT REAR**

- (a) Remove the 6 bolts and reinforcement.

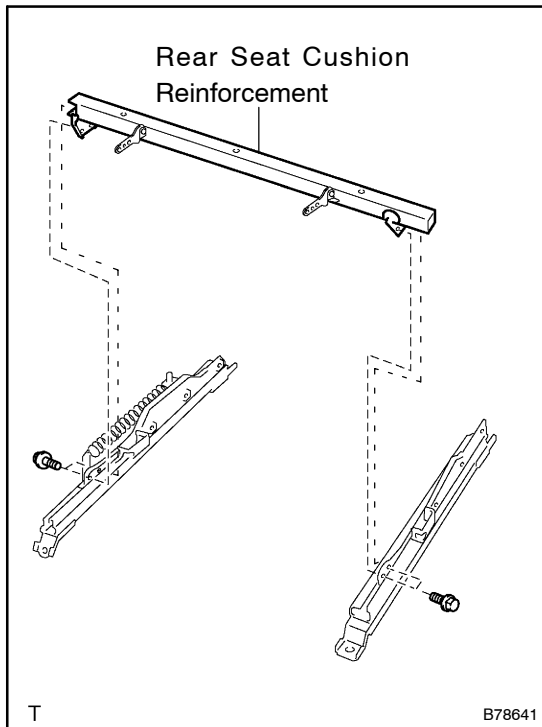
**19. REMOVE REAR SEAT CUSHION REINFORCEMENT**

- (a) Remove the 4 bolts and reinforcement.

20. INSTALL REAR SEAT CUSHION REINFORCEMENT

- (a) Install the reinforcement with the 4 bolts.

Torque: 39 N·m (398 kgf·cm, 29 ft·lbf)

21. INSTALL REAR SEAT CUSHION REINFORCEMENT REAR

- (a) Install the reinforcement with the 6 bolts.

Torque: 39 N·m (398 kgf·cm, 29 ft·lbf)

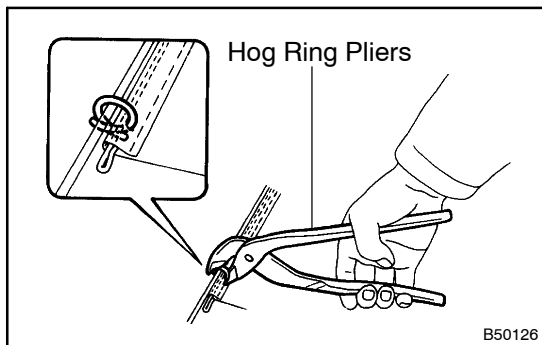
**22. INSTALL REAR NO. 1 SEATBACK COVER**

- (a) Install the seatback pad.
(b) Cover the top of the seatback pad with the cover.
(c) Using hog ring pliers, completely install the seatback cover with new hog rings.

NOTICE:

- **Be careful not to damage the cover.**
- **When installing the hog rings, minimize wrinkles as much as possible.**

23. INSTALL RECLINING CONNECTING PIPE

- (a) Install the connecting pipe with the rear No. 1 seat reclining adjuster LH and RH together with the 4 bolts.

Torque: 39 N·m (398 kgf·cm, 29 ft·lbf)

24. INSTALL REAR SEAT BELT ASSY INNER

Torque: 41.2 N·m (420 kgf·cm, 31 ft·lbf)

25. INSTALL REAR SEAT BELT ASSY OUTER CENTER

Torque: 41.2 N·m (420 kgf·cm, 31 ft·lbf)

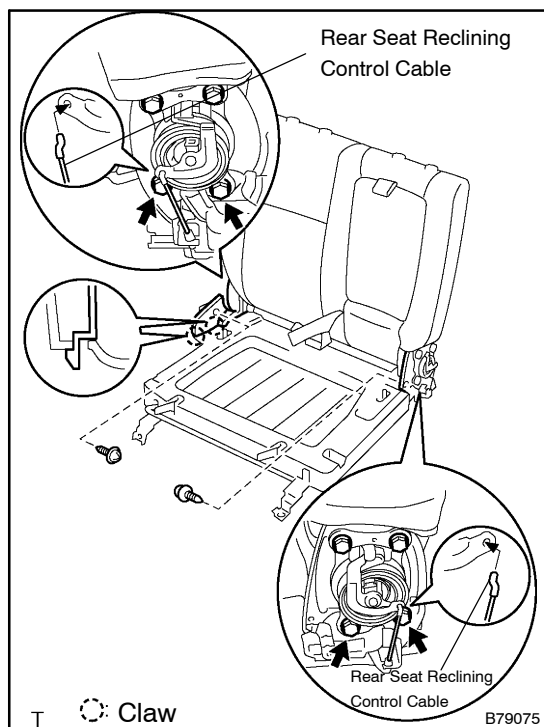
**26. INSTALL REAR NO. 1 SEATBACK ASSY**

- Engage the 2 claws.
- Connect the rear seat reclining control cable.
- Install the 4 bolts.
Torque: 39 N·m (398 kgf·cm, 29 ft·lbf)
- Install the 2 screws.

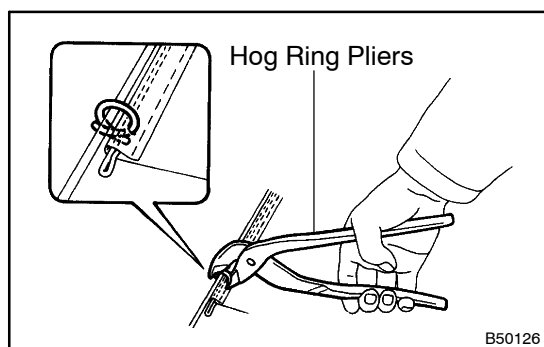
**27. INSTALL REAR NO. 1 SEAT CUSHION COVER**

- Install the seat cushion.
- Using hog ring pliers, install the cushion cover to the cushion pad with new hog rings.

NOTICE:

- Be careful not to damage the cover.
- When installing the hog rings, minimize wrinkles as much as possible.

28. INSTALL REAR NO. 1 SEAT ASSY RH

- Place the seat in the cabin.
- Tighten the 2 bolts on the front side of the seat.
Torque: 39 N·m (398 kgf·cm, 29 ft·lbf)
- Tighten the 2 bolts on the rear side of the seat.
Torque: 39 N·m (398 kgf·cm, 29 ft·lbf)
- Install the 4 seat track covers.
- Install the 2 headrests.