

## OVERHAUL

### CAUTION:

Wear protective gloves. Sharp surfaces on the seatback frame and seat adjuster can cause injuries to your hands.

### HINT:

- The installation procedures are the removal procedures in reverse order. However, only installation procedures requiring additional information are included.
- Use the same procedures for the RH side and LH side.
- The procedures listed below are for the LH side.
- A bolt without a torque specification is shown in the standard bolt chart (see page 03-2).

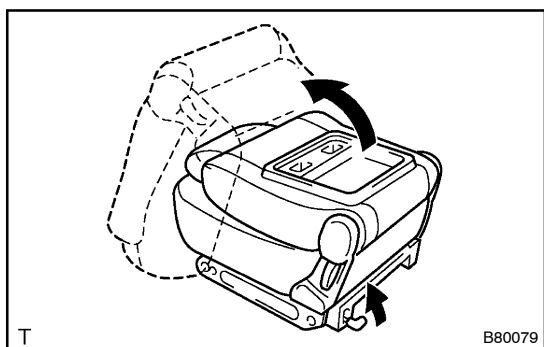

### 1. REMOVE REAR NO.1 SEAT ASSY LH

- (a) Unlock the seat legs by pulling up the lever on the seat legs, and swing the whole seat up and forward.

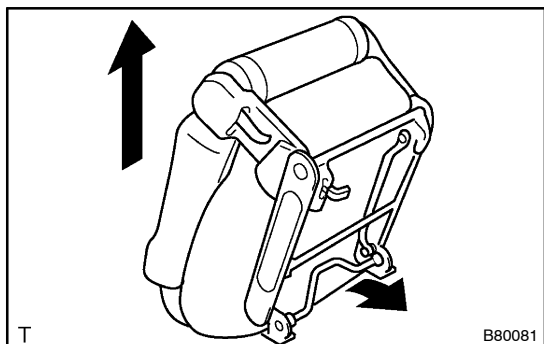

- (b) Pull the lock release lever, lift the seat and remove it.

### 2. REMOVE REAR SEAT HEADREST ASSY

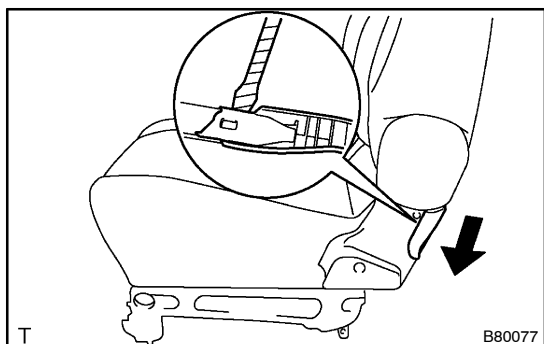

### 3. REMOVE RECLINING ADJUSTER RELEASE HANDLE NO.1 LH

- (a) Using a screwdriver, pry out the reclining adjuster release handle.

### HINT:

Tape the screwdriver tip before use.

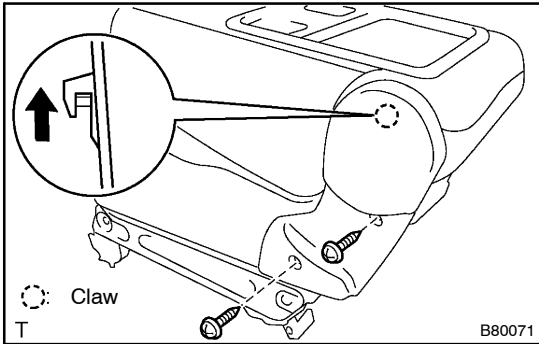

#### 4. REMOVE RECLINING ADJUSTER COVER LH

- Tilt the seatback assy forward.
- Remove the 2 screws.
- Using a screwdriver, disengage the claw and remove the adjuster cover.

HINT:

Tape the screwdriver tip before use.

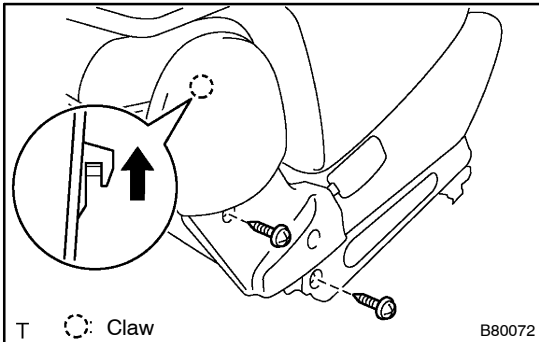

#### 5. REMOVE RECLINING ADJUSTER COVER RH

- Remove the 2 screws.
- Using a screwdriver, disengage the claw and remove the adjuster cover.

HINT:

Tape the screwdriver tip before use.

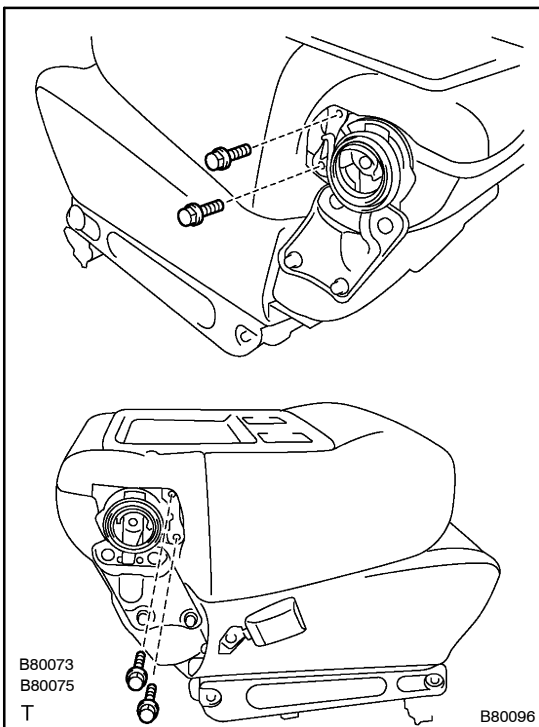

#### 6. REMOVE REAR NO. 1 SEATBACK ASSY

- Remove the 4 bolts.

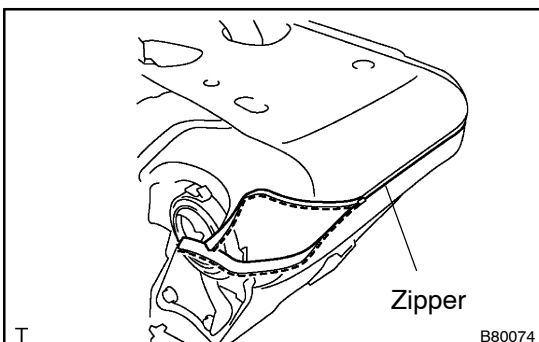

- Unzip the seatback cover and remove the seatback.

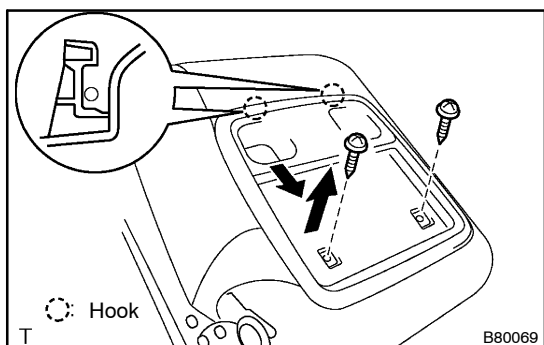
**7. REMOVE REAR SEATBACK BOARD LH**

- (a) Using a screwdriver, disengage the 2 claws and remove the 2 inner garnishes.

**HINT:**

Tape the screwdriver tip before use.

- (b) Remove the 2 screws.  
(c) Disengage the 2 hooks and remove the seatback board in the direction indicated by the arrow in the illustration.

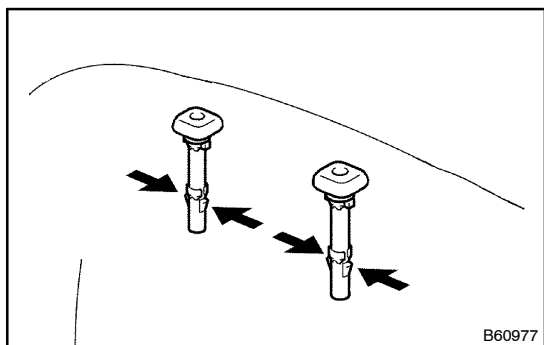
**8. REMOVE REAR NO. 1 SEATBACK COVER**

- (a) Remove the 2 headrest supports.  
(b) Disengage the hook and remove the hog rings and seatback cover together with the pad from the No. 1 seatback spring assy.  
(c) Remove the hog rings and seatback cover.

**9. REMOVE REAR NO.1 SEAT BELT ASSY INNER LH**

- (a) Remove the bolt and belt.

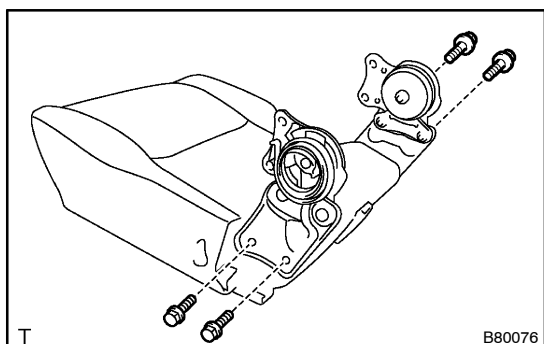
**10. REMOVE REAR SEAT RECLINING ADJUSTER ASSY LH**

- (a) Remove the 2 bolts and adjuster together with the reclining connecting pipe.  
(b) Remove the reclining connecting hook cover.

**11. REMOVE REAR SEAT RECLINING ADJUSTER ASSY RH**

- (a) Remove the 2 bolts and adjuster.

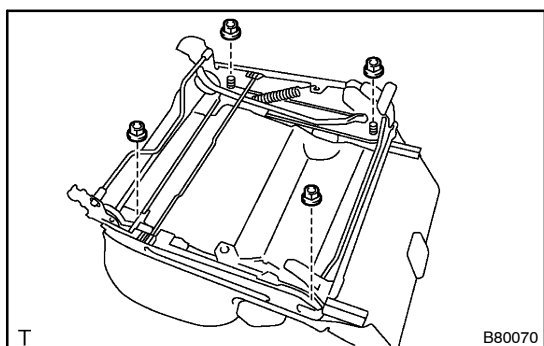
**12. REMOVE NO.1 SEAT LEG ASSY LH**

- (a) Remove the 4 nuts and leg.

**13. REMOVE REAR SEAT LOCK HANDLE KNOB**

- (a) Remove the screw and knob.

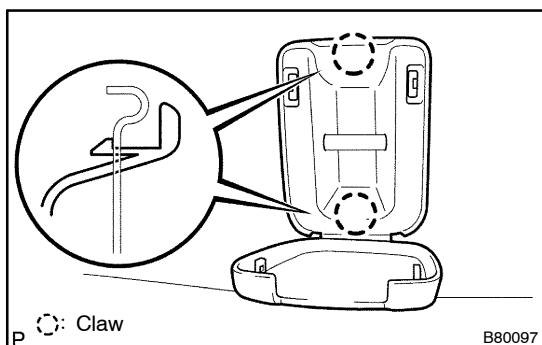
**14. REMOVE REAR SEATBACK COVER LH**

- (a) Using a screwdriver, disengage the 2 claws and cover.

HINT:

Tape the screwdriver tip before use.

**15. REMOVE SEAT TRACK HANDLE SUB-ASSY LH**

- (a) Using a screwdriver, loosen the holding spring and remove the adjusting handle.

HINT:

Tape the screwdriver tip before use.

**16. REMOVE REAR NO. 1 SEAT CUSHION COVER**

- (a) Disengage the hook and remove the hog rings and seat cushion cover together with the pad from the No. 1 seat cushion spring.
- (b) Remove the hog rings and cushion cover.

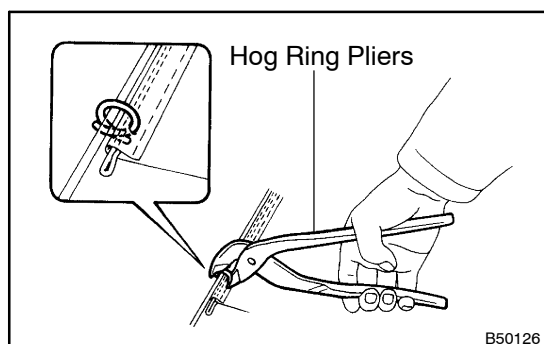
**17. INSTALL REAR NO. 1 SEAT CUSHION COVER**

- (a) Using hog ring pliers, install the cushion cover to the cushion pad with new hog rings.
- (b) Using hog ring pliers, install the cushion cover with the pad to the No. 1 seat cushion spring with new hog rings.

**NOTICE:**

- Be careful not to damage the cover.
- When installing the hog rings, minimize wrinkles as much as possible.

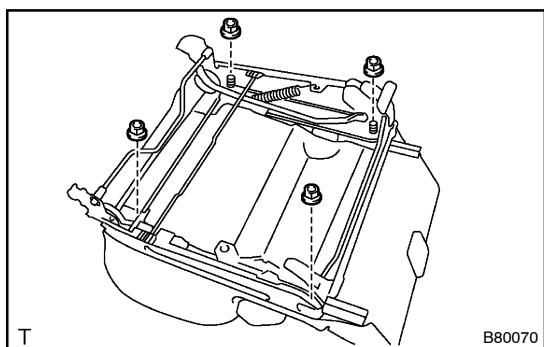
**18. INSTALL NO.1 SEAT LEG ASSY LH**

- (a) Install the leg with the 4 nuts.

**Torque: 41.2 N·m (420 kgf·cm, 30 ft·lbf)**

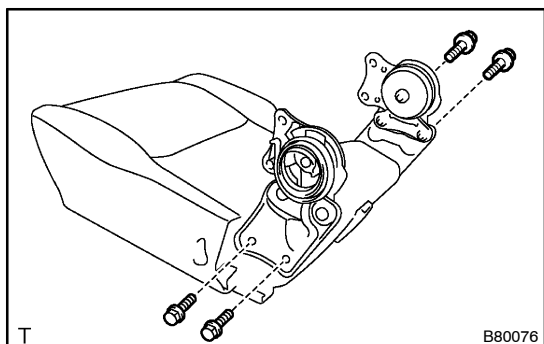
**19. INSTALL REAR SEAT RECLINING ADJUSTER ASSY LH**

- (a) Install the adjuster with the 2 bolts.

**Torque: 39 N·m (398 kgf·cm, 29 ft·lbf)**

**20. INSTALL REAR SEAT RECLINING ADJUSTER ASSY RH**

- (a) Install the reclining connecting pipe.
- (b) Install the reclining connecting hook cover.

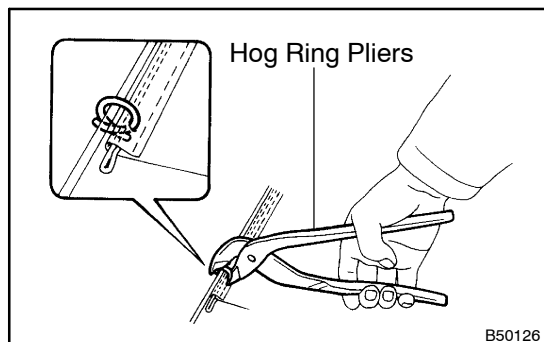

- (c) Install the adjuster with the 2 bolts.

**Torque: 39 N·m (398 kgf·cm, 29 ft·lbf)**

## 21. INSTALL REAR NO.1 SEAT BELT ASSY INNER LH

- (a) Install the belt assy with the bolt.

**Torque: 41.2 N·m (420 kgf·cm, 30 ft·lbf)**

## 22. INSTALL REAR NO. 1 SEATBACK COVER

- (a) Using hog ring pliers, install the seatback cover to the seatback pad with new hog rings.  
 (b) Cover the top of the seatback pad with the seatback cover.  
 (c) Install the 2 headrest supports.  
 (d) Using hog ring pliers, completely install the seatback cover with new hog rings.

### NOTICE:

- **Be careful not to damage the cover.**
- **When installing the hog rings, minimize wrinkles as much as possible.**

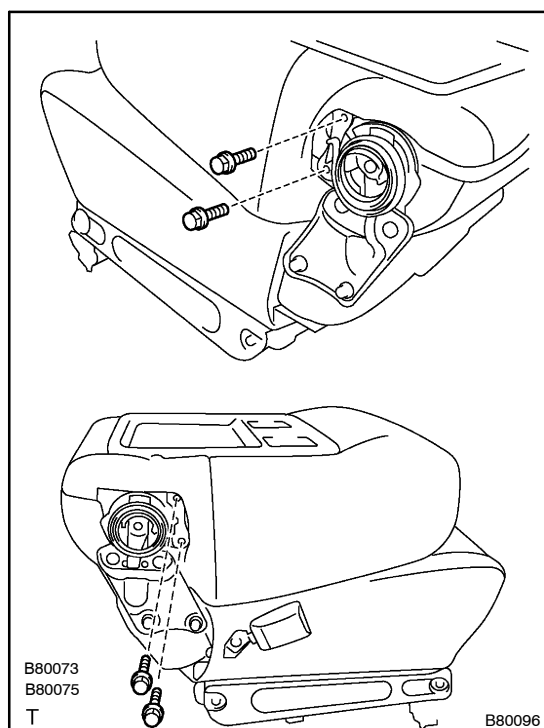

## 23. INSTALL REAR NO. 1 SEATBACK ASSY

- (a) Install the seatback with the 4 bolts.

**Torque: 39 N·m (398 kgf·cm, 29 ft·lbf)**

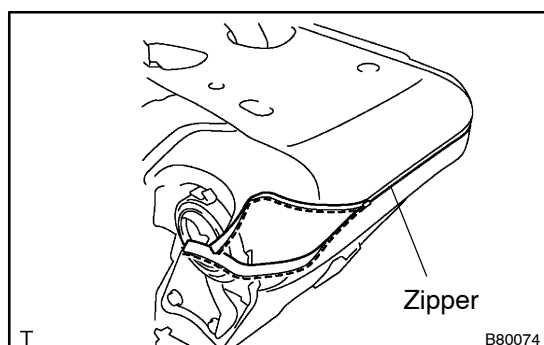

- (b) Insert the seatback into the seat cover, and zip the seatback cover.

**24. INSTALL REAR NO.1 SEAT ASSY LH**

**25. INSPECT RECLINING LOCK POSITION AND SLIDING LOCK POSITION SLIDING OFF**

(a) When reclining the seat, inspect that the outer and inner recliners are released at the same time.

HINT:

When the reclining lock position slips off, disassemble the seat to adjust the position.

(b) When sliding the seat, inspect that the outer and inner tracks are locked at the same time.

HINT:

When sliding lock positions slip off, loosen the bolts to adjust the position.