

# FUEL PRESSURE PULSATION DAMPER ASSY (1AZ-FE/2AZ-FE)

11139-01

## REPLACEMENT

1. DISCHARGE FUEL SYSTEM PRESSURE (See page 1-1)
2. DISCONNECT ENGINE WIRE NO.3 (BATTERY NEGATIVE TERMINAL)
3. REMOVE FRONT WIPER ARM HEAD CAP (3 LINK TYPE FR WIPER)
4. REMOVE FR WIPER ARM LH (3 LINK TYPE FR WIPER) (See Pub. No. RM864E, page 66-9)
5. REMOVE COWL TOP VENTILATOR LOUVER CENTER NO.1 (4 LINK TYPE FR WIPER) (See Pub. No. RM864E, page 66-9)
6. REMOVE FR WIPER ARM LH (4 LINK TYPE FR WIPER) (See Pub. No. RM864E, page 66-9)
7. REMOVE FRONT WIPER ARM HEAD CAP
8. REMOVE FR WIPER ARM RH (See Pub. No. RM864E, page 66-9)
9. REMOVE COWL TOP VENTILATOR LOUVER SUB-ASSY (See Pub. No. RM864E, page 66-9)
10. REMOVE WIPER LINK ASSY (See Pub. No. RM864E, page 66-9)
11. REMOVE COWL TOP PANEL SUB-ASSY OUTER (See page 10-16)
12. REMOVE ENGINE COVER SUB-ASSY NO.1 (See page 10-16)
13. REMOVE AIR CLEANER CAP SUB-ASSY (See page 10-16)

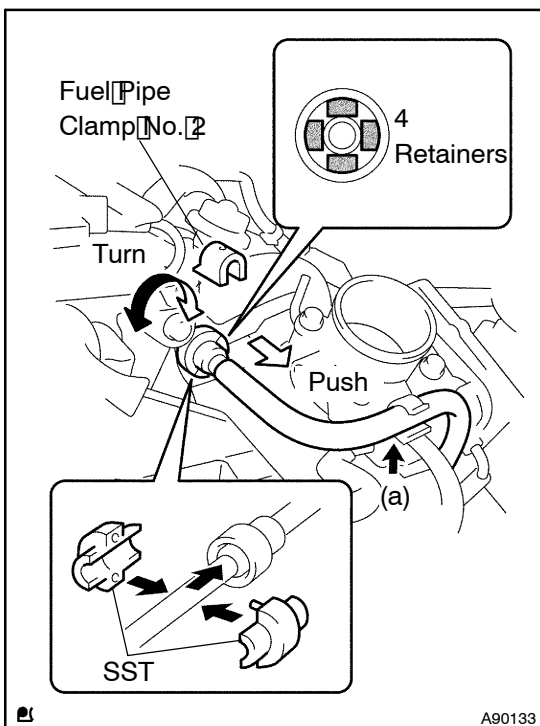

### 14. REMOVE FUEL PRESSURE PULSATION DAMPER ASSY

- (a) Remove the fuel tube from the fuel hose clamp.
- (b) Remove the fuel pipe clamp No. 2.
- (c) Using SST, disconnect the fuel tube from the fuel pressure pulsation damper.  
SST 09268-21010
  - (1) Assemble SST to the connection of the fuel tube as shown in the illustration.
  - (2) Turn SST, then align the 4 retainers inside the connector with the chamfered parts of SST, then insert SST into the connector.
  - (3) Push in SST and the connector together towards the fuel tube.

#### NOTICE:

- Remove dirt or foreign objects on the connector before this work.
- Do not allow any scratches or foreign objects on the parts when disconnecting as the connector has the O-ring that seals pipe
- Perform this work by SST. Do not use any tools.
- Do not forcibly bend, twist or turn the nylon tube.
- Protect the connected part by covering it with a vinyl bag after disconnecting the fuel tube.

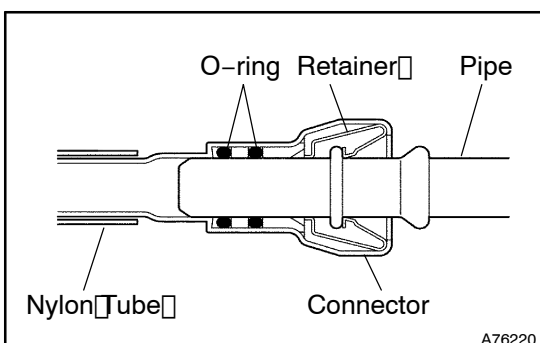

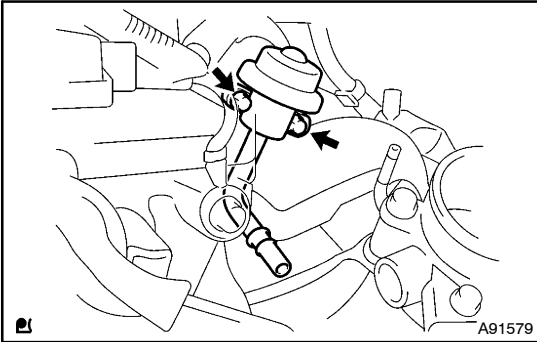

- (d) Remove the 2 bolts, then remove the fuel pulsation damper.

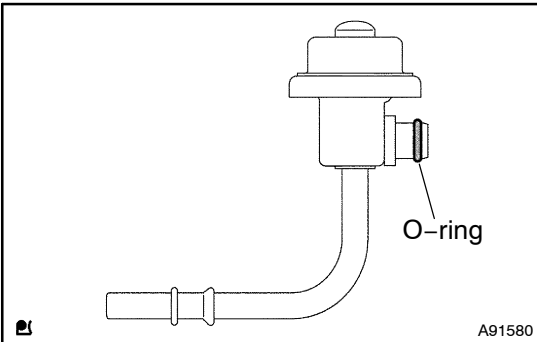

## 15. INSTALL FUEL PRESSURE PULSATION DAMPER ASSY

- (a) Apply a light coat of the gasoline or spindle oil to the O-ring of the fuel pressure pulsation damper.  
(b) Install the fuel pressure pulsation damper with the 2 bolts.  
**Torque: 9.0 N·m (90 kgf·cm, 80 in. lbf)**

### NOTICE:

Be careful that the O-ring is not cracked or jammed when installing.

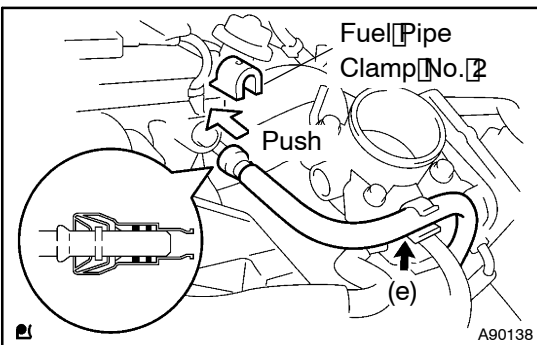

- (c) Connect the fuel tube to the fuel pressure pulsation damper.  
(1) Push in the connector to the pipe until the connector makes a "click" sound.

### NOTICE:

- Check that there are no scratches or foreign objects around the connected part of the connector and pipe before this work.
- After connecting the fuel tube, check that the connector and pipe are securely connected by pulling them.

- (d) Install the fuel pipe clamp No. 2.  
(e) Install the fuel tube to the fuel hose clamp.

## 16. INSTALL AIR CLEANER CAP SUB-ASSY

## 17. INSTALL COWL TOP PANEL SUB-ASSY OUTER (See page 10-16)

## 18. INSTALL WIPER LINK ASSY (See Pub. No. RM864E, page 66-9)

## 19. CONNECT ENGINE WIRE NO. 3 (BATTERY NEGATIVE TERMINAL)

**Torque: 3.9 N·m (40 kgf·cm, 35 in. lbf)**

## 20. CHECK FOR FUEL LEAKS (See page 11-5)

## 21. INSTALL ENGINE COVER SUB-ASSY NO. 1 (See page 10-16)

## 22. INSTALL COWL TOP VENTILATOR LOUVER SUB-ASSY

## 23. INSTALL FR WIPER ARM RH (See Pub. No. RM864E, page 66-9)

## 24. INSTALL FRONT WIPER ARM HEAD CAP

## 25. INSTALL FR WIPER ARM LH (3 LINK TYPE FR WIPER) (See Pub. No. RM864E, page 66-9)

## 26. INSTALL FRONT WIPER ARM HEAD CAP (3 LINK TYPE FR WIPER)

## 27. INSTALL FR WIPER ARM LH (4 LINK TYPE FR WIPER) (See Pub. No. RM864E, page 66-9)

## 28. INSTALL COWL TOP VENTILATOR LOUVER CENTER NO. 1 (4 LINK TYPE FR WIPER)