

REPLACEMENT

1. DRAIN ENGINE COOLANT (See page 6-7)
2. DISCONNECT ENGINE WIRE NO.3 (BATTERY NEGATIVE TERMINAL)
3. REMOVE FRONT WIPER ARM HEAD CAP (3 LINK TYPE FR WIPER)
4. REMOVE FR WIPER ARM LH (3 LINK TYPE FR WIPER) (See Pub. No. RM864E, page 66-9)
5. REMOVE COWL TOP VENTILATOR LOUVER CENTER NO.1 (4 LINK TYPE FR WIPER) (See Pub. No. RM864E, page 66-9)
6. REMOVE FR WIPER ARM LH (4 LINK TYPE FR WIPER) (See Pub. No. RM864E, page 66-9)
7. REMOVE FRONT WIPER ARM HEAD CAP
8. REMOVE FR WIPER ARM RH (See Pub. No. RM864E, page 66-9)
9. REMOVE COWL TOP VENTILATOR LOUVER SUB-ASSY (See Pub. No. RM864E, page 66-9)
10. REMOVE WIPER LINK ASSY (See Pub. No. RM864E, page 66-9)
11. REMOVE COWL TOP PANEL SUB-ASSY OUTER (See page 10-16)
12. REMOVE ENGINE COVER SUB-ASSY NO.1 (See page 10-16)
13. REMOVE AIR CLEANER CAP SUB-ASSY (See page 10-16)
14. REMOVE THROTTLE BODY ASSY (See page 10-16)

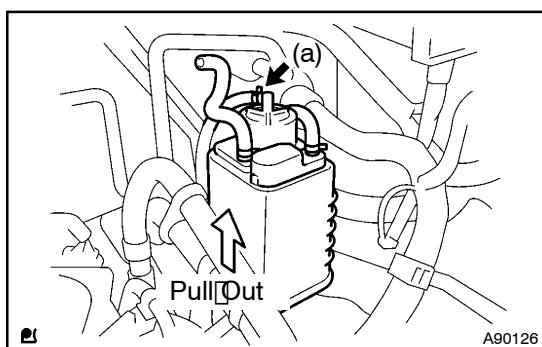

15. REMOVE CHARCOAL CANISTER ASSY

- (a) Disconnect the fuel tank to canister tube fuel hose No. 1 from the charcoal canister.
- (b) Pull out the charcoal canister from the charcoal canister base bracket.

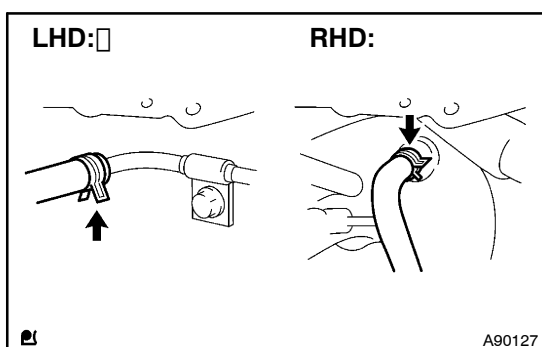

16. REMOVE INTAKE MANIFOLD

- (a) Disconnect the union to check valve hose from the brake booster.

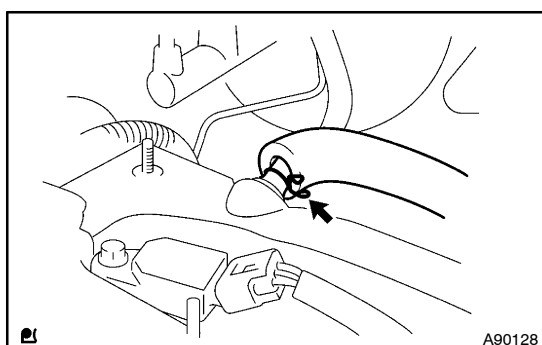

- (b) Disconnect the ventilation hose No. 2 from the ventilation valve.

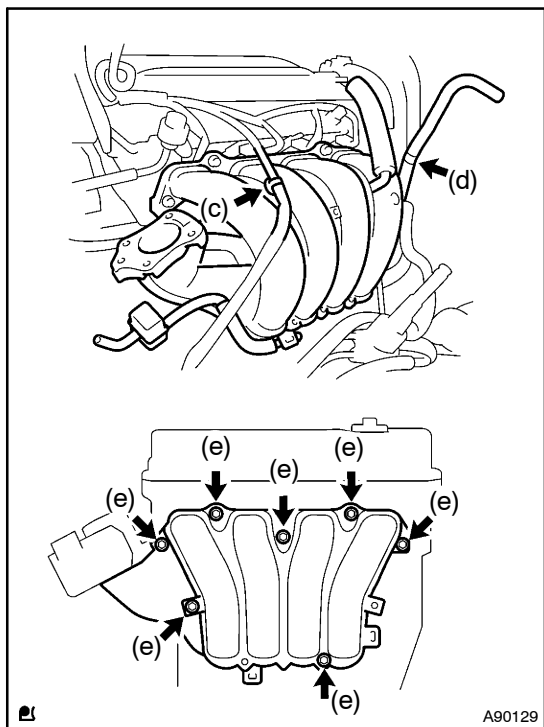

- (c) Remove the wire harness clamp.
- (d) Remove the union to check valve hose from the vacuum hose clamp.
- (e) Remove the 5 bolts and 2 nuts, then remove the intake manifold.

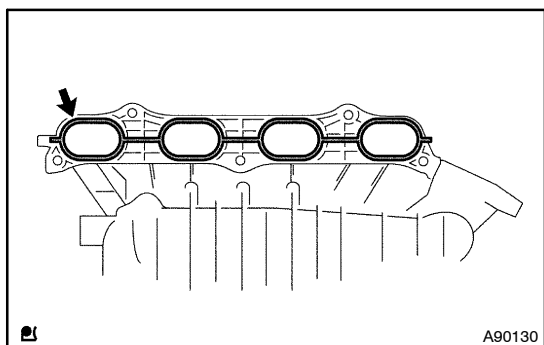

- (f) Remove the gasket from the intake manifold.

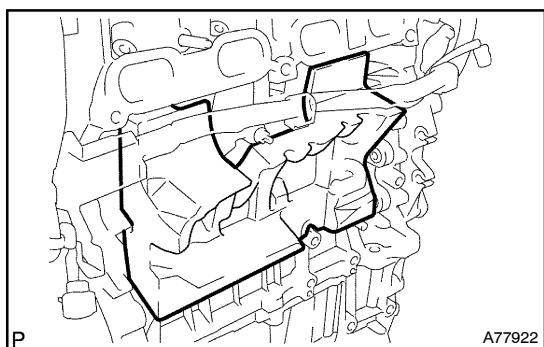

17. REMOVE INTAKE MANIFOLD INSULATOR NO.1

- (a) Remove the intake manifold insulator No. 1 from the cylinder block.

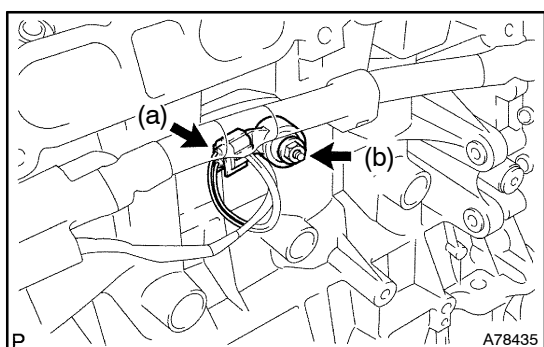

18. REMOVE KNOCK SENSOR

- (a) Disconnect the knock sensor connector.
- (b) Remove the nut, then remove the knock sensor.

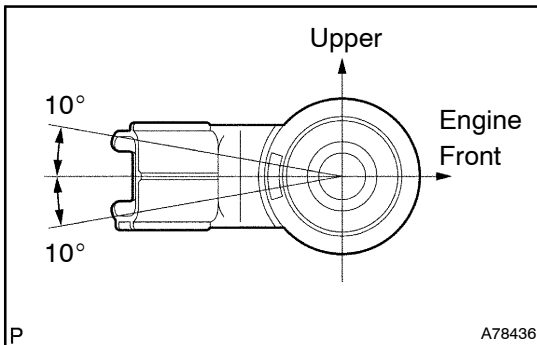
**19. INSTALL KNOCK SENSOR**

(a) Install the knock sensor with the nut.

Torque: 20 N·m (205 kgf·cm, 15 ft·lbf)**NOTICE:****Be careful of the installation direction of the knock sensor.**

(b) Connect the knock sensor connector.

20. INSTALL INTAKE MANIFOLD INSULATOR NO.1**21. INSTALL INTAKE MANIFOLD**

(a) Install a new gasket to the intake manifold.

(b) Install the intake manifold with the 5 bolts and 2 nuts.

Torque: 30 N·m (305 kgf·cm, 22 ft·lbf)

(c) Install the union to check valve hose to the vacuum hose clamp.

(d) Install the wire harness clamp.

(e) Connect the ventilation hose No. 2 to the ventilation valve.

(f) Connect the union to check valve hose to the brake booster.

22. INSTALL CHARCOAL CANISTER ASSY**23. INSTALL THROTTLE BODY ASSY (See page 10-16)****24. INSTALL AIR CLEANER CAP SUB-ASSY****25. INSTALL COWL TOP PANEL SUB-ASSY OUTER (See page 10-16)****26. INSTALL WIPER LINK ASSY (See Pub. No. RM964E, page 66-9)****27. CONNECT ENGINE WIRE NO.3 (BATTERY NEGATIVE TERMINAL)****Torque: 3.9 N·m (40 kgf·cm, 35 in. lbf)****28. ADD ENGINE COOLANT (See page 16-7)****29. CHECK FOR ENGINE COOLANT LEAKS (See page 16-1)****30. INSTALL ENGINE COVER SUB-ASSY NO.1 (See Pub. No. RM864E, page 66-9)****31. INSTALL COWL TOP VENTILATOR LOUVER SUB-ASSY****32. INSTALL FR WIPER ARM RH (See Pub. No. RM864E, page 66-9)****33. INSTALL FRONT WIPER ARM HEAD CAP****34. INSTALL FR WIPER ARM LH (3 LINK TYPE FR WIPER) (See Pub. No. RM864E, page 66-9)****35. INSTALL FRONT WIPER ARM HEAD CAP (3 LINK TYPE FR WIPER)****36. INSTALL FR WIPER ARM LH (4 LINK TYPE FR WIPER) (See Pub. No. RM864E, page 66-9)****37. INSTALL COWL TOP VENTILATOR LOUVER CENTER NO.1 (4 LINK TYPE FR WIPER)**