

ROAD TEST

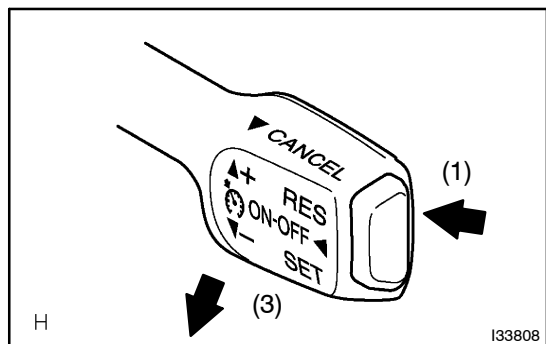

1. PROBLEM SYMPTOM CONFIRMATION

- (a) Inspect the SET function.
- (1) Push the ON-OFF button on.
 - (2) Drive at the required speed (40 km/h (25 mph) or higher).
 - (3) Push the cruise control main switch to SET/-.
 - (4) After releasing the switch, check that the vehicle cruises at the set speed.

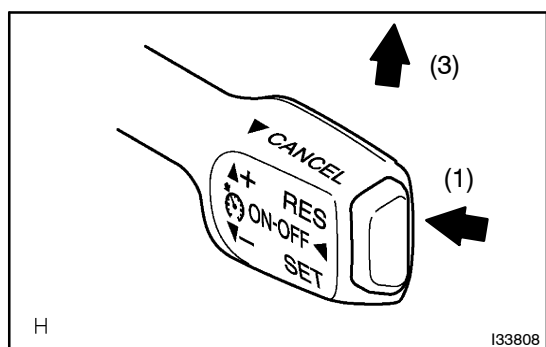

- (b) Inspect the ACC (+) switch.
- (1) Push the ON-OFF button on.
 - (2) Drive at the required speed (40 km/h (25 mph) or higher).
 - (3) Push the cruise control main switch to SET/-.
 - (4) Check that vehicle speed increases while the cruise control main switch is pushed to RES/+, and that the vehicle cruises at the newly set speed when the switch is released.
 - (5) Momentarily push the cruise control main switch to RES/+ and then immediately release it. Check that vehicle speed increases by approximately 1.6 km/h (1.0 mph) (Tap-up function).

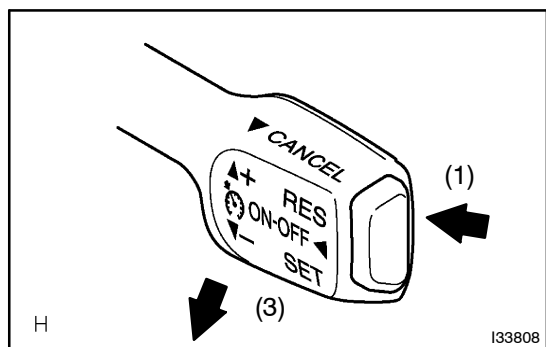

- (c) Inspect the COAST (-) function.
- (1) Push the ON-OFF button on.
 - (2) Drive at the required speed (40 km/h (25 mph) or higher).
 - (3) Push the cruise control main switch to SET/-.
 - (4) Check that vehicle speed decreases while the cruise control main switch is pushed to SET/-, and that the vehicle cruises at the newly set speed when the switch is released.
 - (5) Momentarily push the cruise control main switch to SET/-, and then immediately release it. Check that vehicle speed decreases by approximately 1.6 km/h (1.0 mph) (Tap-down function).

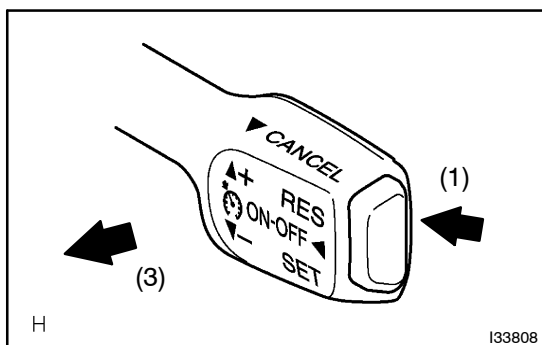

- (d) Inspect the CANCEL function.
- (1) Push the ON-OFF button on.
 - (2) Drive at the required speed (40 km/h (25 mph) or higher).
 - (3) Push the cruise control main switch to SET/-.
 - (4) When doing one of the following, check that the cruise control system is cancelled and that the normal driving mode is reset.
 - Depressing the brake pedal
 - Moving the shift lever to any position except D
 - Pushing the ON-OFF button off
 - Pulling the cruise control main switch to CANCEL

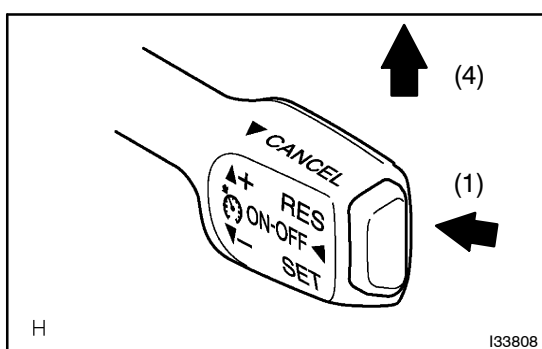

- (e) Inspect the RES (RESUME) function.
- (1) Push the ON-OFF button on.
 - (2) Drive at the required speed (40 km/h (25 mph) or higher).
 - (3) Push the cruise control main switch to SET/-.
 - (4) When doing one of the following, check that the cruise control system is cancelled and that the normal driving mode is reset.
 - Depressing the brake pedal
 - Moving the shift lever to any position except D
 - Pulling the cruise control main switch to CANCEL
 - (5) After pushing the cruise control main switch to RES/+ at a driving speed of more than 40 km/h (25 mph), check that the vehicle restores the speed prior to the cancellation.