

MALFUNCTION IN FUEL RECEIVER GAUGE

WIRING DIAGRAM

LHD Models:

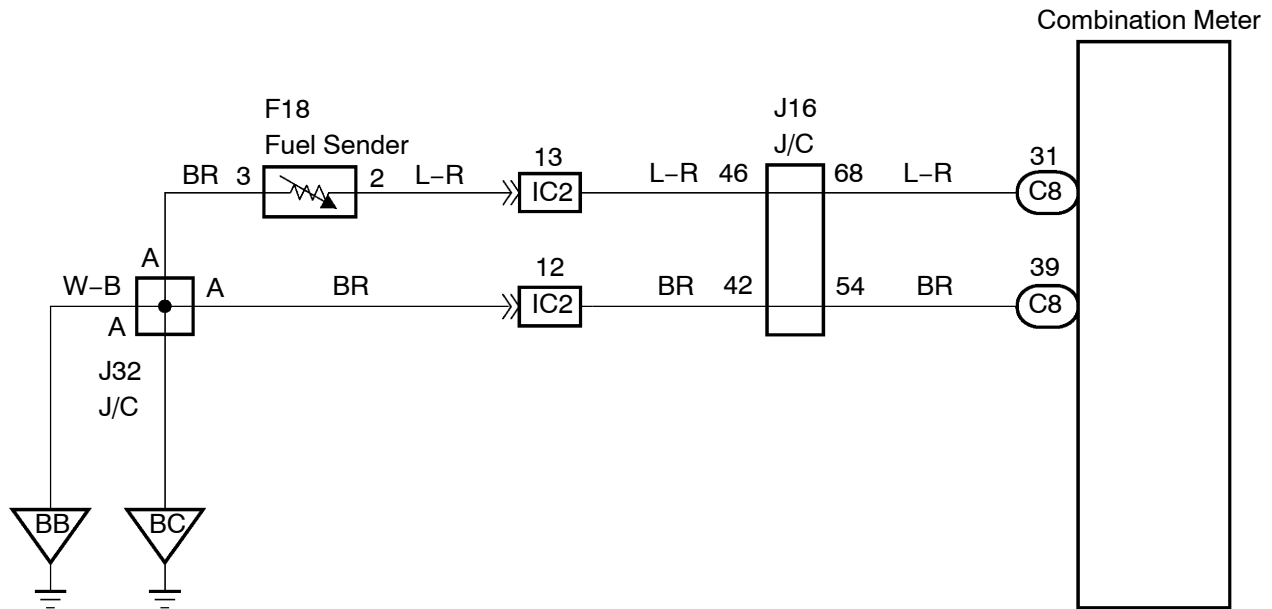

C

I40716

RHD Models:

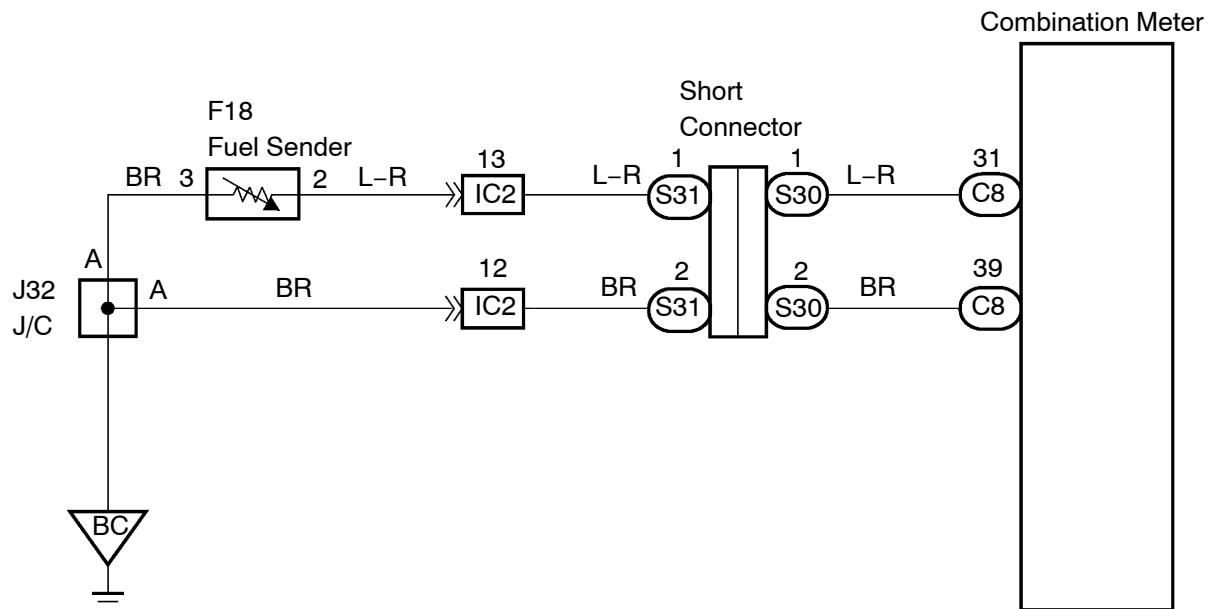

C

I41366

INSPECTION PROCEDURE

1 INSPECT HARNESS OR CONNECTOR

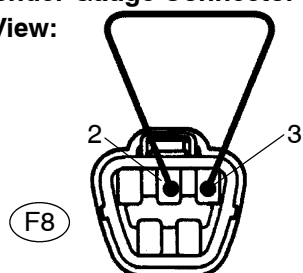
Fuel Sender Gauge Connector
Front View:

I37971

- (a) Disconnect the connector from the fuel sender gauge assy.
- (b) Check the meter indicator conditions according to the table below.

Standard:

Wire Connection	Condition	Specified Condition
2 to 3	Short circuit (Ignition switch ON)	Fuel gauge indicates "F" or more (Combination meter)

- (c) Measure the voltage according to the value(s) in the table below.

Standard:

Tester Connection	Condition	Specified Condition
2 – Body ground	Ignition switch ON	4 to 7 V

NG

Go to step 3

OK

2 INSPECT FUEL SENDER GAUGE ASSY

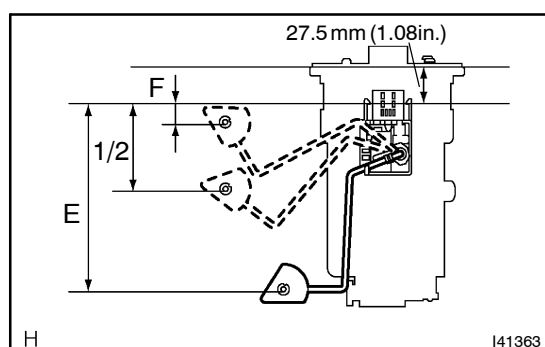

I41363

- (a) Remove the fuel sender gauge assy.

Connector Front View:



1e-5-1-A

I30899

- (b) Check that the float position is between E and F.
- (c) Measure the resistance between terminals 2 and 3 of the connector according to the value(s) in the table below.

Standard:

Float level	Float position mm (in.)	Resistance (Ω)
F	13.2 (0.52) \pm 3 (0.12)	3.9 to 4.1
1/2	64.6 (2.54) \pm 3 (0.12)	52 to 58
E	137.6 (5.42) \pm 3 (0.12)	106 to 108

NG

REPLACE FUEL SENDER GAUGE ASSY

OK

REPLACE COMBINATION METER ASSY

3

CHECK HARNESS AND CONNECTOR(BETWEEN FUEL SENDER GAUGE ASSY AND COMBINATION METER ASSY)

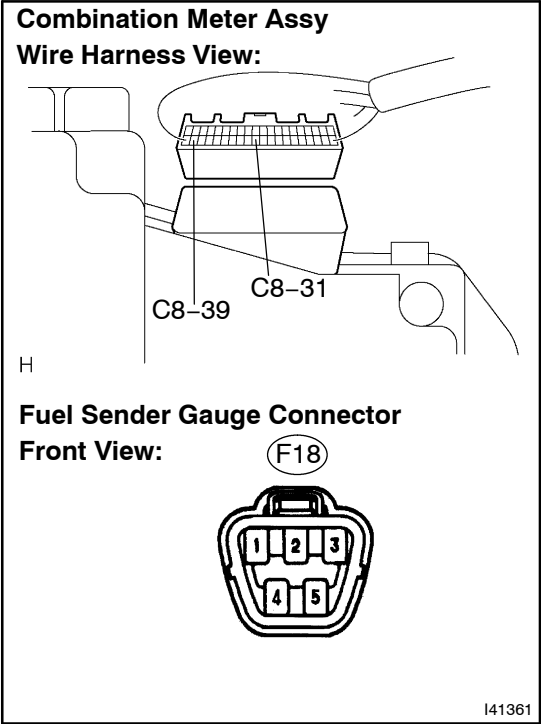

- (a) Disconnect the C8 and F18 connectors.
- (b) Measure the resistance according to the value(s) in the table below.

Standard:

Tester Connection	Specified Condition
C8-31 - F18-2	Below 1 Ω
C8-39 - F18-3	Below 1 Ω
F13-3 - Body ground	Below 1 Ω
C8-31 - Body ground	10 kΩ or higher

NG

REPAIR OR REPLACE HARNESS OR CONNECTOR

OK

REPLACE COMBINATION METER ASSY