

■ DOOR LOCK CONTROL SYSTEM

1. General

- This system is controlled by the body ECU. The body ECU outputs signals to the respective door lock motors.
- For improved theft deterrence performance, a double locking system is standard equipment on the RHD models for Europe. Double locking system is controlled by the double lock ECU. This ECU communication with the body ECU.

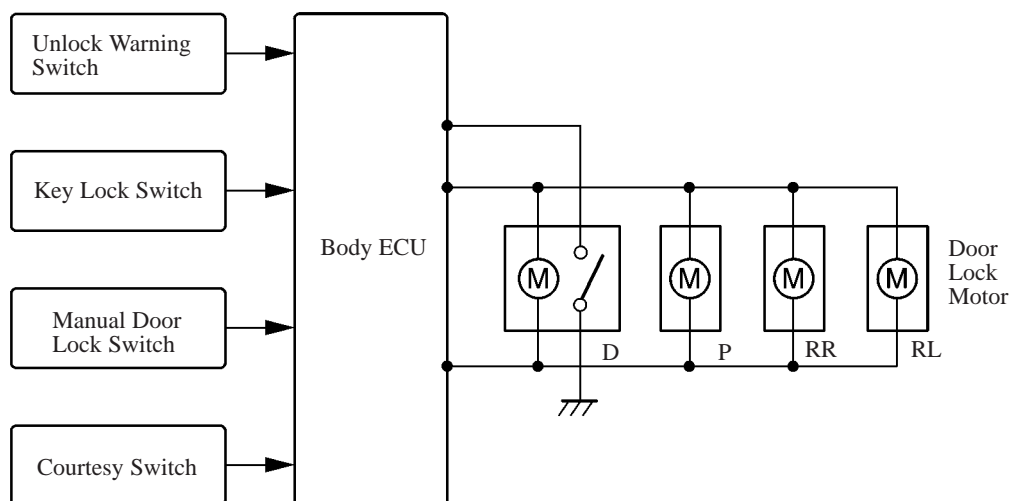

206BE22

without Double Locking

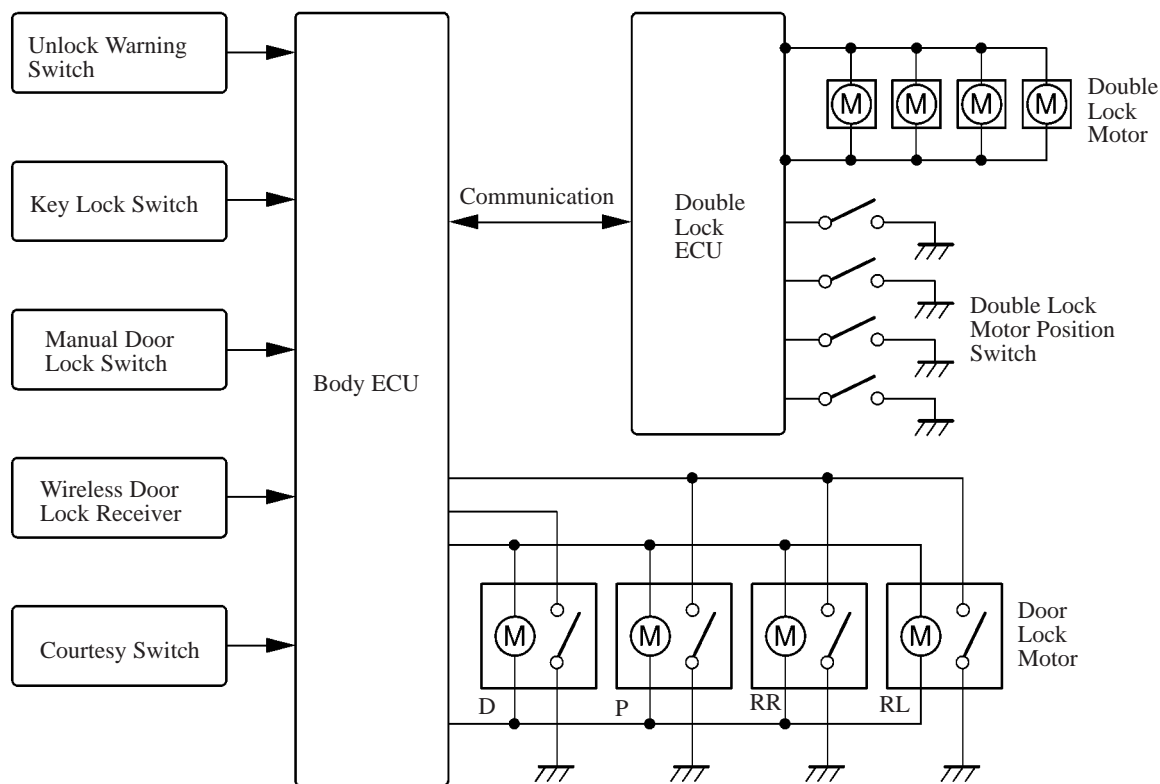

206BE23

**with Double Locking
(RHD Models for Europe)**

2. Layout of Component

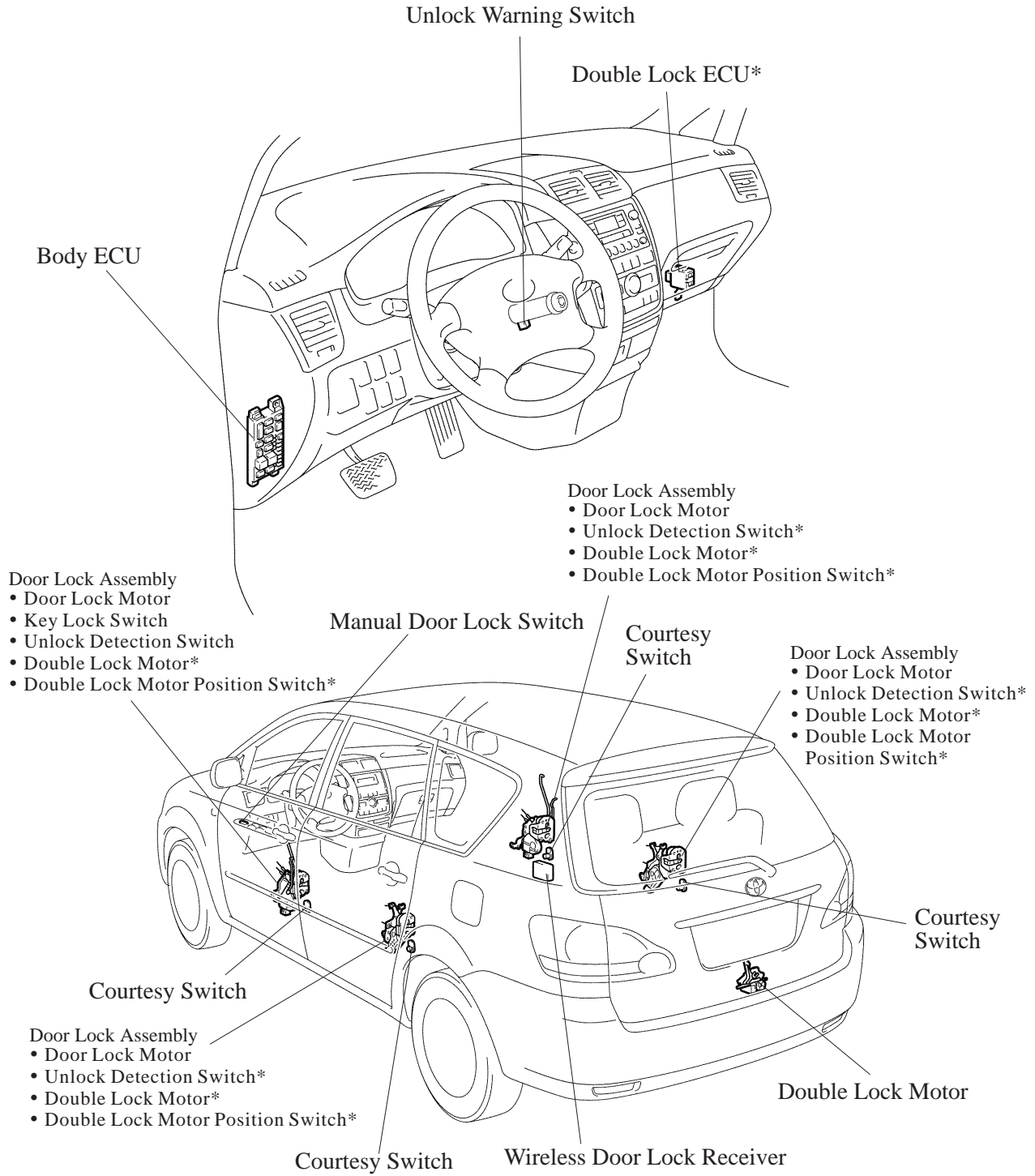

*: with Double Locking System (on the RHD Models for Europe)

3. Function

The door lock control system has the following functions.

Function	Outline
Key-linked lock and unlock function*	This function, which is linked with the driver door key cylinder, can lock or unlock all the doors when a lock or unlock operation is effected.
Key confine prevention function	Provided that the key is inserted in the ignition key cylinder and the driver's door is open, an attempt to lock the door will cause all the doors to unlock.
Manual unlock prohibition function	When a lock operation is effected through wireless door lock remote control, this function prohibits the driver's door lock switches from becoming unlocked.
One-motion	The function which enables the driver to unlock the driver's door by pulling the driver's door inside knob.
Double lock function	<ul style="list-style-type: none"> • The double locking system also prevents the doors from being opened through the operation of the inside door knobs. Thus, the doors cannot be opened either from the inside or the outside of the vehicle. • To lock the doors with this system, pressing the transmitter's LOCK switch, then pressing it again within 5 seconds activates the double locking system. • However, as an emergency unlocking maneuver, only the driver's door can be unlocked with a key.

*: This function is not available for the model with double locking system.

CAUTION

Never activate the double locking system when there are people in the vehicle because the doors cannot be opened from the inside of the vehicle.

If locking the doors by accident, press "Unlock" button of the transmitter.