

REAR FLOOR REAR SIDE MEMBER (ASSY) REPLACEMENT

1. REMOVE QUARTER PANEL ([See page BP-47](#))
2. REMOVE BACK DOOR OPENING TROUGH ([See page BP-69](#))
3. REMOVE BODY LOWER BACK PANEL ([See page BP-56](#))
4. REMOVE BACK DOOR OPENING LOWER REINFORCEMENT ([See page BP-72](#))
5. REMOVE REAR FLOOR PAN ([See page BP-58](#))
6. REMOVE JACK UP BRACKET
7. REMOVE REAR FLOOR NO.4 CROSSMEMBER ([See page BP-64](#))
8. REMOVE REAR FLOOR REAR SIDE MEMBER
 - (a) Remove the rear floor side member reinforcement at the same time.
 - (b) Make an incision in the center floor pan and bend it upward as shown. Drill out the spot welds and separate the floor side inner member.

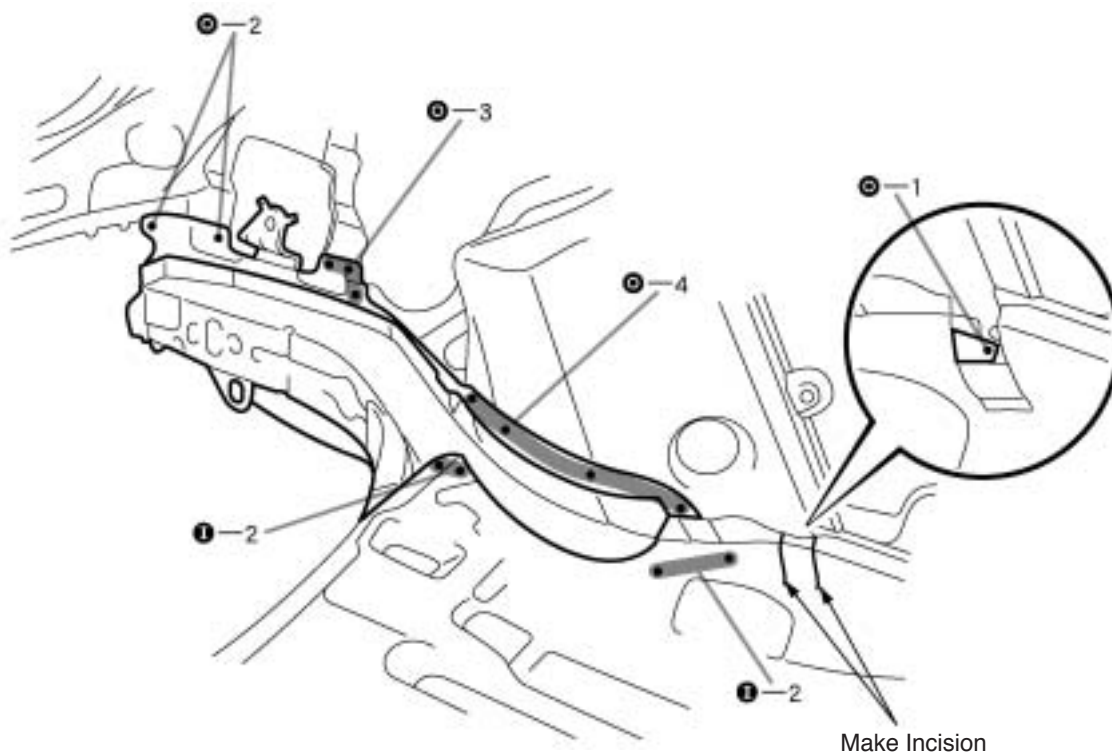

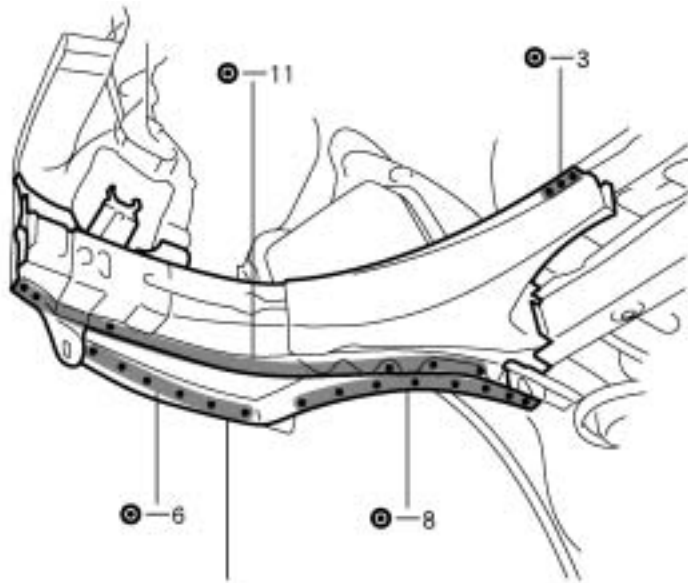

Rear Floor Side
Member Reinforcement

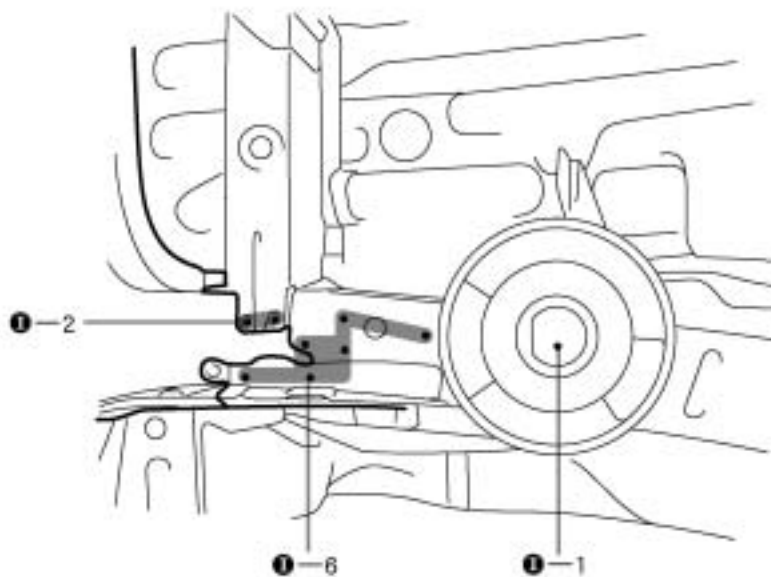
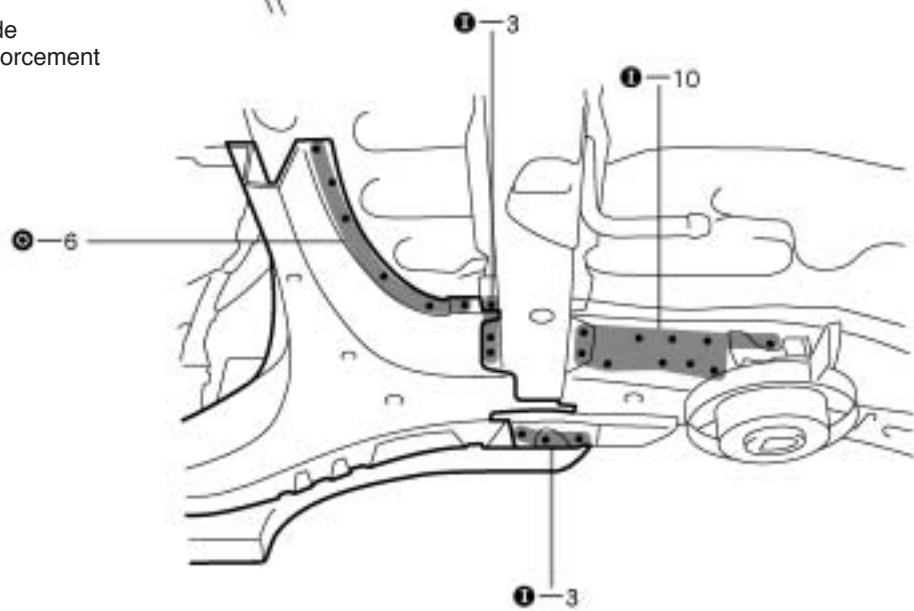

9. INSTALL REAR FLOOR REAR SIDE MEMBER

- (a) Temporarily install the new parts and measure each part in accordance with the body dimension diagram.

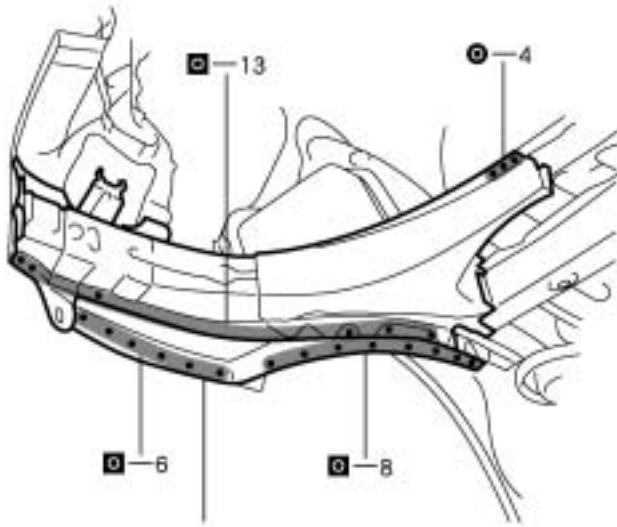

Rear Floor Side Member Reinforcement

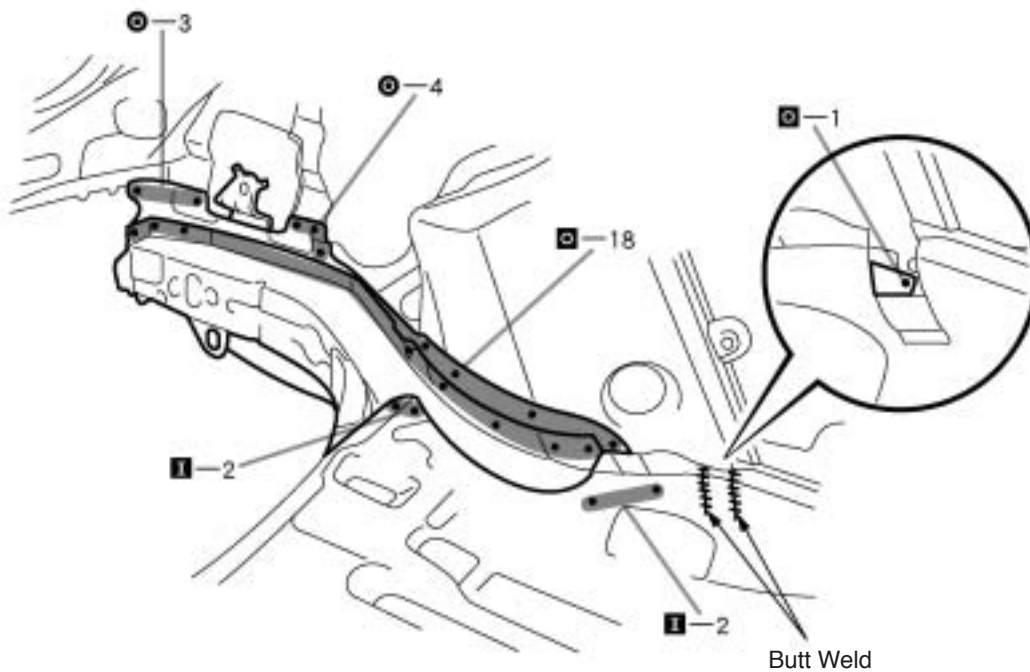

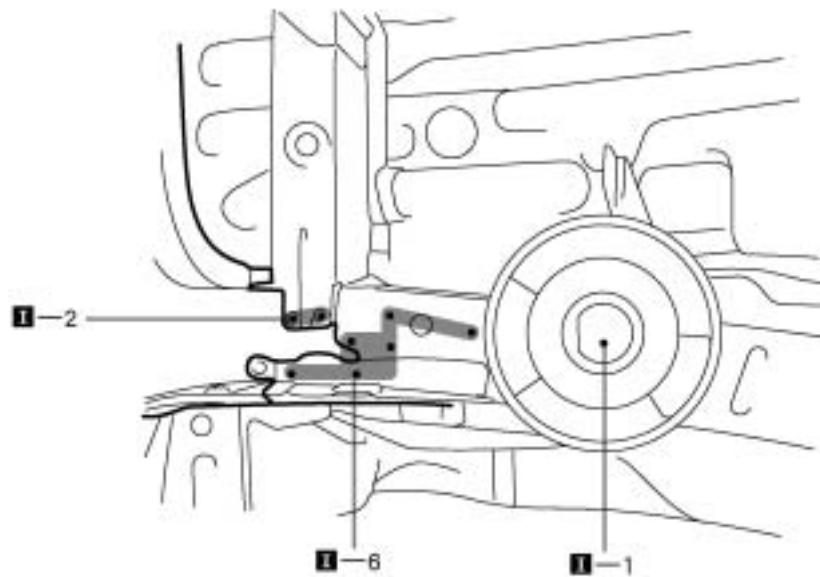
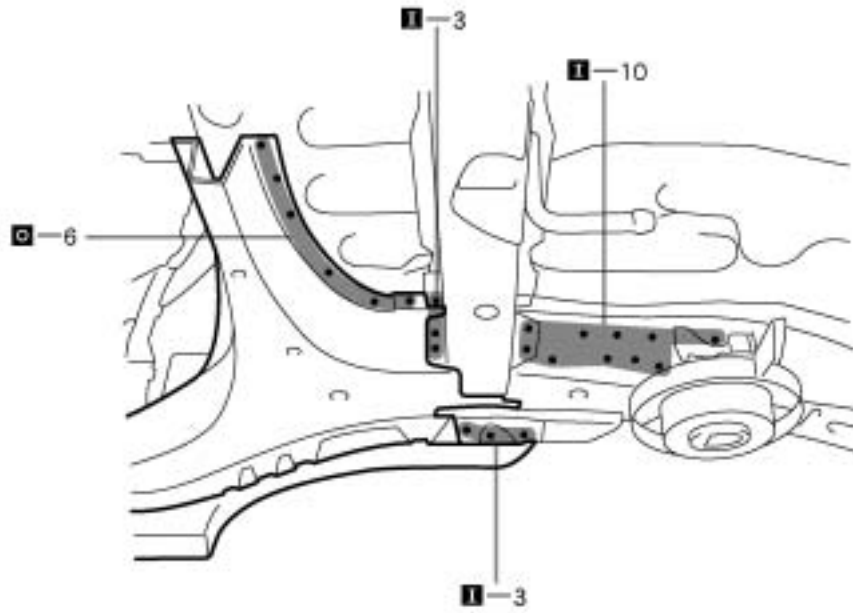

10. MEASURING THE UNDER BODY DIMENSIONS ([See page BP-94](#))
11. INSTALL REAR FLOOR NO.4 CROSSMEMBER ([See page BP-64](#))
12. INSTALL JACK UP BRACKET ([See page BP-61](#))
13. INSTALL REAR FLOOR PAN ([See page BP-58](#))
14. INSTALL BODY LOWER BACK PANEL ([See page BP-56](#))
15. INSTALL BACK DOOR OPENING LOWER REINFORCEMENT ([See page BP-72](#))
16. INSTALL BACK DOOR OPENING TROUGH ([See page BP-69](#))
17. INSTALL QUARTER PANEL ([See page BP-47](#))
18. APPLYING SEALER TO THE INSIDE OF THE VEHICLE ([See page PC-1](#))
19. APPLYING SEALER TO THE REAR LUGGAGE COMPARTMENT ([See page PC-1](#))
20. APPLYING UNDER COATING ([See page PC-6](#))
21. REPLACEMENT SILENCER SHEET ([See page PC-9](#))
22. APPLYING ANTI-RUST AGENT
 - (a) After applying the top coat layer, apply the anti-rust agent to the inside of the necked section structural weld spots.