

ROOF SIDE INNER REAR PANEL (ASSY) REPLACEMENT

1. REMOVE QUARTER PANEL ([See page BP-47](#))
2. REMOVE BODY LOWER BACK PANEL ([See page BP-56](#))
3. REMOVE BACK DOOR OPENING TROUGH ([See page BP-69](#))
4. REMOVE BACK DOOR OPENING LOWER REINFORCEMENT ([See page BP-72](#))
5. REMOVE ROOF SIDE INNER LOWER PANEL ([See page BP-74](#))
6. REMOVE BACK DOOR OPENING SIDE REINFORCEMENT ([See page BP-76](#))
7. REMOVE ROOF SIDE INNER REAR PANEL

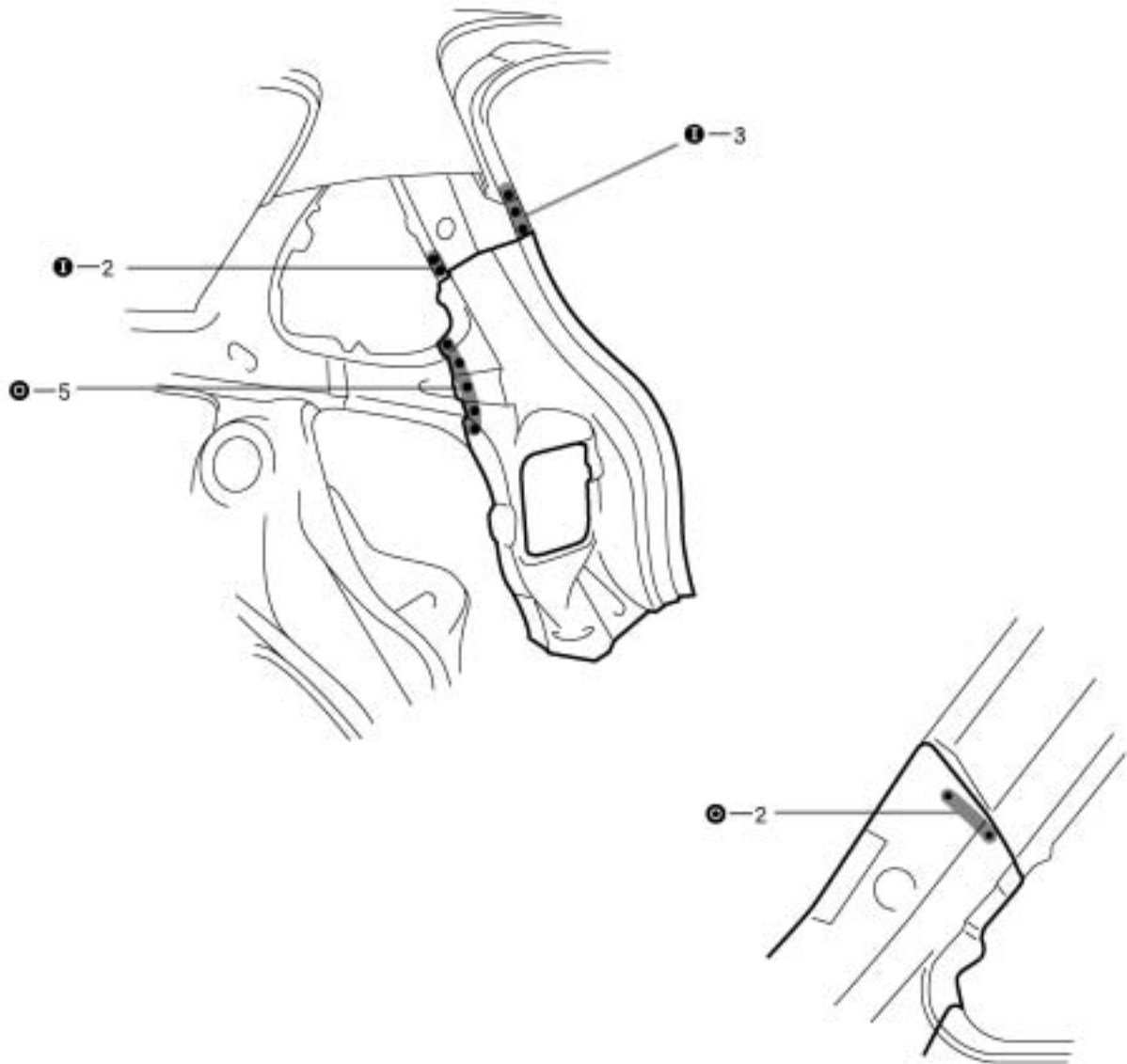

8. INSTALL ROOF SIDE INNER REAR PANEL

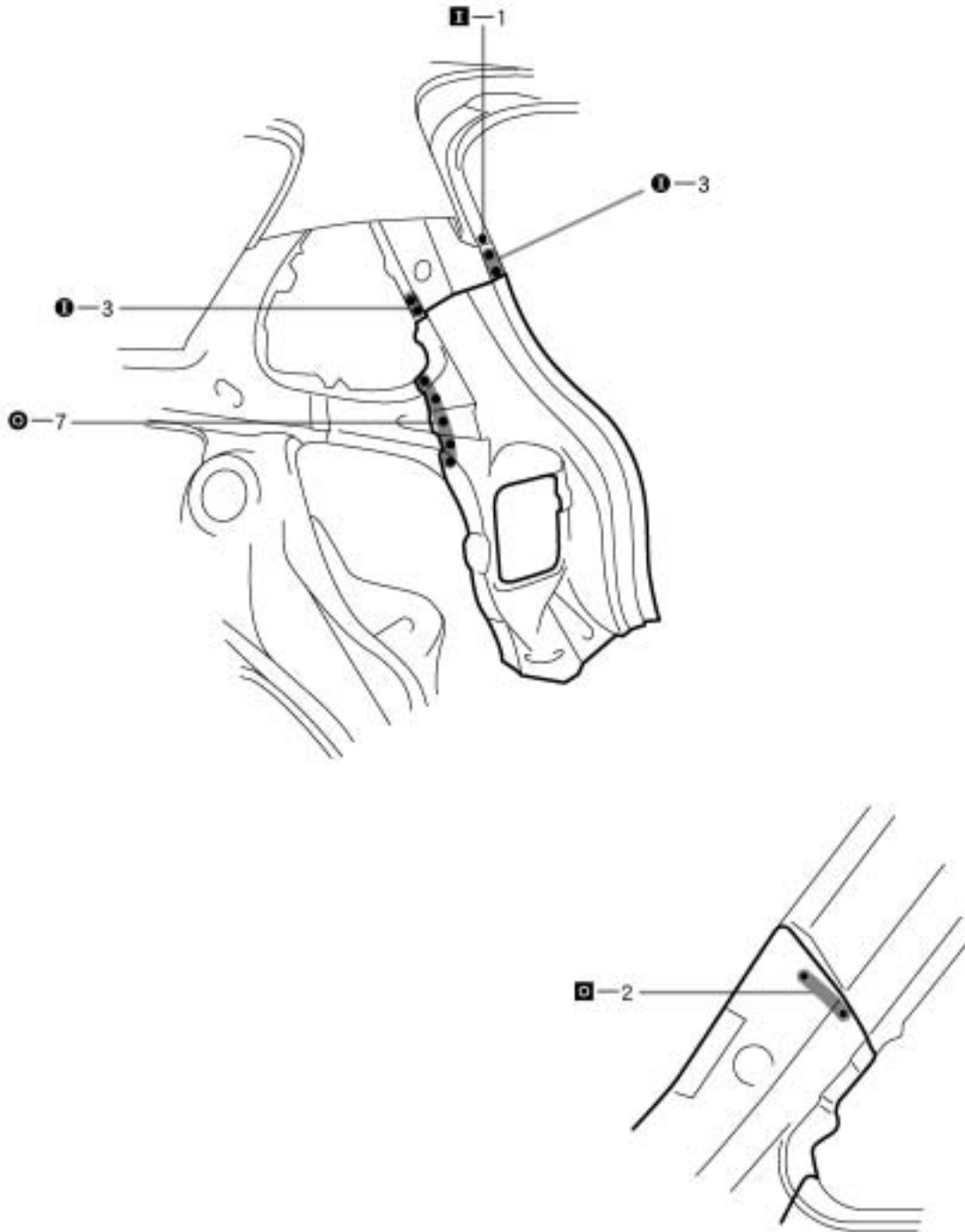

-
9. INSTALL BACK DOOR OPENING SIDE REINFORCEMENT ([See page BP-76](#))
 10. INSTALL ROOF SIDE INNER LOWER PANEL ([See page BP-74](#))
 11. INSTALL BACK DOOR OPENING LOWER REINFORCEMENT ([See page BP-72](#))
 12. INSTALL BACK DOOR OPENING TROUGH ([See page PB-69](#))
 13. INSTALL BODY LOWER BACK PANEL ([See page BP-56](#))
 14. INSTALL QUARTER PANEL ([See page BP-47](#))
 15. APPLYING SEALER TO THE INSIDE OF THE VEHICLE ([See page PC-1](#))
 16. APPLYING SEALER TO THE REAR LUGGAGE COMPARTMENT ([See page PC-1](#))
 17. APPLYING ANTI-RUST AGENT
 - (a) After applying the top coat layer, apply the anti-rust agent to the inside of the necked section structural weld spots.