

BACK DOOR OPENING TROUGH (ASSY) REPLACEMENT

1. REMOVE QUARTER PANEL ([See page BP-47](#))
2. REMOVE BACK DOOR OPENING TROUGH
 - (a) Remove the quarter panel outer extension at the same time.

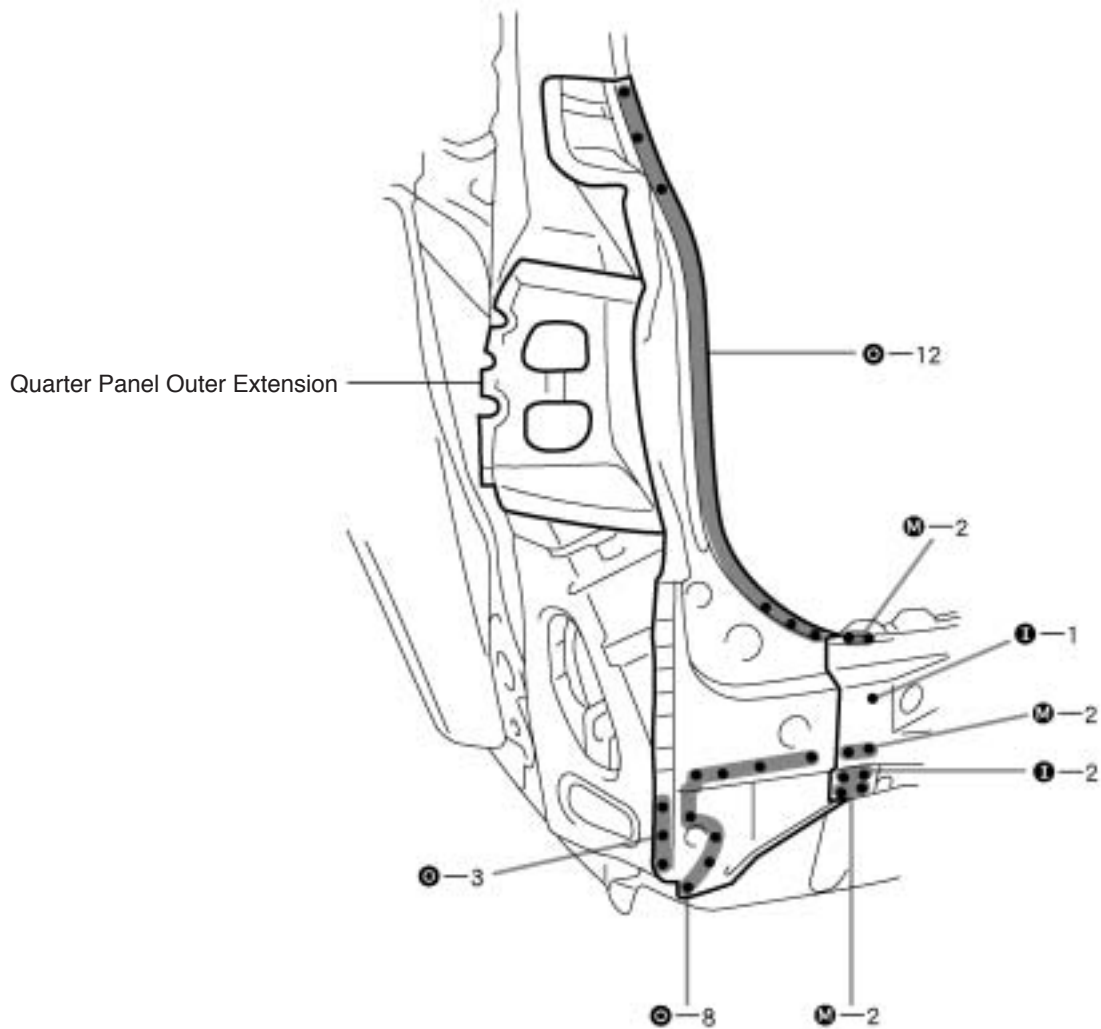

3. INSTALL BACK DOOR OPENING TROUGH

HINT:

Inspect the fitting of the quarter panel back door and rear combination light, etc., before welding, since this affects the appearance of the finish.

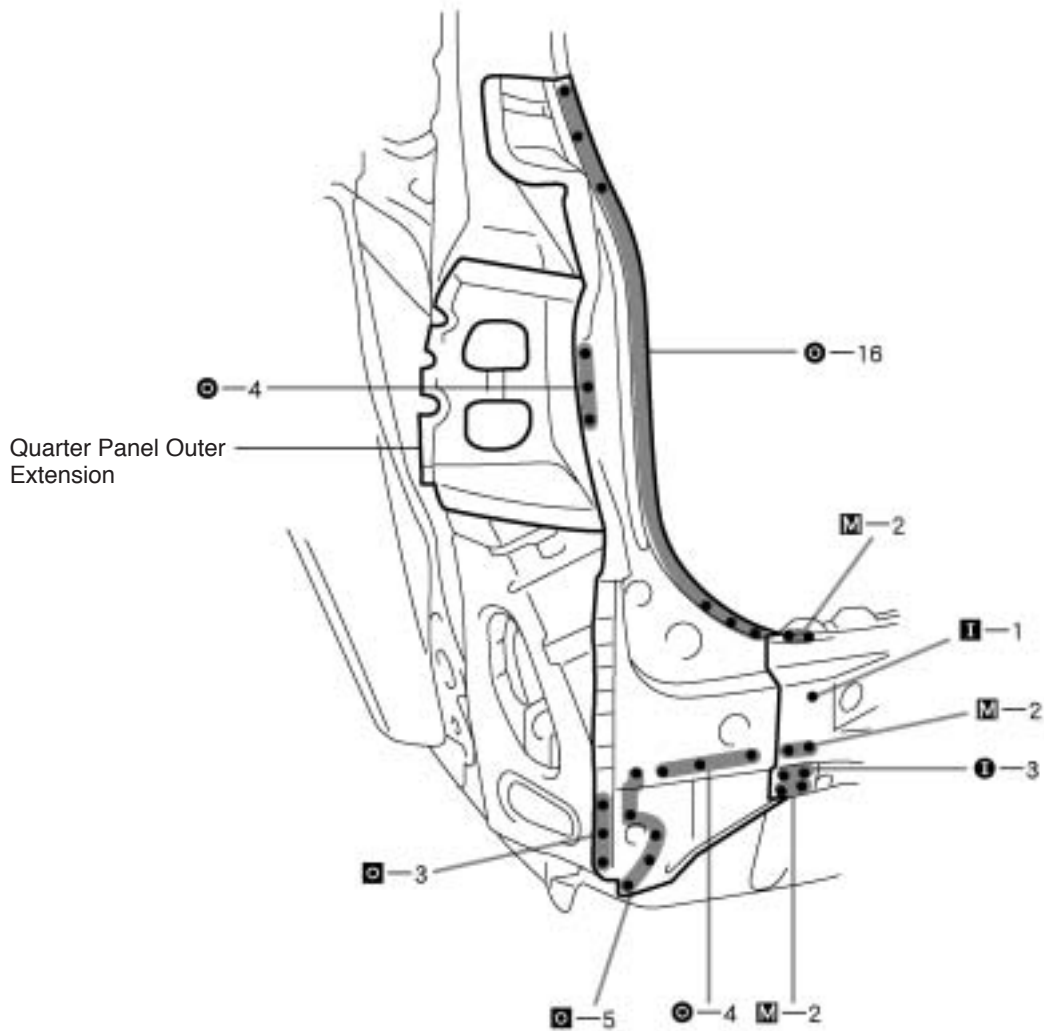

4. MEASURING OPENING PORTION DIMENSIONS ([See page BP-94](#))
5. INSTALL QUARTER PANEL
6. APPLYING SEALER TO THE INSIDE OF THE VEHICLE ([See page PC-1](#))
7. APPLYING SEALER TO THE REAR LUGGAGE COMPARTMENT ([See page PC-1](#))
8. APPLYING UNDER COATING ([See page PC-6](#))
9. APPLYING ANTI-RUST AGENT
 - (a) After applying the top coat layer, apply the anti-rust agent to the inside of the necked section structural weld spots.