

BODY LOWER BACK PANEL (ASSY) REPLACEMENT

1. REMOVE BODY LOWER BACK PANEL

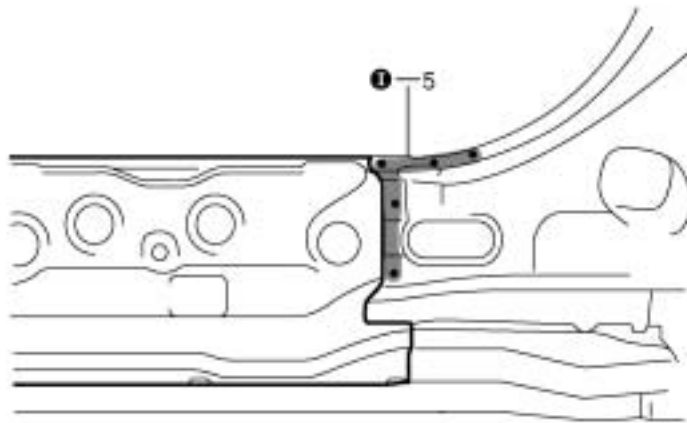
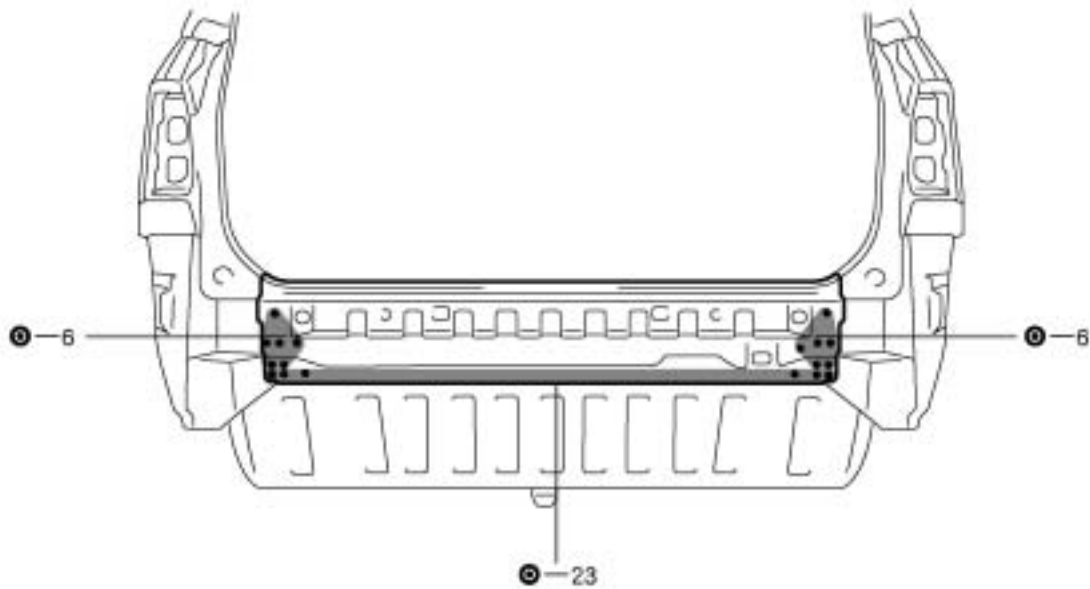

2. INSTALL BODY LOWER BACK PANEL

HINT:

Inspect the fitting of the back door since this affects the appearance of the finish.

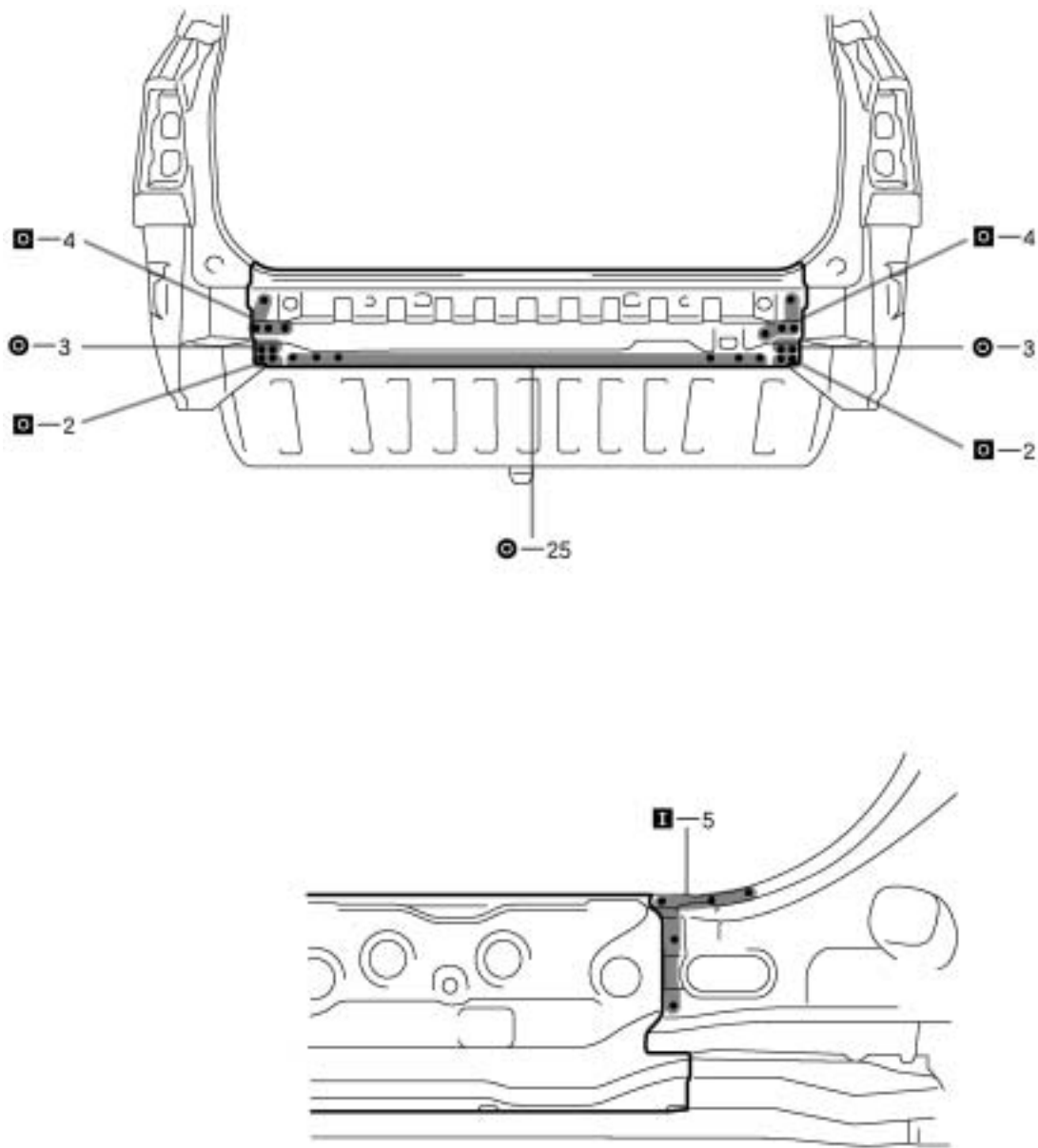

F12245

3. MEASURING OPENING PORTION DIMENSIONS (See page BP-94)**4. APPLYING SEALER TO THE REAR LUGGAGE COMPARTMENT (See page PC-1)****5. APPLYING UNDER COATING (See page PC-6)****6. APPLYING ANTI-RUST AGENT**

- (a) After applying the top coat layer, apply the anti-rust agent to the inside of the necked section structural weld spots.