

03U0FX-135

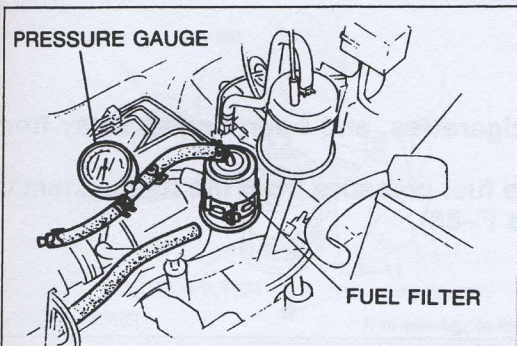

01A0FX-067

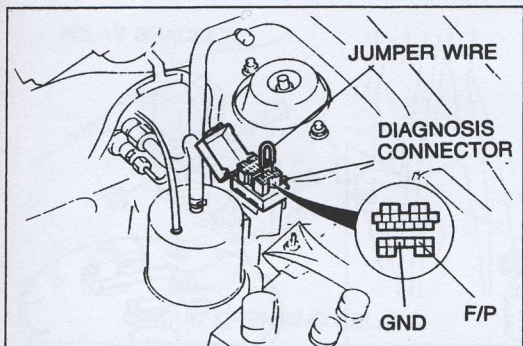

01E0F2-201

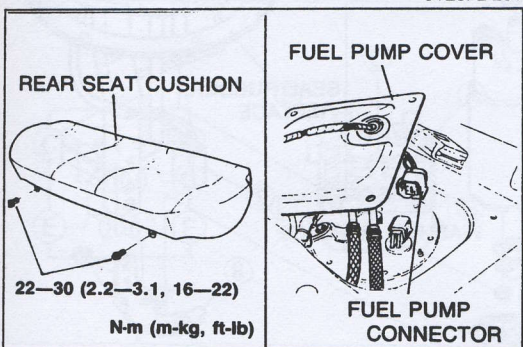

01E0F2-104

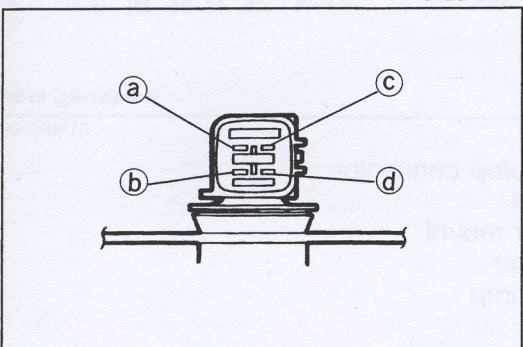

01A0FX-068

Installation Note

1. Push the ends of the main fuel hose, fuel return hose, and evaporative hoses onto the fuel tank fittings **at least 25mm (1.0 in)**.
2. Push the fuel filler hose onto the fuel tank pipe and filler pipe **at least 35mm (1.4 in)**.

FUEL PUMP

Inspection

Maximum pressure

Warning

- Before performing the following operation, release the fuel pressure from the fuel system to reduce the possibility of injury or fire. (Refer to page F-88.)
- When inspecting fuel system parts, keep sparks, cigarettes, and open flames away from the fuel.

1. Disconnect the negative battery cable.
2. Connect a fuel pressure gauge to the fuel main pipe and plug the outlet of the fuel pressure gauge as shown. (Install clamps as shown.)
3. Connect the negative battery cable.
4. Connect diagnosis connector terminals **F/P** and **GND** with a jumper wire.
5. Turn the ignition switch **ON for 10 sec.** to operate the fuel pump and measure the fuel pressure.

Fuel pressure:

491—658 kPa (5.0—6.5 kg/cm², 71.1—92.4 psi)

6. Turn the ignition switch **OFF** and disconnect the jumper wire.
7. If not as specified, replace the fuel pump.

Continuity

1. Remove the rear seat cushion.
2. Disconnect the fuel pump connector.

3. Check for continuity between the terminals (a) and (b) of the connector at the fuel pump shown in the figure.
4. If there is no continuity, replace the fuel pump. (Refer to page F-92.)

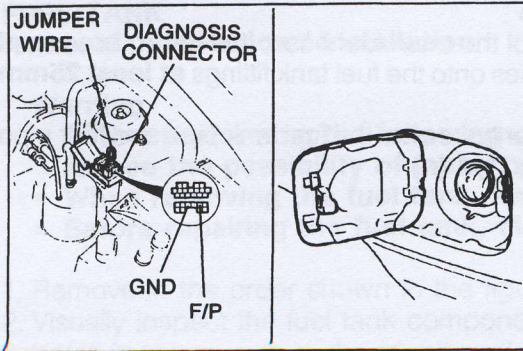

01A0FX-112

Fuel pump operation sound

1. Turn the ignition switch ON.
2. Connect diagnosis connector terminal **F/P** to **GND**.
3. Remove the fuel filler cap and verify that the fuel pump operation sound is heard.

Replacement**Warning**

- When replacing the fuel system parts, keep sparks, cigarettes, and open flames away from the fuel.
- Before performing the following operation, release the fuel pressure from the fuel system to reduce the possibility of injury or fire. (Refer to page F-88).

1. Remove in the order shown in the figure.
2. Install in the reverse order of removal.

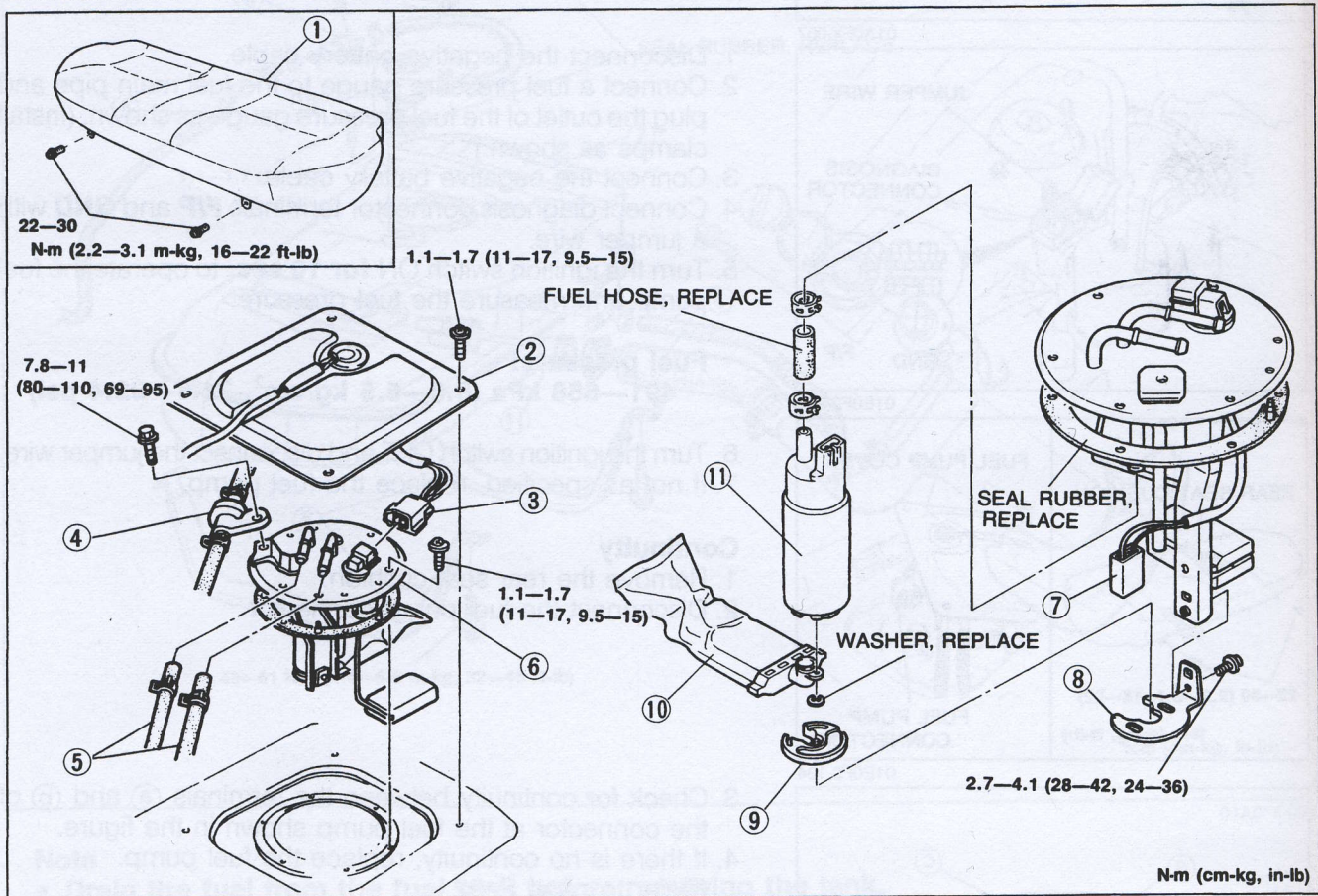

01A0FX-069

- | | |
|-----------------------------------|------------------------|
| 1. Rear seat cushion | 7. Fuel pump connector |
| 2. Fuel pump cover | 8. Bracket |
| 3. Fuel pump gauge unit connector | 9. Rubber mount |
| 4. Check valve | 10. Fuel filter |
| 5. Fuel hoses | 11. Fuel pump |
| 6. Fuel pump gauge unit | |