



Cruise Control

Component Location Index

SRS wire harness is routed near the cruise control related parts (SRS wire harness locations, page 16-117).

⚠ WARNING All SRS wire harness and connectors are colored yellow.
Do not use electrical test equipment on these circuit.

CAUTION: Be careful not to damage SRS wire harness when servicing the cruise control system.

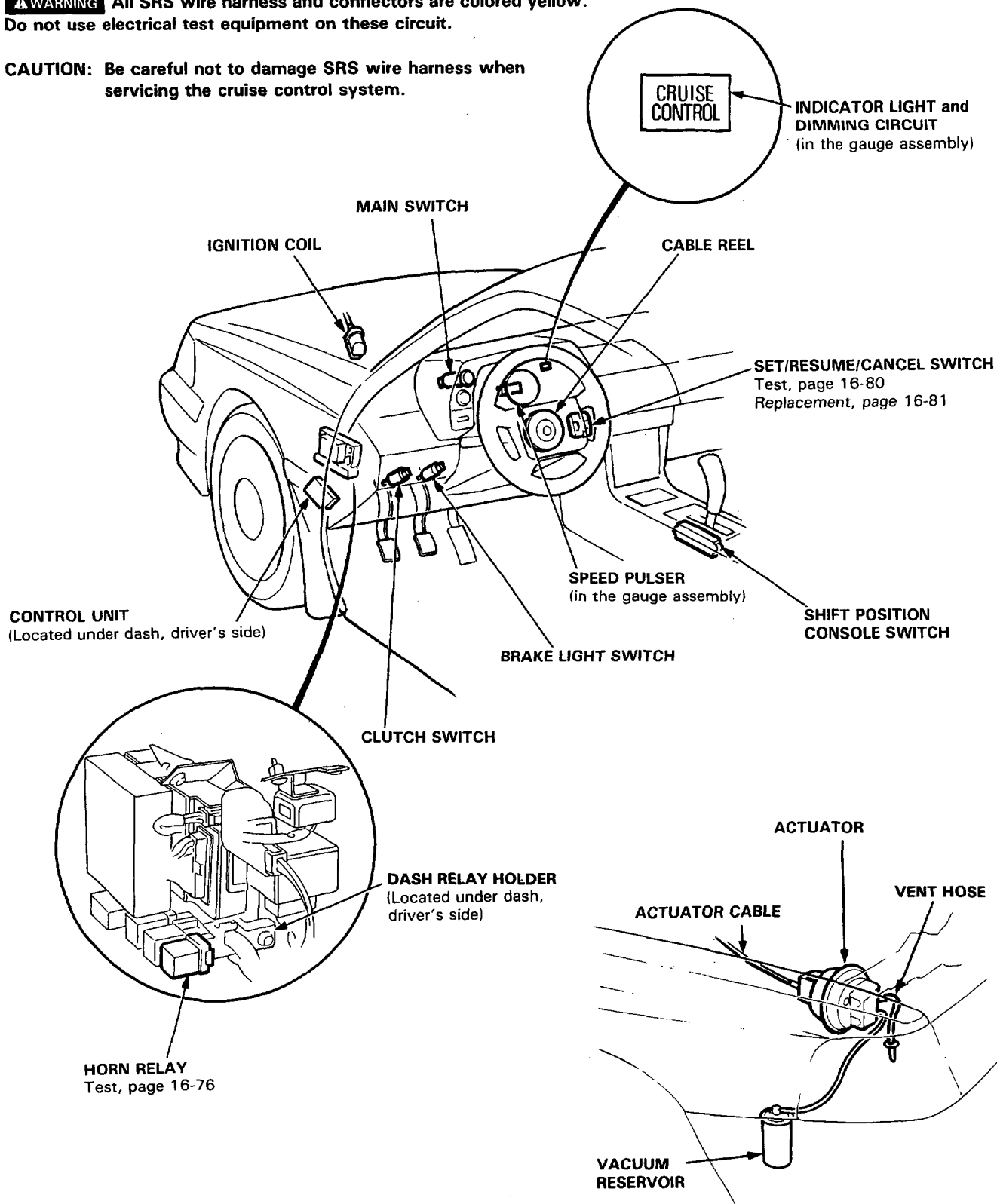

└ Circuit Diagram

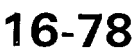



Troubleshooting

NOTE: The numbers in the table show the troubleshooting sequence.

Item to be inspected Symptom	Blown No. 14 (7.5 A) fuse (in the dash fuse box)	Main switch	Indicator light and its dimming circuit (in the gauge assembly)	SET/RESUME/CANCEL switch	Cable reel	Actuator cable free play	Actuator	Disconnected, clogged or restricted vacuum lines/stuck check valve/leaky vacuum reservoir	Clutch switch and mounting (M/T)	Shift position console switch (A/T)	Blown No. 31 (20 A) fuse (in the under-hood relay box)	Brake light switch	Control unit input	Poor ground	Open circuit in wires or loose or disconnected terminals
Cruise control can't be set.	1	2											3	G406 or G701	LT GRN or BLK/RED
Cruise control can be set, but indicator light does not go on.			1												BLU/BLK
Cruise speed noticeably higher or lower than what was set.													1		
Excessive overshooting and/or undershooting when trying to set speed.						1	2						3		
Steady speed not held even on a flat road with cruise control set.						1	3	2					4		
Car does not decelerate or accelerate accordingly when SET or RESUME button is pushed.				1	3								2		
Set speed not cancelled when clutch pedal is pushed. (M/T)									1				2		
Set speed not cancelled when shift lever is mov- ed to N. (A/T)										1			2		
Set speed not cancelled when brake pedal is pushed.											1	2	3		
Set speed not cancelled when CANCEL button is pushed.				1	3								2		
Set speed not resumed when RESUME button is pushed (with main switch on, but set speed temporarily cancelled).				1	3								2		

Cruise Control

Set/Resume/Cancel Switch Test

⚠ WARNING To avoid accidental deployment and possible injury always install the protective short connector on the inflator connector when the harness is disconnected.

1. Remove the dashboard lower panel.
2. Remove the steering wheel maintenance lid A, and disconnect the cable reel harness and airbag assembly 2-P connector. Connect the short connector (Red) to the airbag connector.

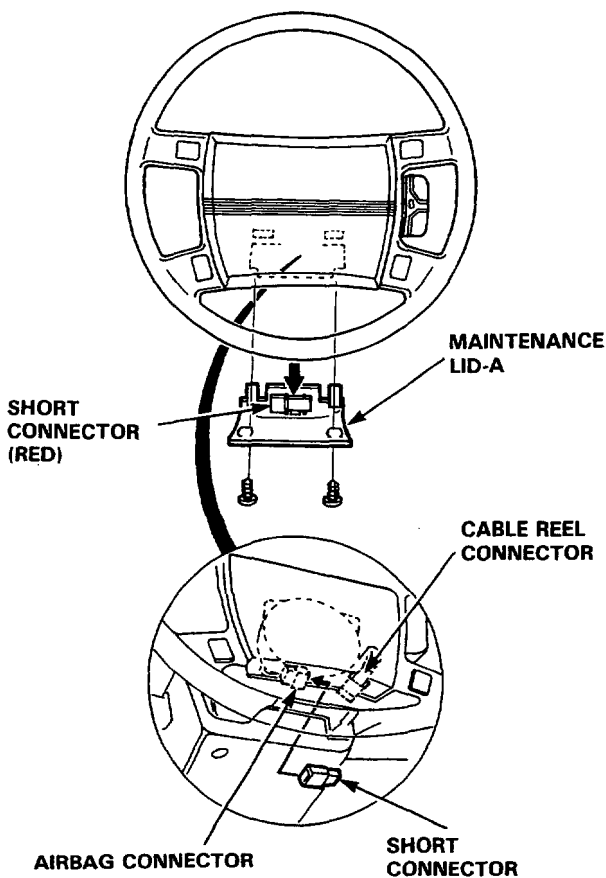

3. Remove the steering column lower cover.
4. Disconnect the cable reel 5-P connector, and connect the SRS test harness C to the cable reel connector.

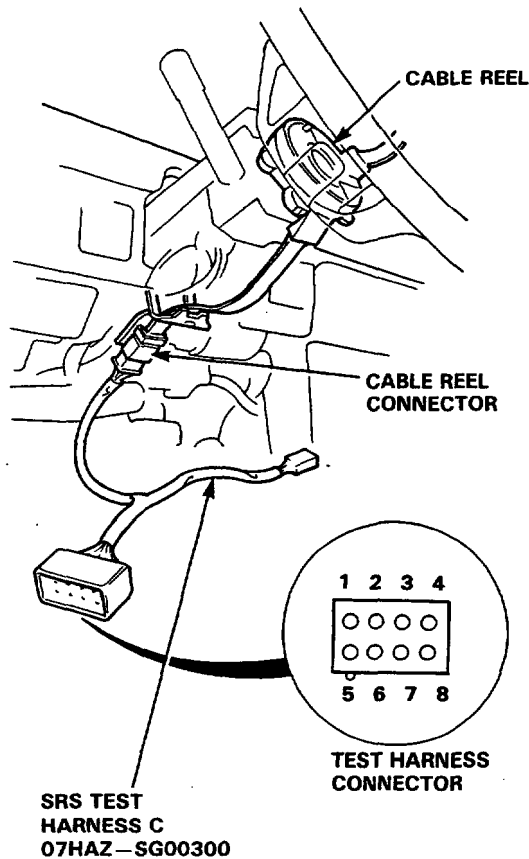

5. Check for continuity between the terminals of the 8-P test harness connector in each switch position according to the table.

Terminal Position	No.3 (BLU /RED)	No. 2 (LTGRN /RED)	No. 1 (LTGRN /BLK)
SET (ON)	○	○	
RESUME (ON)	○		○
CANCEL (ON)	○	○	○

- If the continuity check is OK, the SET/RESUME/CANCEL switch is OK.
- If there is no continuity in one or some switch positions, go to step 6.



6. Remove the cover from the SET/RESUME/CANCEL switch, then remove the 2 screws and pull the switch out of the steering wheel.

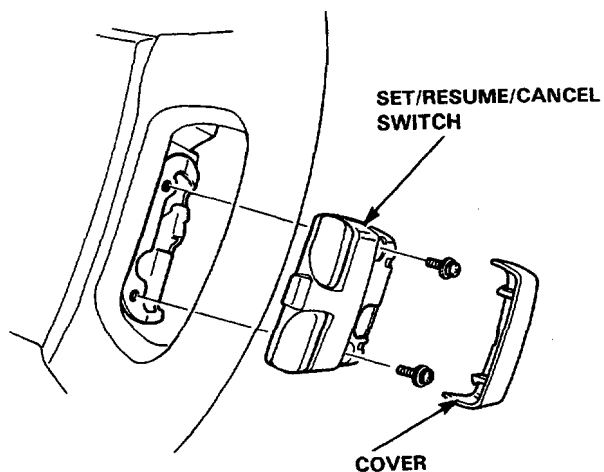

7. Check for continuity between the terminals in each switch position according to the table.

Terminal Position	A or A'		B	C
SET (ON)	○	—	○	
RESUME (ON)	○	—		○
CANCEL (ON)	○	—	○	○

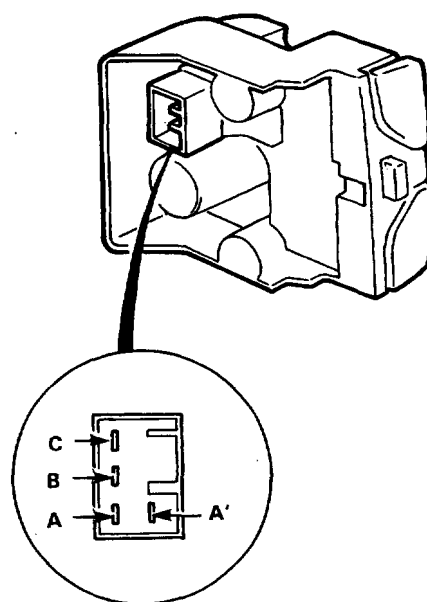

- If there is no continuity in one or some switch positions, replace the SET/RESUME/CANCEL switch.
- If the continuity check is OK, replace the cable reel (see section 11).