

Horns

Component Location Index

SRS wire harness is routed near the horns related parts (SRS wire harness locations, page 16-117).

⚠ WARNING All SRS wire harness and connectors are colored yellow.
Do not use electrical test equipment on these circuit.

CAUTION: Be careful not to damage SRS wire harness when servicing the horn system.

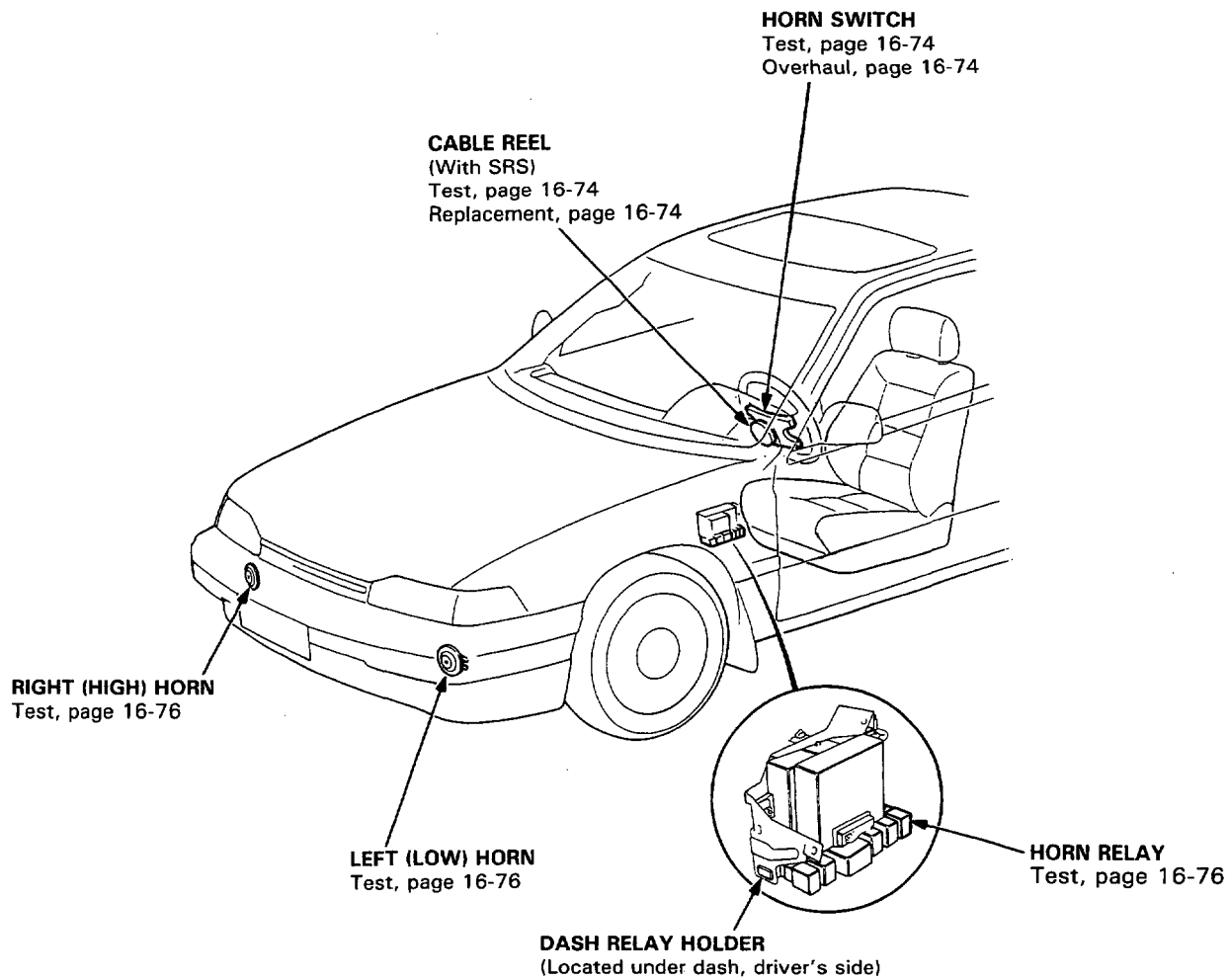



Circuit Diagram

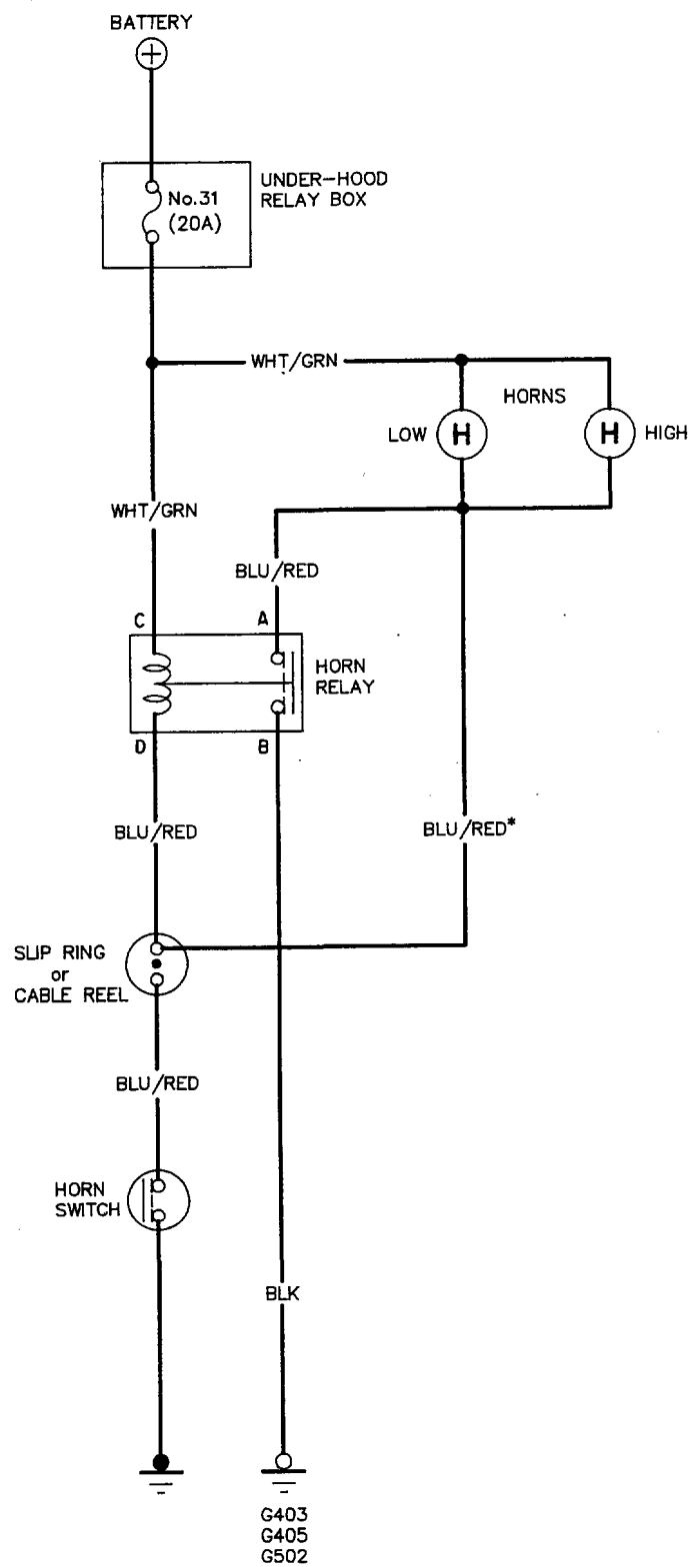

* : without SRS

Horns

Switch Test

⚠ WARNING Store a removed airbag assembly with the pad surface up. If the airbag is improperly stored face down, accidental deployment could propel the unit with enough force to cause serious injury.

CAUTION:

- Carefully inspect the airbag assembly before installing. Do not install an airbag assembly that shows signs of being dropped or improperly handled, such as dents, cracks or deformation.
- Always keep the short connector on the airbag connector when the harness is disconnected.
- Do not disassembly or tamper with the airbag assembly.

1. Disconnect both the negative cable and positive cable from the battery.
2. Make sure the wheels are aligned straight forward.
3. Remove the dashboard lower panel.
4. Remove the steering wheel maintenance lid A, and disconnect the cable reel harness and airbag assembly 2-P connector. Connect the short connector (Red) to the airbag connector.

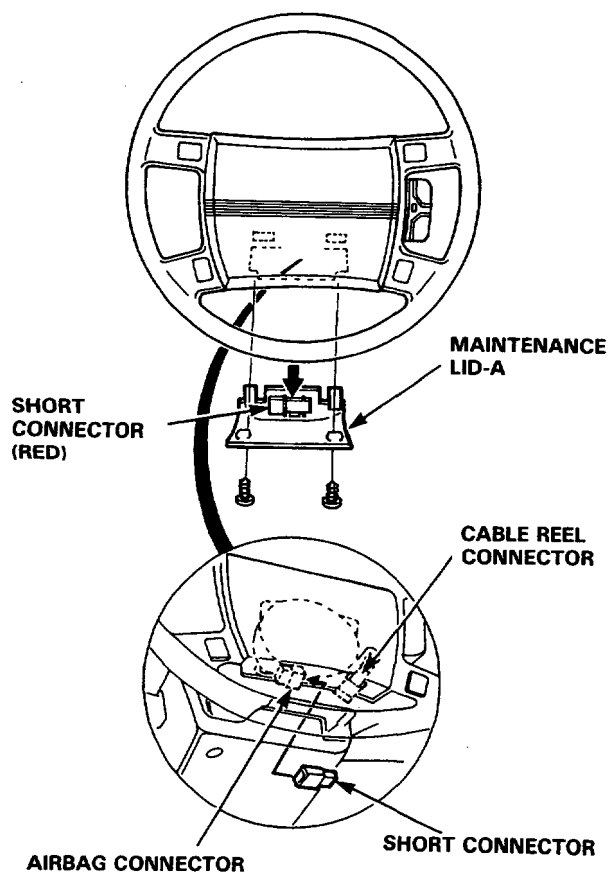

5. Remove the steering column lower cover.
6. Disconnect the cable reel 5-P connector, and connect the SRS test harness C to the cable reel connector.

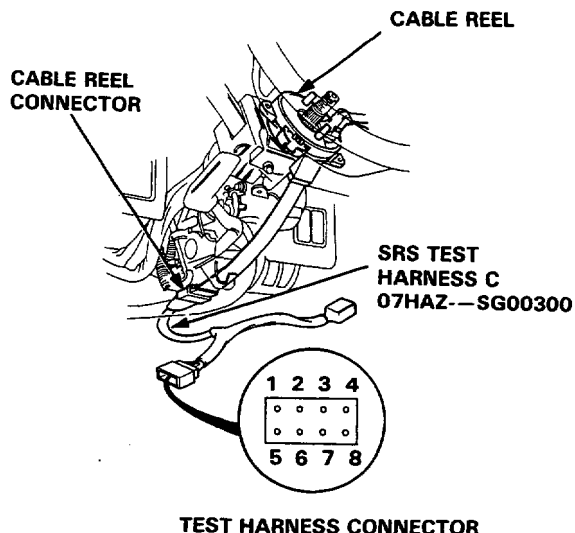

7. Check for continuity between the No. 3 (BLU/RED) terminal of the 8-P checker connector and body ground with the horn switch pressed. There should be continuity.
- If there is continuity, the horn switch is OK.
 - If there is no continuity, go to step 8.



8. Remove the steering wheel maintenance lid B and remove the cover from the cruise control set switch. Insert a TORX [®] driver and remove two TORX [®] bolts, then remove the airbag assembly.

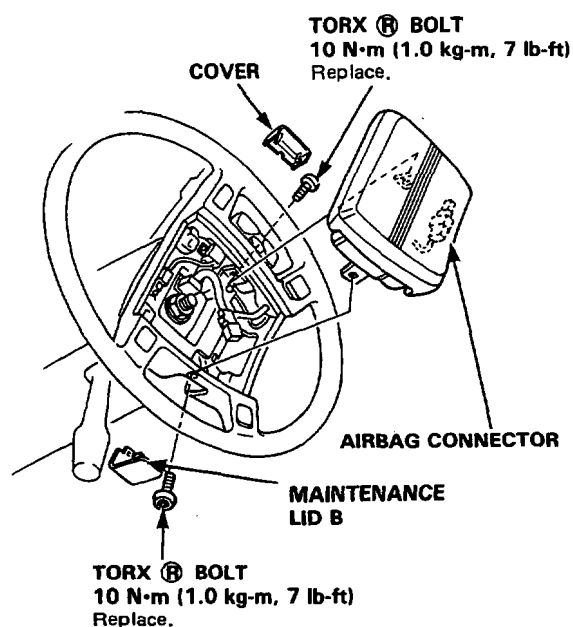

9. Check for continuity between the horn positive terminal and the steering column shaft with the horn switch pressed. There should be continuity.

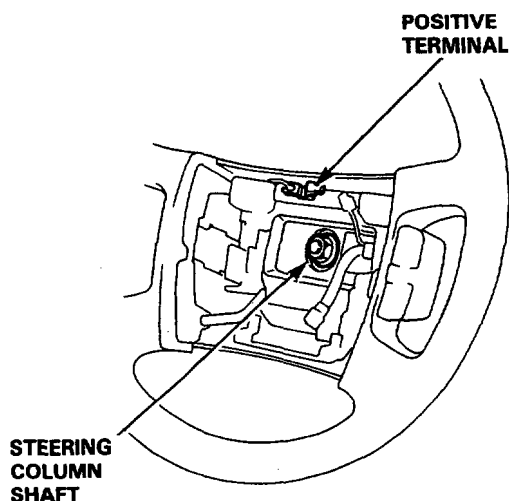

- If there is continuity, replace the cable reel (see section 11).
- If there is no continuity, remove the nut and the 4 screws, then remove the steering wheel cover. Repair the horn switch.

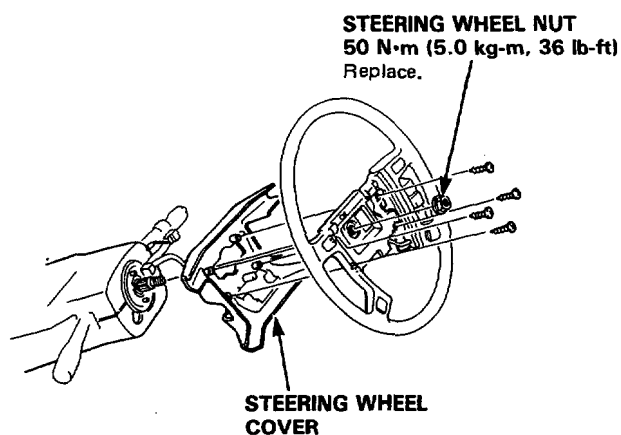

10. Install the steering wheel (see section 11).

Horns

Horn Test

1. Remove the front bumper.
2. Disconnect the wires from the horn.
3. Test the horn by connecting battery voltage to the A and B terminals. The horn should sound.
4. If the horn fails to sound, replace it.

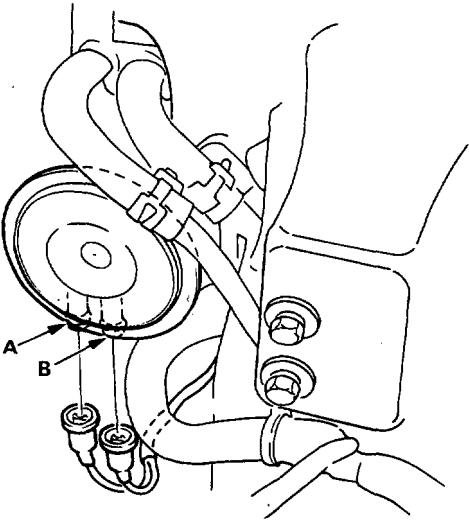

Relay Test

1. Remove the dashboard lower panel and the horn relay in the dash relay holder.
2. There should be continuity between the A and B terminals when the battery is connected to the C and D terminals. There should be no continuity when the battery is disconnected.

