

Warning/Caution Labels

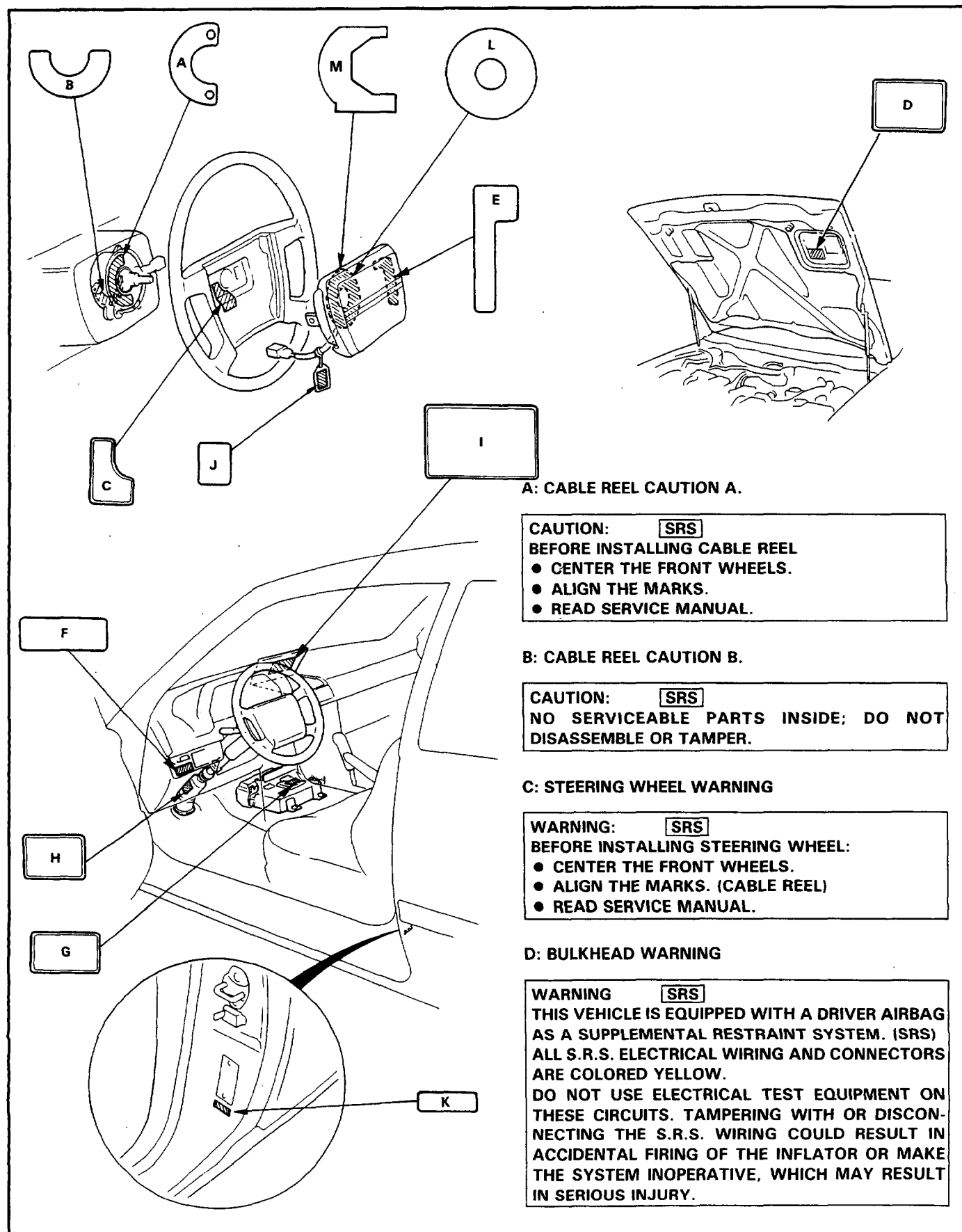

A: CABLE REEL CAUTION A.

CAUTION: **SRS**
 BEFORE INSTALLING CABLE REEL
 • CENTER THE FRONT WHEELS.
 • ALIGN THE MARKS.
 • READ SERVICE MANUAL.

B: CABLE REEL CAUTION B.

CAUTION: **SRS**
 NO SERVICEABLE PARTS INSIDE; DO NOT
 DISASSEMBLE OR TAMPER.

C: STEERING WHEEL WARNING

WARNING: **SRS**
 BEFORE INSTALLING STEERING WHEEL:
 • CENTER THE FRONT WHEELS.
 • ALIGN THE MARKS. (CABLE REEL)
 • READ SERVICE MANUAL.

D: BULKHEAD WARNING

WARNING **SRS**
 THIS VEHICLE IS EQUIPPED WITH A DRIVER AIRBAG
 AS A SUPPLEMENTAL RESTRAINT SYSTEM. (SRS)
 ALL S.R.S. ELECTRICAL WIRING AND CONNECTORS
 ARE COLORED YELLOW.
 DO NOT USE ELECTRICAL TEST EQUIPMENT ON
 THESE CIRCUITS. TAMPERING WITH OR DISCON-
 NECTING THE S.R.S. WIRING COULD RESULT IN
 ACCIDENTAL FIRING OF THE INFLATOR OR MAKE
 THE SYSTEM INOPERATIVE, WHICH MAY RESULT
 IN SERIOUS INJURY.

E: MODULE WARNING

WARNING **SRS**
TO PREVENT ACCIDENTAL DEPLOYMENT AND POSSIBLE INJURY:
ALWAYS INSTALL THE PROTECTIVE SHORT CONNECTOR ON THE INFLATOR CONNECTOR WHEN THE HARNESS IS DISCONNECTED.
UNDER NO CIRCUMSTANCES SHOULD DIAGNOSIS BE PERFORMED USING ELECTRICAL TEST EQUIPMENT OR PROBING DEVICES.
NO SERVICEABLE PARTS INSIDE. DO NOT DISASSEMBLE OR TAMPER.
STORE THE REMOVED AIRBAG ASSEMBLY WITH THE PAD SURFACE UP.
FOR SPECIAL HANDLING OR STORAGE REFER TO THE HONDA SERVICE MANUAL.
DISPOSE OF THE ENTIRE UNIT AS DIRECTED.

F: DRIVER INFORMATION

SRS ALWAYS WEAR YOUR SEAT BELT.
 • THIS CAR IS EQUIPPED WITH A DRIVER AIRBAG AS A SUPPLEMENTAL RESTRAINT SYSTEM (S.R.S.).
 • IT IS DESIGNED TO SUPPLEMENT THE SEAT BELT.

G: SRS UNIT CAUTION

CAUTION **SRS**
 • **NO SERVICEABLE PARTS INSIDE.**
 • **DO NOT DISASSEMBLE OR TAMPER.**
 • **DO NOT DROP.**
 • **STORE IN A CLEAN, DRY AREA.**

H: STEERING COLUMN CAUTION

CAUTION **SRS**
TO AVOID DAMAGING THE S.R.S. CABLE OR REEL, WHICH COULD MAKE THE SYSTEM INOPERATIVE, REMOVE THE STEERING WHEEL BEFORE REMOVING THE STEERING SHAFT CONNECTOR BOLT.

I: POCKET INFORMATION

DRIVER'S AIRBAG INFORMATION **SRS**
 • SUPPLEMENTAL RESTRAINT SYSTEM (SRS) CAN PROVIDE ADDITIONAL PROTECTION FOR THE DRIVER IN A FRONTAL COLLISION. A FUNCTIONAL DESCRIPTION OF THE SRS IS IN YOUR OWNER'S MANUAL.
 • THE SYSTEM MUST BE INSPECTED TEN YEARS AFTER DATE OF MANUFACTURE, AS NOTED ON THE CERTIFICATION PLATE.
 • ANY REPAIR, INSPECTION OR NEARBY ACCESSORY INSTALLATION SHOULD BE DONE BY AN HONDA DEALER.
 • IF YOUR SRS INDICATOR:
 • LIGHTS WHILE DRIVING OR FLASHES;
 • FAILS TO LIGHT OR STAYS ON AFTER THE IGNITION IS FIRST TURNED ON;
 • SEE YOUR AUTHORIZED HONDA DEALER.

J: STEERING WHEEL WARNING

WARNING **SRS**
TO PREVENT ACCIDENTAL DEPLOYMENT AND POSSIBLE INJURY:
ALWAYS INSTALL THE PROTECTIVE SHORT CONNECTOR ON THE INFLATOR CONNECTOR WHEN THE HARNESS IS DISCONNECTED.

K: LABEL **AIRBAG**

L: INFLATOR LABEL

DANGER POISON
 KEEP OUT OF THE REACH OF CHILDREN
 CONTAINS SODIUM AZIDE AND POTASSIUM NITRATE. CONTENTS ARE POISONOUS AND EXTREMELY FLAMMABLE. CONTACT WITH ACID, WATER, OR HEAVY METALS MAY PRODUCE HARMFUL AND IRRITATING GASES OR EXPLOSIVE COMPOUNDS. DO NOT DISMANTLE, INCINERATE OR BRING INTO CONTACT WITH ELECTRICITY OR STORE AT TEMPERATURES EXCEEDING 93°C (200°F).
 FIRST AID: IF CONTENTS ARE SWALLOWED INDUCE VOMITING.
 – FOR EYE CONTACT, FLUSH EYES WITH WATER FOR 15 MINUTES.
 – IF GASES FROM ACID OR WATER CONTACT ARE INHALED, SEEK FRESH AIR. IN EVERY CASE, GET PROMPT MEDICAL ATTENTION.

M: INFLATOR COVER LABEL

DANGER **SRS**
EXPLOSIVE/FLAMMABLE
 CONTACT WITH ACID, WATER, OR HEAVY METALS SUCH AS COPPER, LEAD, OR MERCURY, MAY PRODUCE HARMFUL AND IRRITATING GASES OR EXPLOSIVE COMPOUNDS. STORAGE TEMPERATURES MUST NOT EXCEED 93°C (200°F). FOR PROPER HANDLING, STORAGE, AND DISPOSAL PROCEDURES REFER TO THE HONDA SERVICE MANUAL.
POISON
 CONTAINS POISONOUS SODIUM AZIDE AND POTASSIUM NITRATE.
 FIRST AID:
 IF CONTENTS ARE SWALLOWED, INDUCE VOMITING. FOR EYE CONTACT, FLUSH EYES WITH WATER FOR 15 MINUTES. IF GASES (FROM ACID OR WATER CONTACT) ARE INHALED, SEEK FRESH AIR. IN EVERY CASE, GET PROMPT MEDICAL ATTENTION.
 KEEP OUT OF REACH OF CHILDREN.