

A/T Speed Pulser

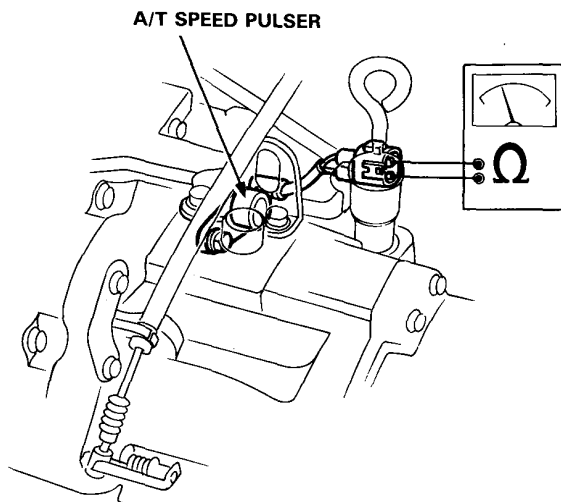

Test

1. Apply the parking brake, block the rear wheels and jack up the front of the car.
2. Disconnect the A/T speed pulser 2P connector.
3. Rotate the front wheels and be sure that continuity and no continuity appear alternately between the two terminals.



Removal/Inspection

1. Remove the 6 mm bolt from the transmission housing and remove the A/T speed pulser assembly.

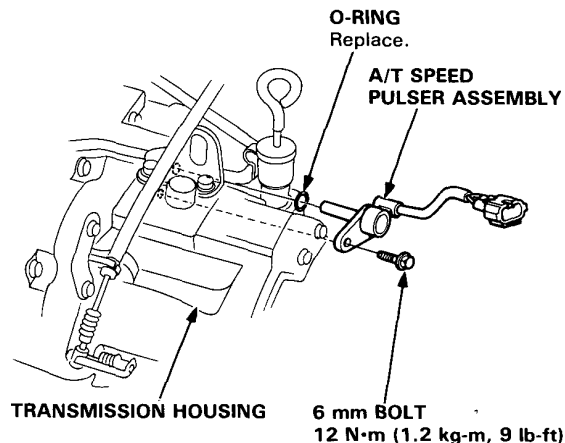

2. Bring a magnet close to the A/T speed pulser assembly and check for continuity.

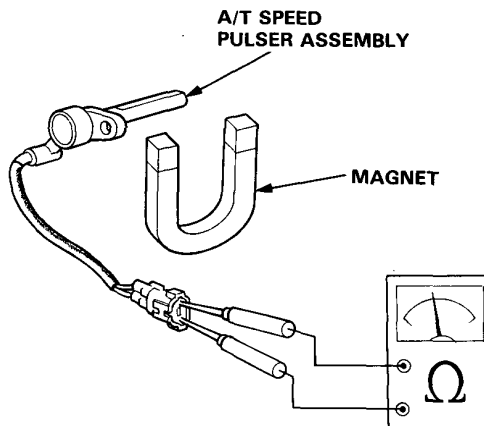

A/T speed pulser assembly is in good condition if there is:

- Continuity with a magnet close to the pulser assembly.
- No continuity with a magnet away from the pulser assembly.

If the A/T speed pulser is normal, go to Rotor Disassembly/Inspection.

3. Replace the O-ring with a new one before reassembling the A/T speed pulser.

CAUTION: Carefully inspect the A/T speed pulser before installing. Do not install it that shows signs of being dropped or improperly handled.