

# Wire Harness and Ground Locations

## Engine Compartment

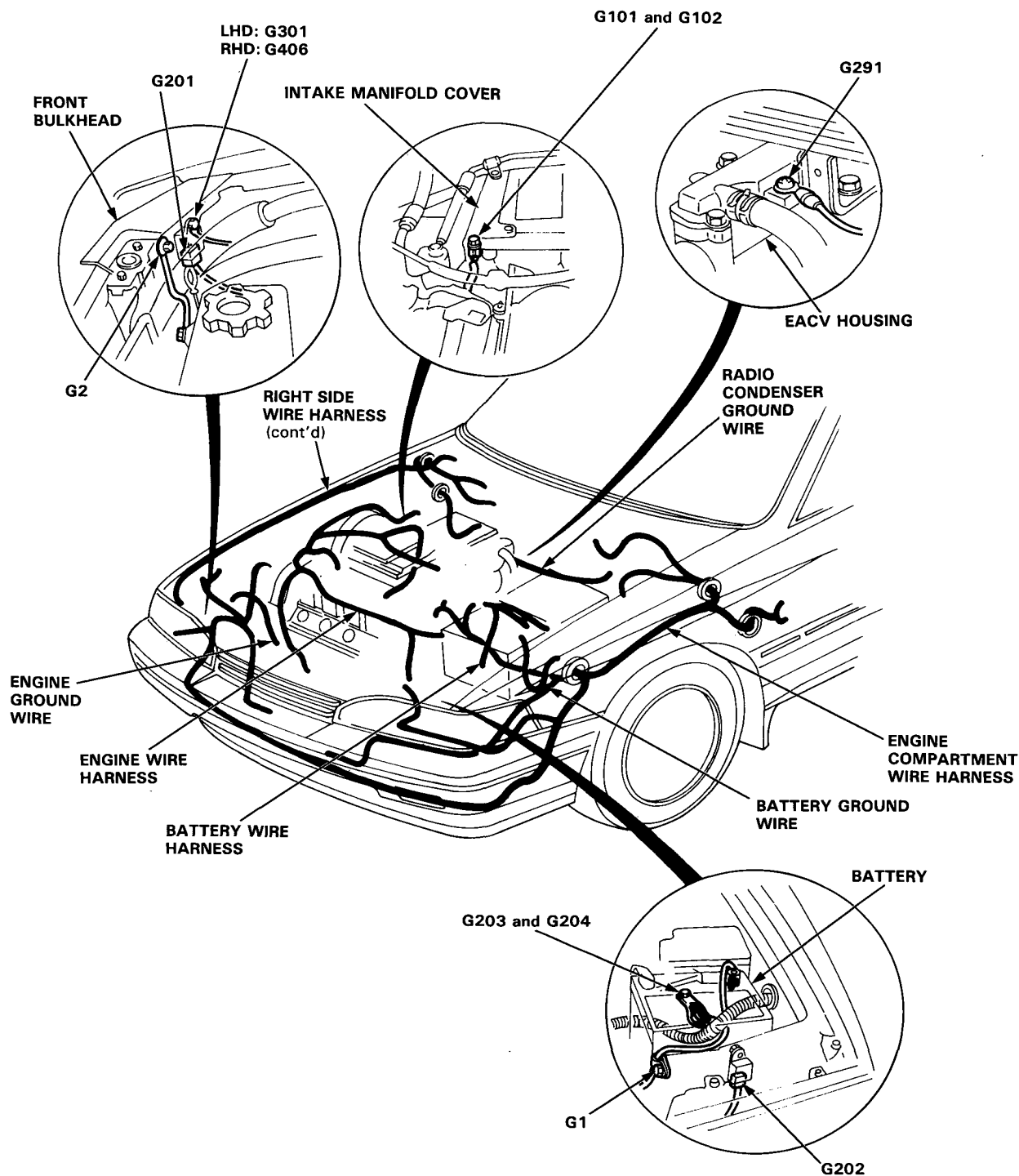



# Wire Harness and Ground Locations

Floor (LHD)

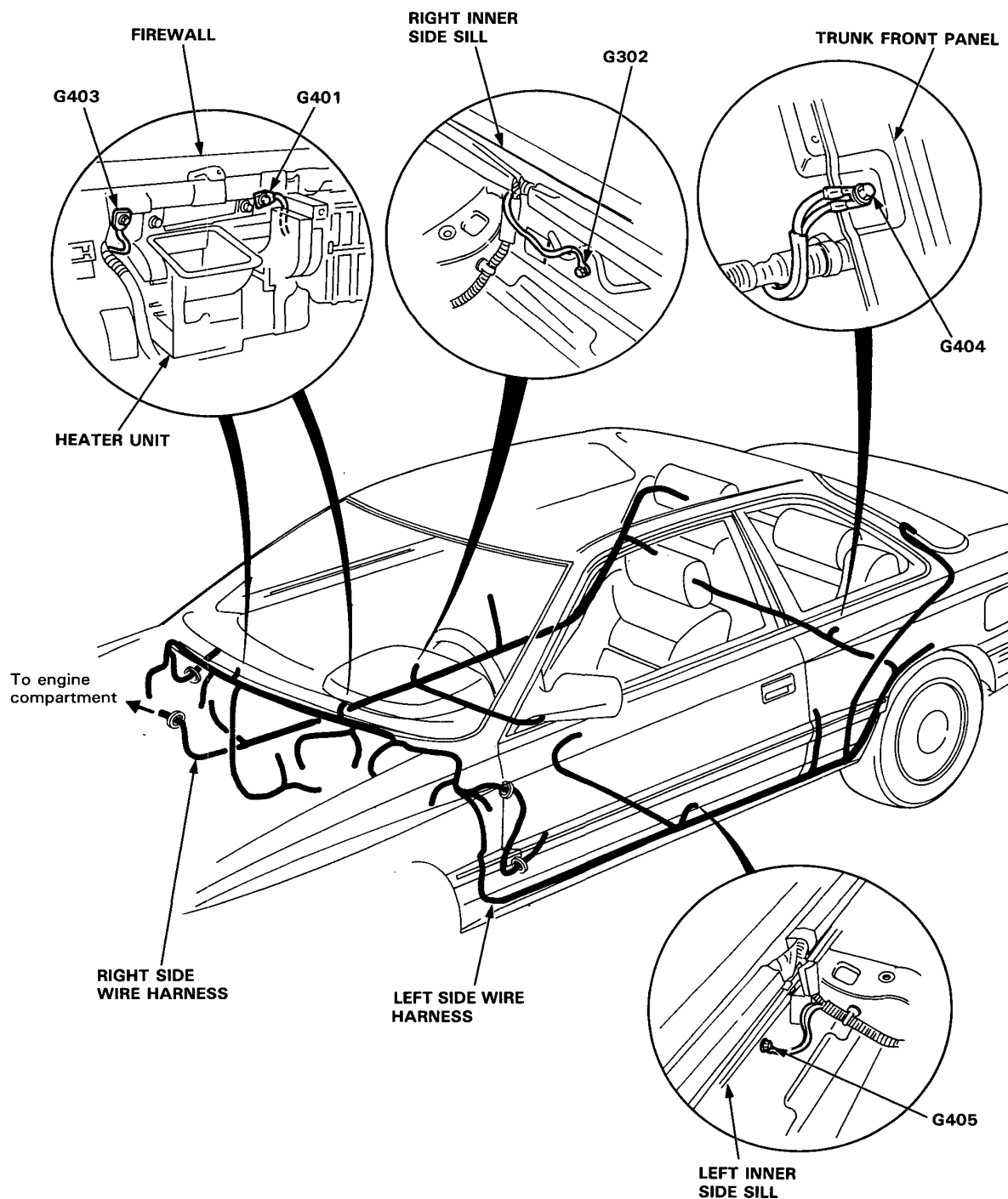





(RHD)

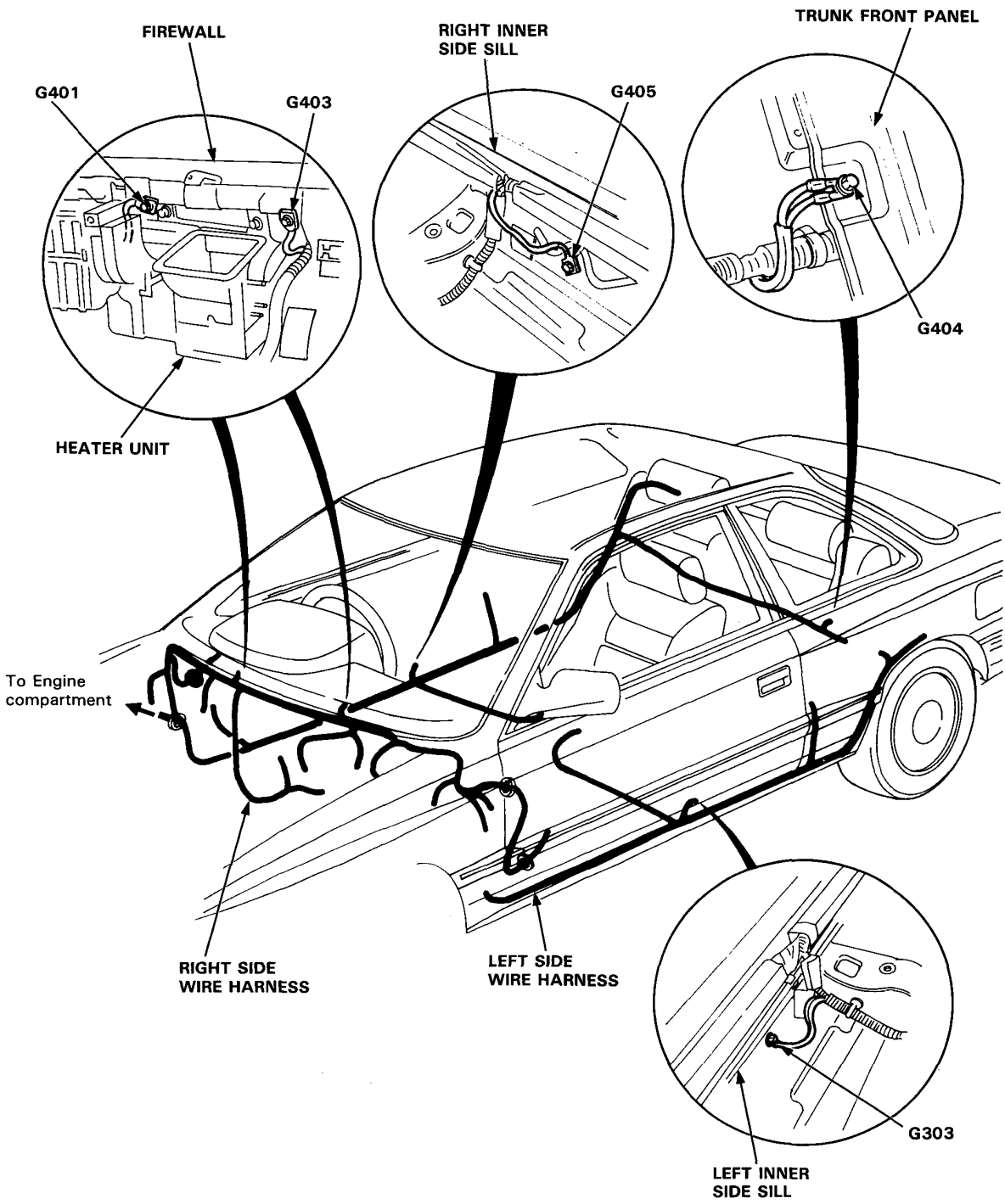



# Wire Harness and Ground Locations

## Trunk, Door and Roof (LHD)

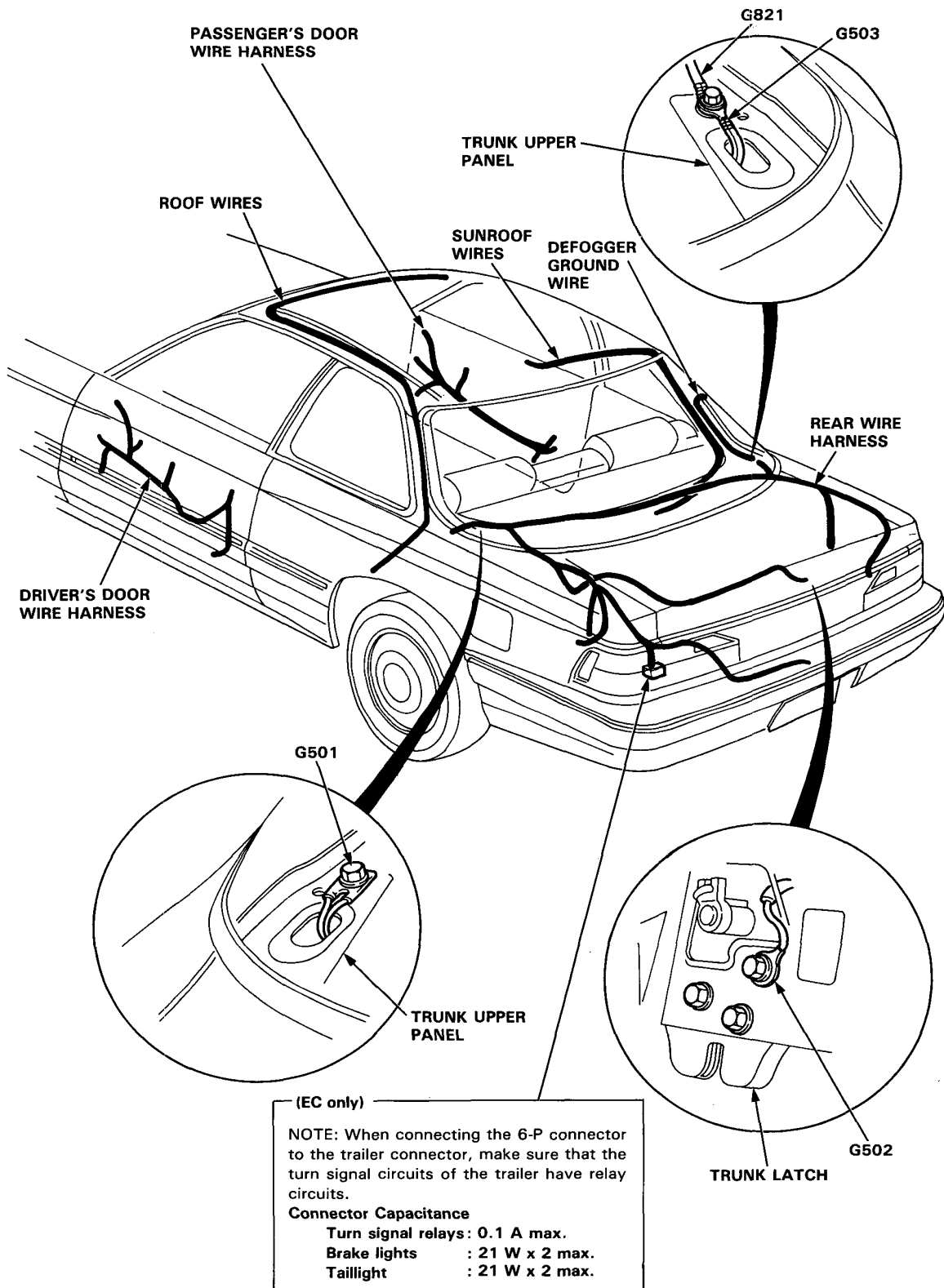





(RHD)

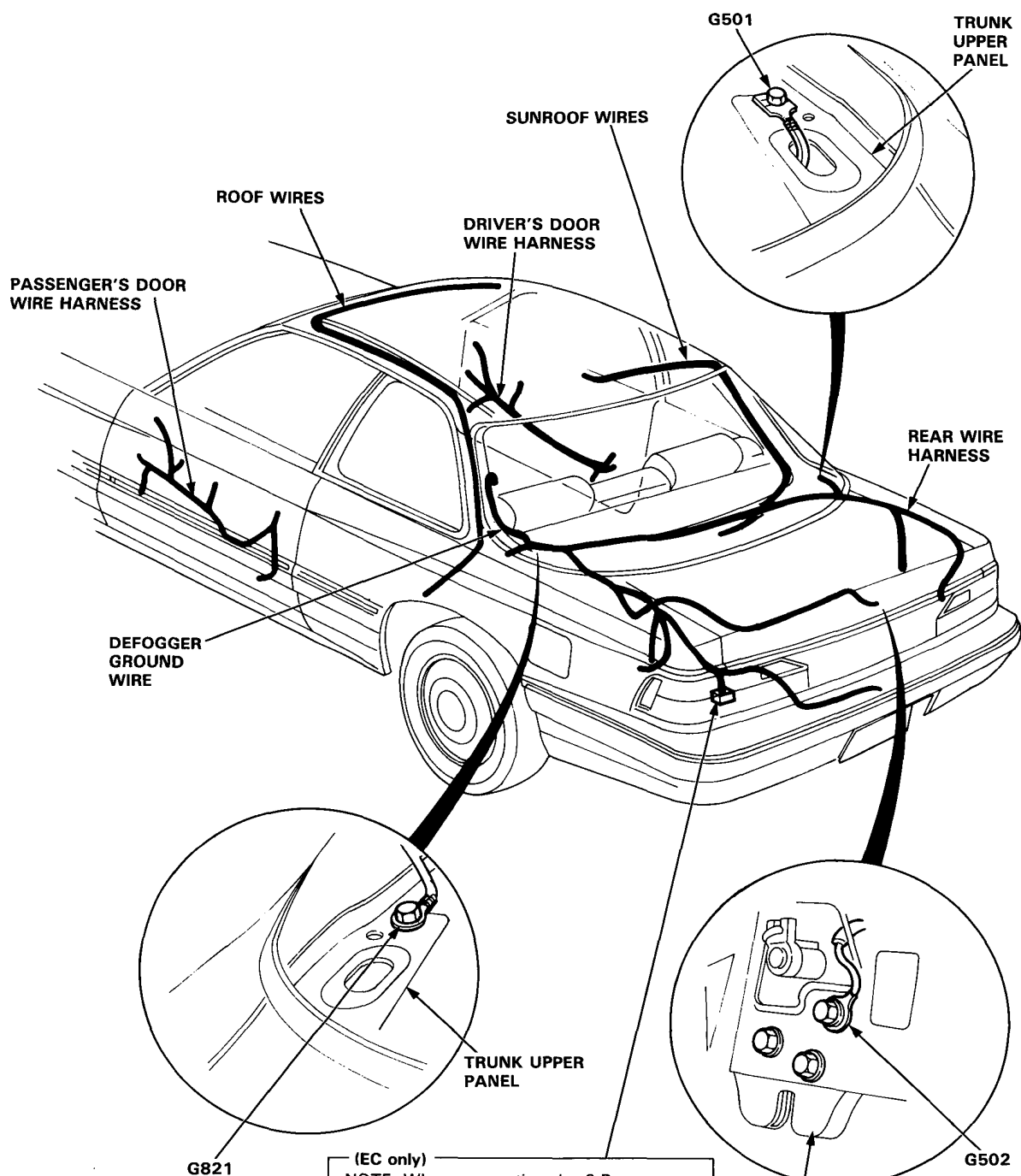

(EC only)

NOTE: When connecting the 6-P connector to the trailer connector, make sure that the turn signal circuits of the trailer have relay circuits.

**Connector Capacitance**

Turn signal relays: 0.1 A max.  
Brake lights : 21 W x 2 max.  
Taillight : 21 W x 2 max.



# Wire Harness and Ground Locations

## Dashboard (LHD)

---

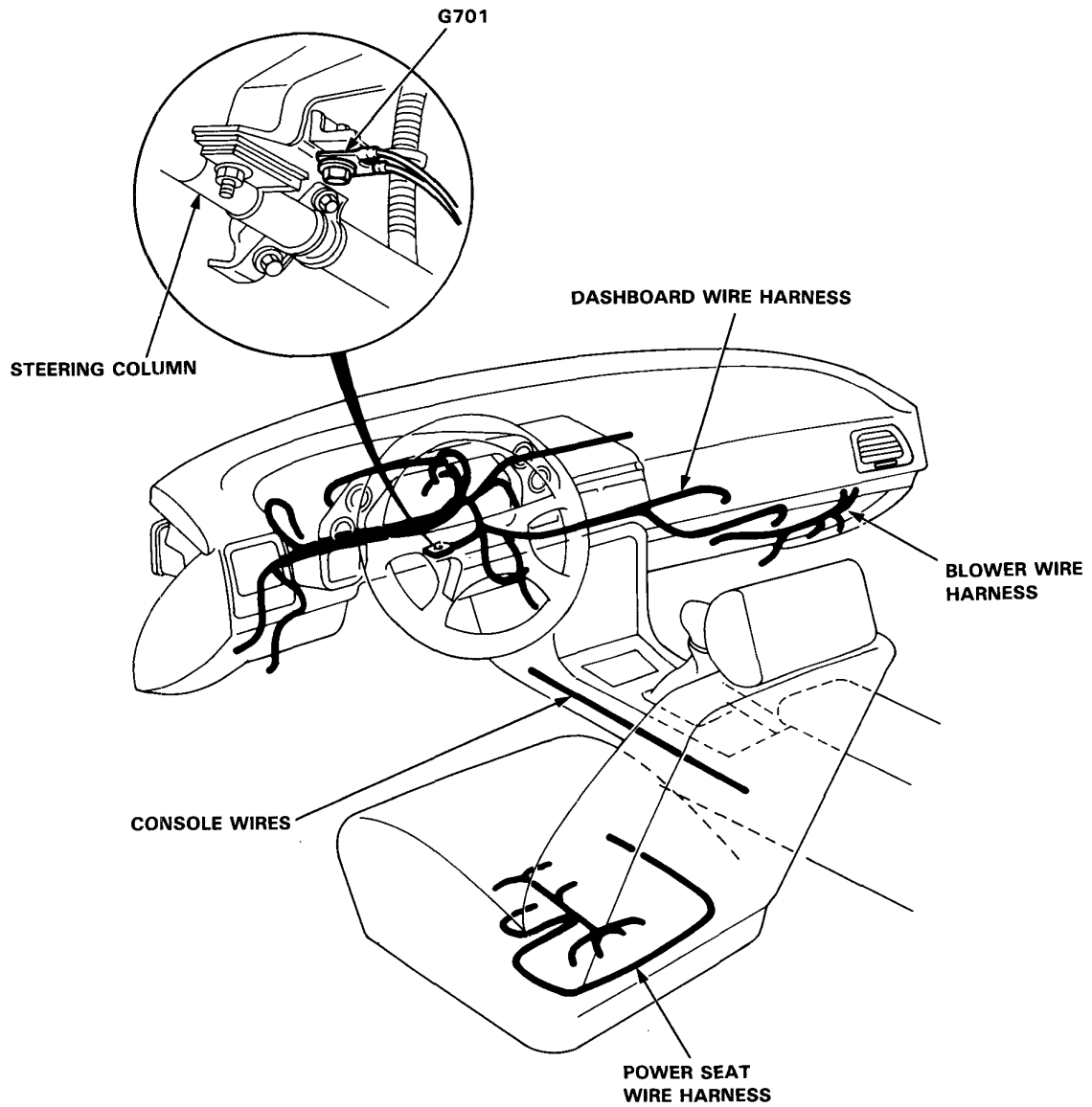





(RHD)

