

Brake Booster

Pushrod Clearance Adjustment

NOTE: Master cylinder pushrod-to-piston clearance must be checked and adjustments made, if necessary, before installing master cylinder.

1. Using the Brake Booster Rod Adjustment Gauge, adjust bolt so the end of it contacts the end of master cylinder piston.

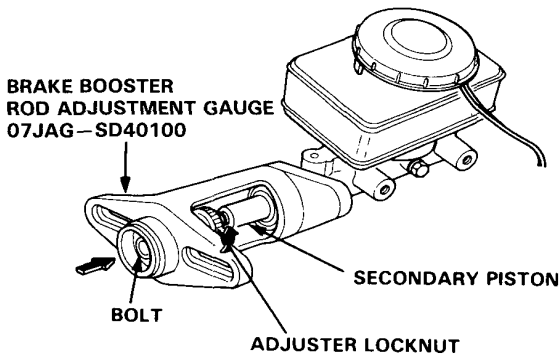

2. Without disturbing the adjusting bolt's position, install the master cylinder rod seal on the adjustment gauge and put the gauge upside down on the booster.
3. Install the master cylinder nuts and tighten to the specified torque.
4. Connect the booster in-line with a vacuum gauge (0–30 in Hg) to the booster's engine vacuum supply, and draw 500 mm Hg (20 in Hg) vacuum.
5. With a feeler gauge, measure the clearance between the gauge body and the adjusting nut as shown.

CLEARANCE: 0.2±0.2 mm (0.008±0.008 in.)

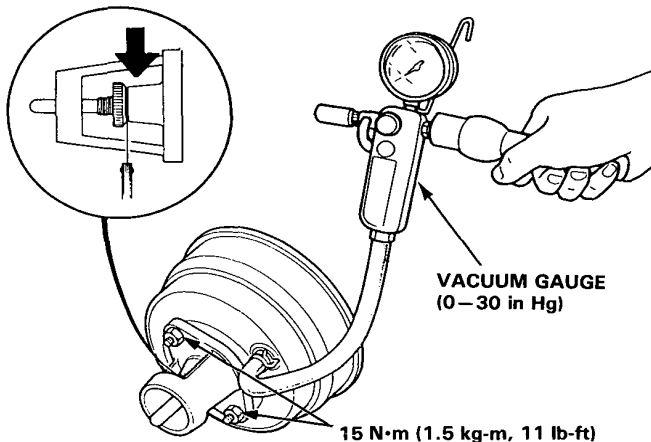

6. If the clearance is in correct remove the tool, and adjust the clearance by holding the pushrod and turning the adjuster in or out.

CAUTION: Do not pull out the push rod from the brake booster.

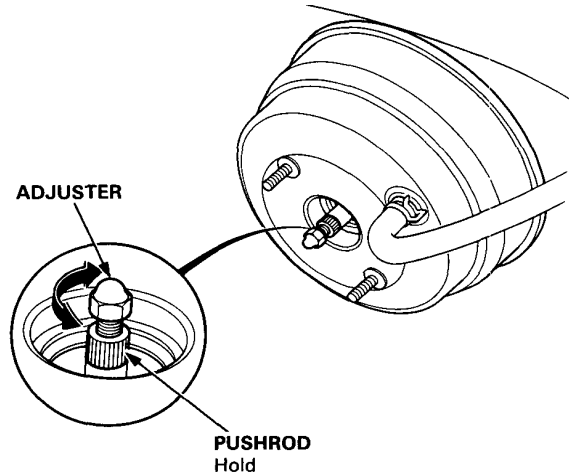

NOTE: If the clearance between the gauge body and adjuster locknut is 0 mm, the pushrod-to-piston clearance is 0.4 mm or more. If the clearance between the gauge body and adjuster lock nut is 0.4 mm, the pushrod-to-piston clearance is 0 mm.

7. Install the master cylinder.