

Maintenance



Pump Belt Adjustment

A properly adjusted belt should deflect about 19-24 mm (0.75–0.94 in.) when you push on it mid-way between the pulleys with a force of about 98N (10 kg, 22 lbs).

NOTE: On a brand new belt, the deflection should be 13–16 mm (1/2–5/8 in.) when first measured.

1. Remove the belt cover.
2. Loosen the pump adjusting nut, and pivot bolt.
3. Pry the pump away from the engine to get the proper tension, then retighten the adjusting nut, and pivot bolt.

10 x 1.25 mm
45 N·m
(4.5 kg-m, 33 lb-ft)

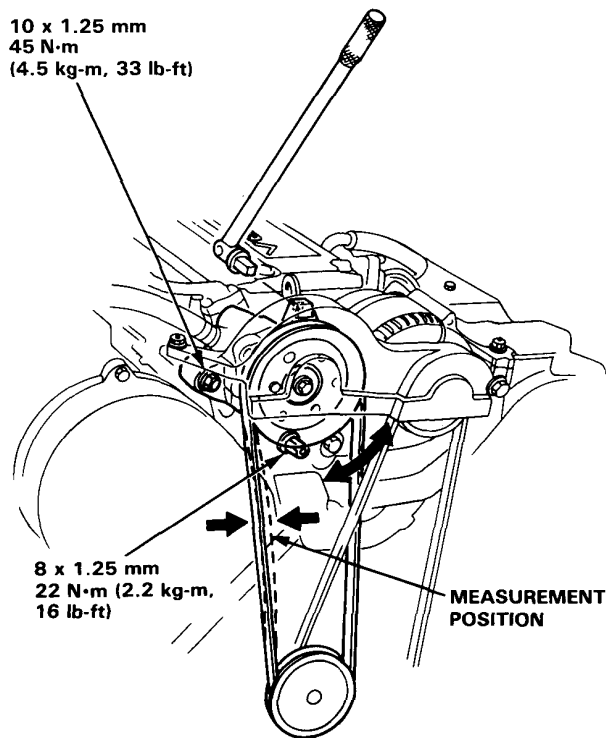

8 x 1.25 mm
22 N·m (2.2 kg-m,
16 lb-ft)

MEASUREMENT
POSITION

Fluid Replacement

Check the reservoir at regular intervals, and add fluid as necessary.

CAUTION: Use only **GENUINE HONDA Power Steering Fluid**. Using other fluids such as ATF or other manufacturer's power steering fluid will damage the system.

Fluid Level

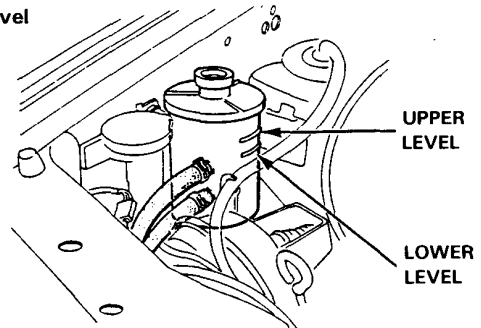

Fluid Replacement

CAPACITY: 1.7 l (1.8 US qt) at change

1. Disconnect the return hose from the gearbox at the reservoir, and put the end in a suitable container.
2. Start the engine, let it run at idle, and turn the steering wheel from lock-to-lock several times. When fluid stops running out of the hose, shut off the engine. Discard the fluid.

Install a plug

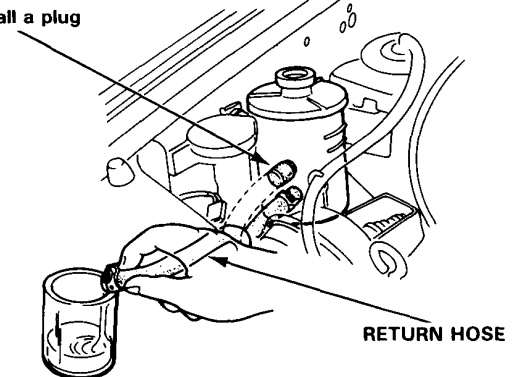

3. Refit the return hose on the reservoir.
4. Fill the reservoir to the upper level mark.
5. Start the engine and run it at fast idle, then turn the steering from lock-to-lock several times to bleed air from the system.
6. Recheck the fluid level and add some if necessary.

CAUTION: Do not fill the reservoir beyond the upper level mark.