

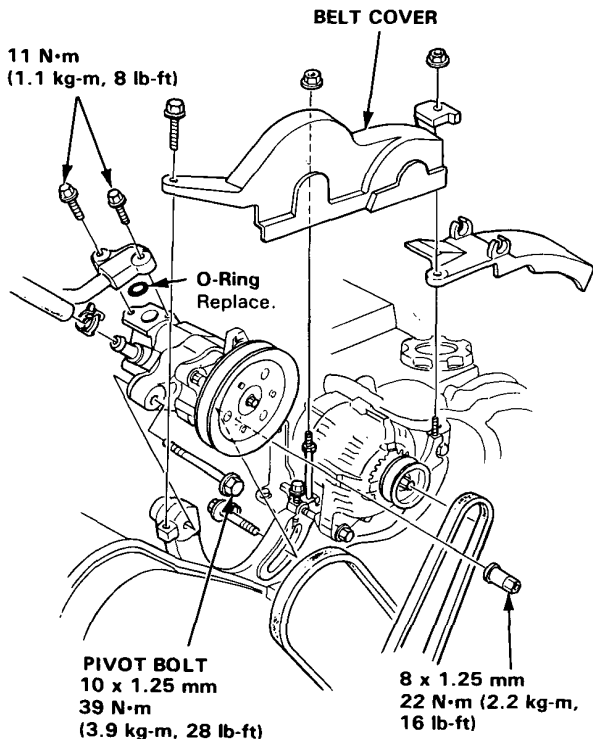

Replacement

1. Remove the belt cover.
2. Drain the fluid from the system (page 11-9).
3. Disconnect the inlet and outlet hoses from the pump and plug them.
4. Remove the belt by loosening the pump pivot bolt.
5. Remove the bolt and nut, then remove the pump.



6. Loosely install the new pump on the bracket.
7. Connect the inlet and outlet hoses to the pump.
8. Install and adjust the belt (page 11-9).
9. Install the belt cover.
10. Fill the reservoir with new fluid to the UPPER LEVEL on the reservoir.
11. Start the engine and let it run at fast idle while turning the steering wheel lock-to-lock several times to bleed air from the system.
12. Check the reservoir and add fluid if necessary.

Preload Inspection

Check the pump preload with a torque wrench.

Preload: 4 N·m (0.4 kg-m, 3 lb-ft) max.

