

Illustrated Index

Right Side Cover

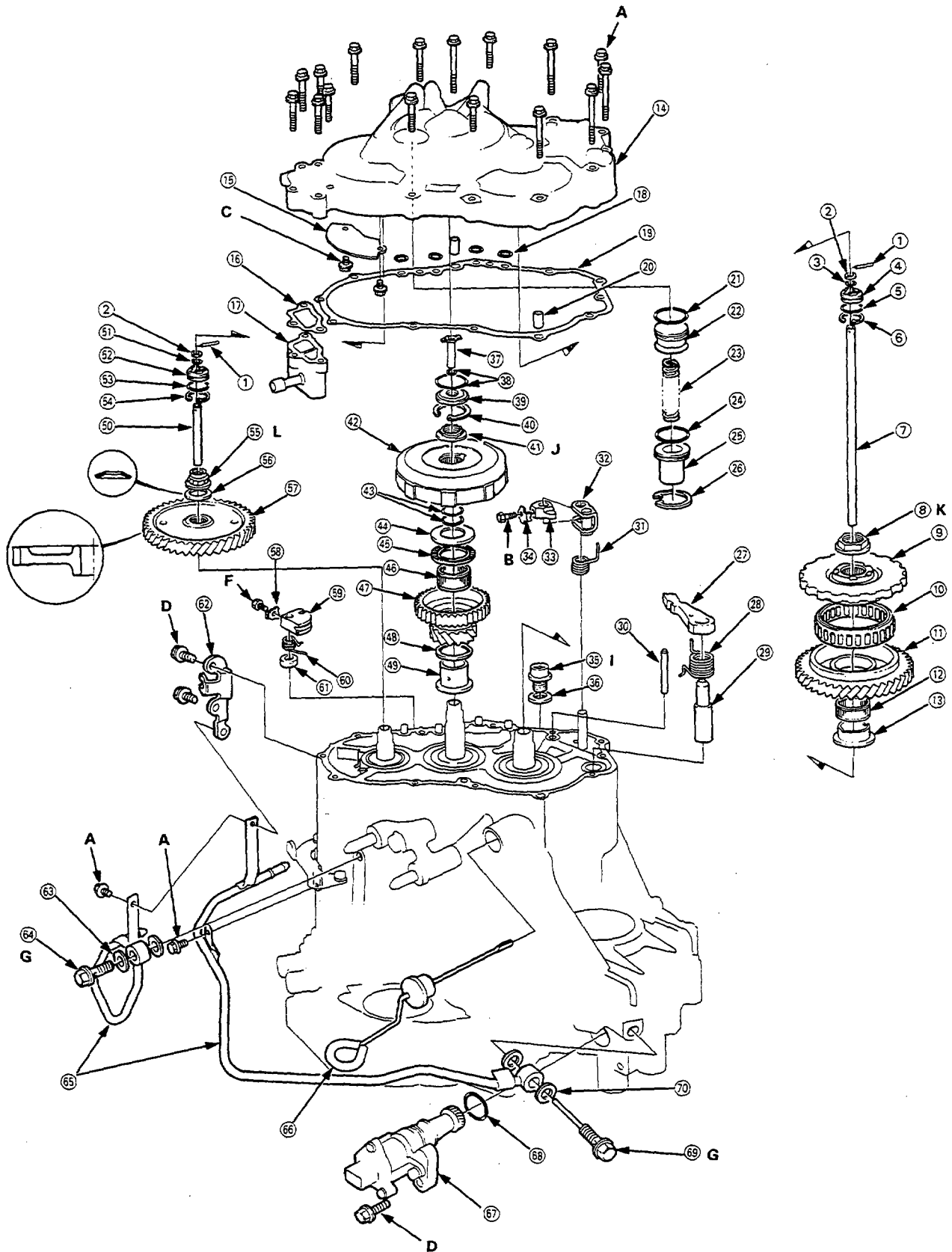



- | | | | |
|---|--|----|---|
| ① | ROLLER | ③⑦ | 1ST CLUTCH FEED PIPE |
| ② | COLLAR | ③⑧ | O-RINGS Replace. |
| ③ | O-RING Replace. | ③⑨ | FEED PIPE GUIDE |
| ④ | FEED PIPE FLANGE | ④① | SNAP RING |
| ⑤ | O-RING Replace. | ④② | MAINSHAFT LOCKNUT (FLANGE NUT) Replace. |
| ⑥ | SNAP RING | ④③ | 1ST CLUTCH ASSEMBLY |
| ⑦ | 3RD CLUTCH FEED PIPE | ④④ | O-RINGS Replace. |
| ⑧ | COUNTERSHAFT LOCKNUT (FLANGE NUT) Replace. | ④⑤ | THRUST WASHER |
| ⑨ | PARKING GEAR | ④⑥ | THRUST NEEDLE BEARING |
| ⑩ | ONE-WAY CLUTCH ASSEMBLY | ④⑦ | NEEDLE BEARING |
| ⑪ | COUNTERSHAFT 1ST GEAR | ④⑧ | MAINSHAFT 1ST GEAR |
| ⑫ | NEEDLE BEARING | ④⑨ | THRUST WASHER |
| ⑬ | COUNTERSHAFT 1ST GEAR COLLAR | ⑤① | MAINSHAFT 1ST GEAR COLLAR |
| ⑭ | RIGHT SIDE COVER | ⑤② | 1ST-HOLD CLUTCH FEED PIPE |
| ⑮ | BREATHER COVER | ⑤③ | O-RING Replace. |
| ⑯ | BREATHER CHAMBER GASKET Replace. | ⑤④ | FEED PIPE GUIDE |
| ⑰ | BREATHER CHAMBER | ⑤⑤ | O-RING Replace. |
| ⑱ | O-RINGS Replace. | ⑤⑥ | SNAP RING |
| ⑲ | RIGHT SIDE COVER GASKET Replace. | ⑤⑦ | SUB-SHAFT LOCKNUT |
| ⑳ | DOWEL PINS | ⑤⑧ | (FLANGE NUT) Replace. |
| ㉑ | O-RING Replace. | ⑤⑨ | CONICAL SPRING WASHER Replace. |
| ㉒ | 1ST-HOLD ACCUMULATOR PISTON | ⑥① | SUB-SHAFT 1ST GEAR |
| ㉓ | 1ST-HOLD ACCUMULATOR SPRING | ⑥② | LOCK WASHER Replace. |
| ㉔ | O-RING Replace. | ⑥③ | THROTTLE CONTROL DRUM |
| ㉕ | 1ST-HOLD ACCUMULATOR COVER | ⑥④ | THROTTLE CONTROL DRUM SPRING |
| ㉖ | SNAP RING | ⑥⑤ | OIL SEAL Replace. |
| ㉗ | PARKING BRAKE PAWL | ⑥⑥ | THROTTLE CONTROL CABLE HOLDER |
| ㉘ | PARKING BRAKE PAWL SPRING | ⑥⑦ | SEALING WASHERS Replace. |
| ㉙ | PARKING BRAKE PAWL SHAFT | ⑥⑧ | ATF COOLER PIPE JOINT BOLT |
| ㉚ | PARKING BRAKE PAWL STOPPER | ⑥⑨ | ATF COOLER PIPES |
| ㉛ | PARKING BRAKE LEVER SPRING | ⑦① | ATF DIPSTICK |
| ㉜ | PARKING BRAKE LEVER | ⑦② | VEHICLE SPEED SENSOR |
| ㉝ | PARKING BRAKE STOPPER Selective part | ⑦③ | O-RING Replace. |
| ㉞ | LOCK WASHER Replace. | ⑦④ | ATF COOLER PIPE JOINT BOLT |
| ㉟ | DRAIN PLUG | ⑦⑤ | SEALING WASHERS Replace. |
| ㊱ | SEALING WASHER Replace. | | |

TORQUE SPECIFICATIONS

Ref. No.	Torque Value	Bolt Size	Remarks
A	12 N·m (1.2 kgf·m, 8.7 lbf·ft)	6 x 1.0 mm	Special bolt
B	14 N·m (1.4 kgf·m, 10 lbf·ft)	6 x 1.0 mm	
C	11 N·m (1.1 kgf·m, 8 lbf·ft)	6 x 1.0 mm	
D	22 N·m (2.2 kgf·m, 16 lbf·ft)	8 x 1.25 mm	
F	8 N·m (0.8 kgf·m, 6 lbf·ft)	5 x 0.8 mm	
G	28 N·m (2.9 kgf·m, 21 lbf·ft)	12 x 1.25 mm	ATF cooler pipe joint bolt
I	49 N·m (5.0 kgf·m, 36 lbf·ft)	18 x 1.5 mm	Drain plug
J	93 N·m (9.5 kgf·m, 69 lbf·ft)	19 x 1.25 mm	Mainshaft locknut (flange nut): Left-hand threads
K	137—0—137 N·m (14.0—0—14.0 kgf·m, 101—0—101 lbf·ft)	23 x 1.25 mm	Countershaft locknut (flange nut)
L	93 N·m (9.5 kgf·m, 69 lbf·ft)	19 x 1.25 mm	Sub-shaft locknut (flange nut)