

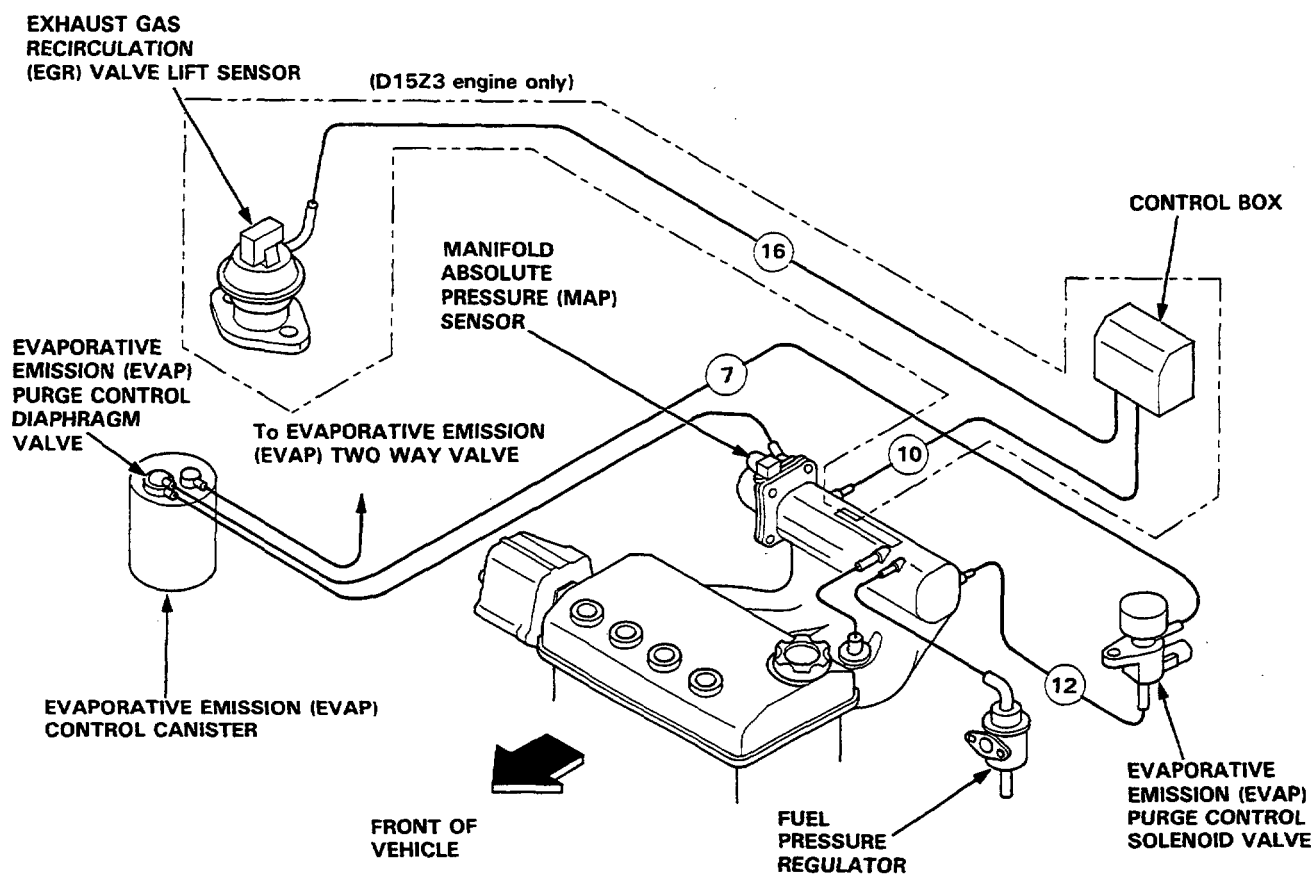

System Description

Vacuum Connections



Control Box
(D15Z3 engine only)

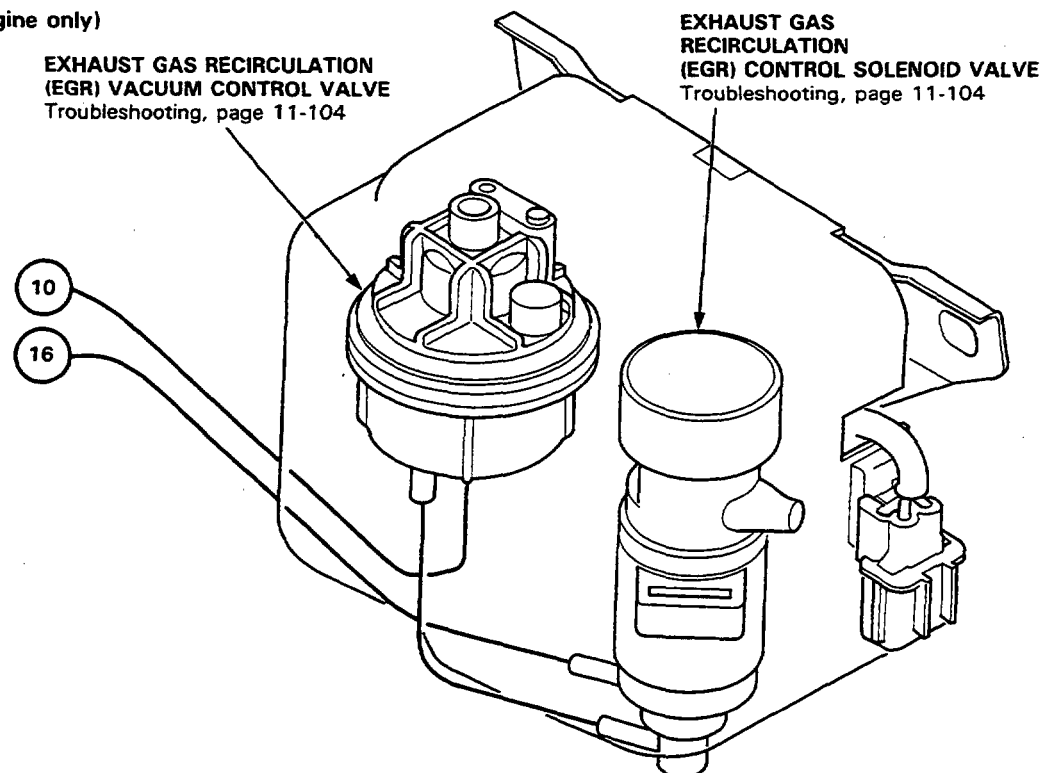

System Description

Vacuum Connections (D15Z3 engine)

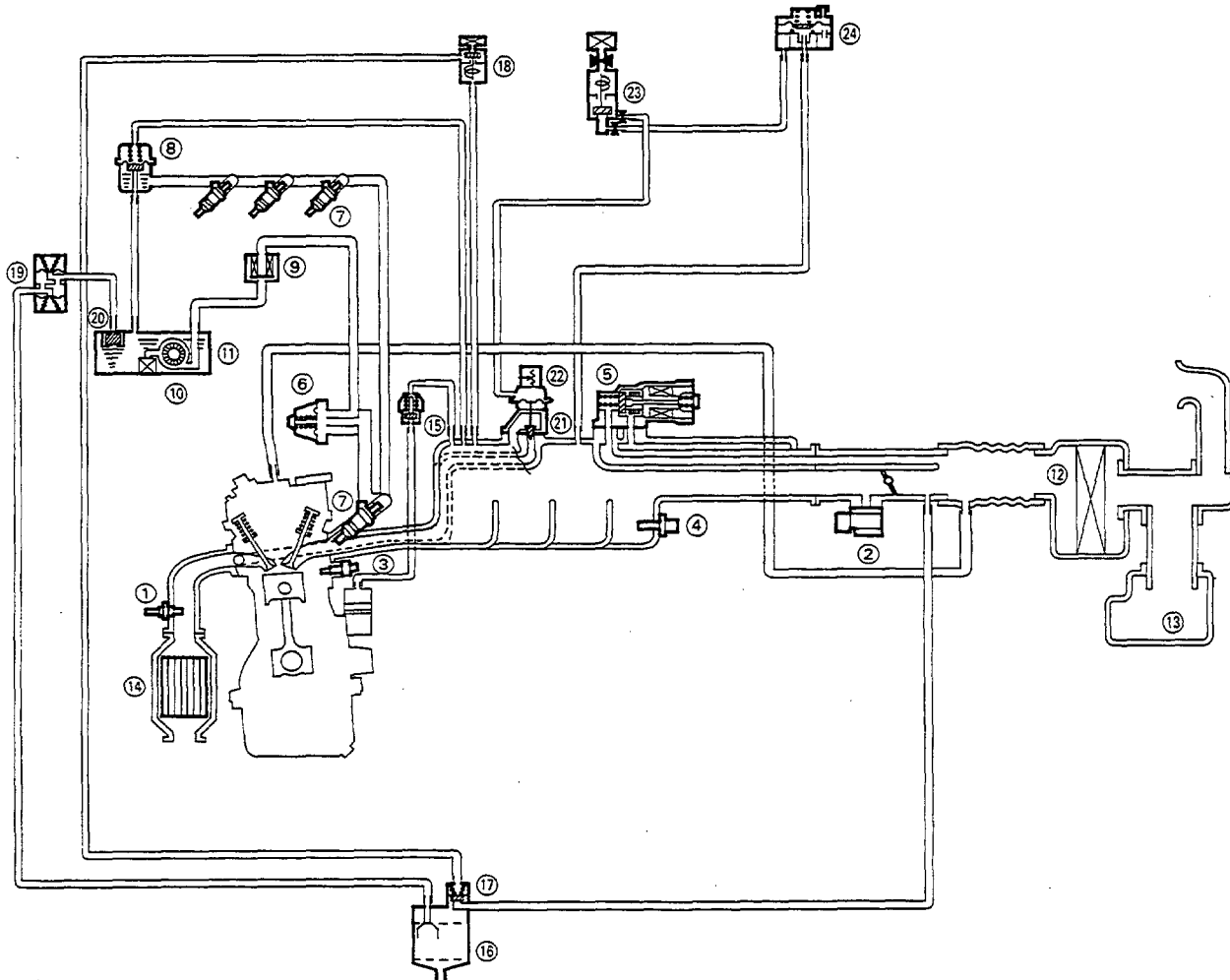

- ① HEATED OXYGEN SENSOR (HO2S)
- ② MANIFOLD ABSOLUTE PRESSURE (MAP) SENSOR
- ③ ENGINE COOLANT TEMPERATURE (ECT) SENSOR
- ④ INTAKE AIR TEMPERATURE (IAT) SENSOR
- ⑤ IDLE AIR CONTROL (IAC) VALVE
- ⑥ FUEL PULSATION DAMPER
- ⑦ FUEL INJECTOR
- ⑧ FUEL PRESSURE REGULATOR
- ⑨ FUEL FILTER
- ⑩ FUEL PUMP (FP)
- ⑪ FUEL TANK
- ⑫ AIR CLEANER (ACL)
- ⑬ RESONATOR
- ⑭ THREE WAY CATALYTIC CONVERTER (TWC)
- ⑮ POSITIVE CRANKCASE VENTILATION (PCV) VALVE
- ⑯ EVAPORATIVE EMISSION (EVAP) CONTROL CANISTER

- ⑰ EVAPORATIVE EMISSION (EVAP) PURGE CONTROL DIAPHRAGM VALVE
- ⑱ EVAPORATIVE EMISSION (EVAP) PURGE CONTROL SOLENOID VALVE
- ⑲ EVAPORATIVE EMISSION (EVAP) TWO WAY VALVE
- ⑳ FUEL TANK EVAPORATIVE EMISSION (EVAP) VALVE
- ㉑ EXHAUST GAS RECIRCULATION (EGR) VALVE
- ㉒ EXHAUST GAS RECIRCULATION (EGR) VALVE LIFT SENSOR
- ㉓ EXHAUST GAS RECIRCULATION (EGR) CONTROL SOLENOID VALVE
- ㉔ EXHAUST GAS RECIRCULATION (EGR) CONTROL VALVE



Vacuum Connections (Except D15Z3 engine)

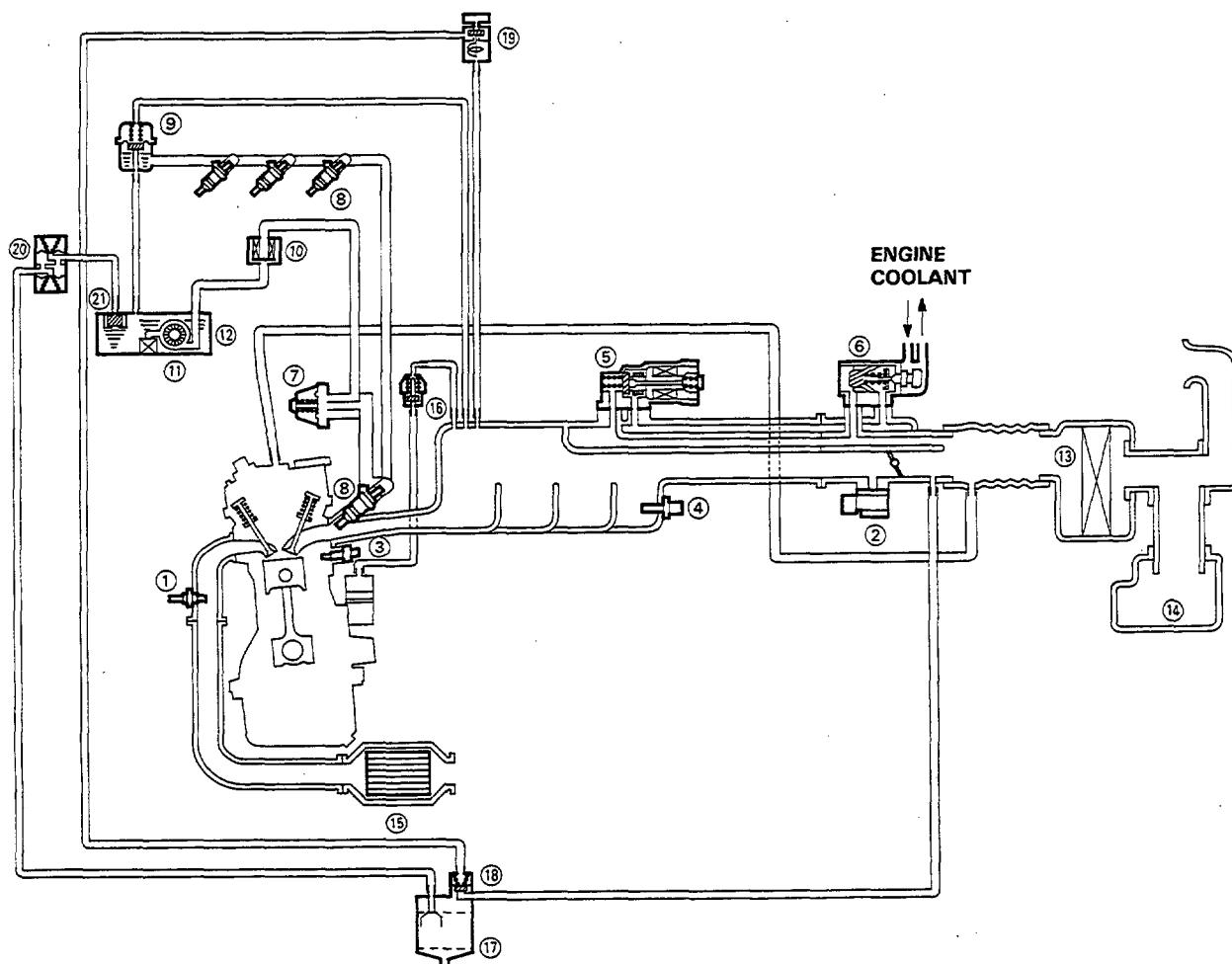

- ① OXYGEN SENSOR (O2S) (D16Y3, D14A2 engine)
- ① HEATED OXYGEN SENSOR (HO2S) (D16Y2 engine)
- ② MANIFOLD ABSOLUTE PRESSURE (MAP) SENSOR
- ③ ENGINE COOLANT TEMPERATURE (ECT) SENSOR
- ④ INTAKE AIR TEMPERATURE (IAT) SENSOR
- ⑤ IDLE AIR CONTROL (IAC) VALVE
- ⑥ FAST IDLE THERMO VALVE
- ⑦ FUEL PULSATION DAMPER
- ⑧ FUEL INJECTOR
- ⑨ FUEL PRESSURE REGULATOR
- ⑩ FUEL FILTER
- ⑪ FUEL PUMP (FP)
- ⑫ FUEL TANK

- ⑬ AIR CLEANER (ACL)
- ⑭ RESONATOR
- ⑮ THREE WAY CATALYTIC CONVERTER (TWC)
- ⑯ POSITIVE CRANKCASE VENTILATION (PCV) VALVE
- ⑰ EVAPORATIVE EMISSION (EVAP) CONTROL CANISTER
- ⑱ EVAPORATIVE EMISSION (EVAP) PURGE CONTROL DIAPHRAGM VALVE
- ⑲ EVAPORATIVE EMISSION (EVAP) PURGE CONTROL SOLENOID VALVE
- ⑳ EVAPORATIVE EMISSION (EVAP) TWO WAY VALVE
- ㉑ FUEL TANK EVAPORATIVE EMISSION (EVAP) VALVE