

Heater Unit

Replacement

CAUTION:

- All SRS wire harnesses are covered with yellow insulation.
- Replace the entire affected SRS harness assembly if it has an open circuit or damaged wiring.
- Before disconnecting the SRS wire harness, turn the ignition switch OFF, disconnect the battery negative cable, then disconnect the positive cable, and wait at least three minutes.
- Whenever the ignition switch is ON (II), or has been turned OFF for less than three minutes, be careful not to bump the SRS unit; the airbags could accidentally deploy and cause damage or injuries.
- Before you disconnect any part of an SRS wire harness, connect the short connectors (RED) to the airbags.
- For additional precautions, refer to page 23-B6 in the SRS sub-section.

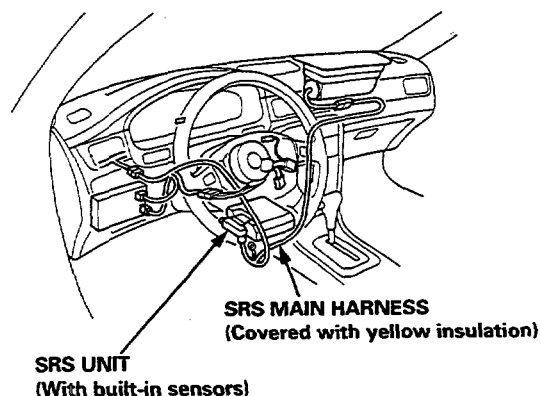

1. When the engine is cool, drain the engine coolant from the radiator (see section 10).

⚠ WARNING Do not remove the radiator cap when the engine is hot; the engine coolant is under pressure and could severely scald you.

2. Snap open the clamp and disconnect the heater valve cable from the heater valve arm.

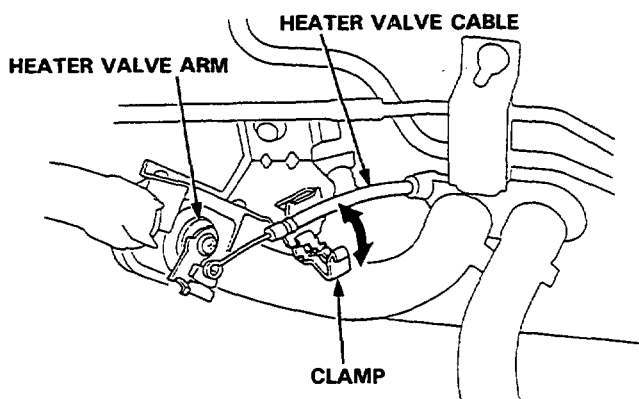

3. Disconnect the heater hoses from the heater unit.

CAUTION: Engine coolant will damage paint. Quickly rinse any spilled engine coolant from painted surfaces.

NOTE: Engine coolant will run out when the hoses are disconnected, drain it into a clean drip pan.

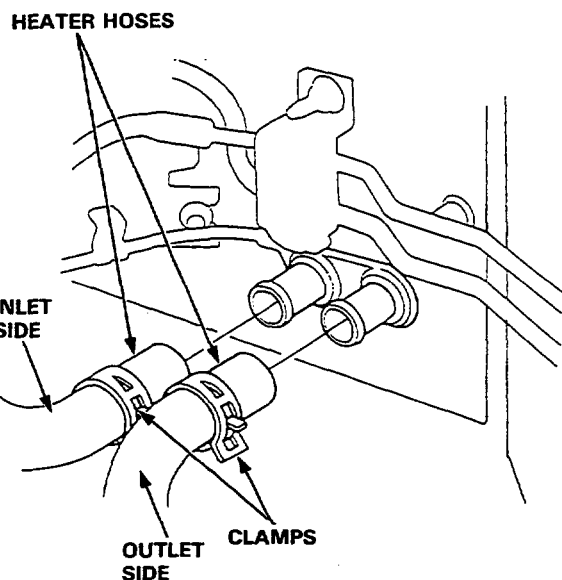

4. Remove the mounting nut from the heater unit.

NOTE: When removing the mounting nut, take care not to damage or bend the fuel pipes, brake pipes, etc.

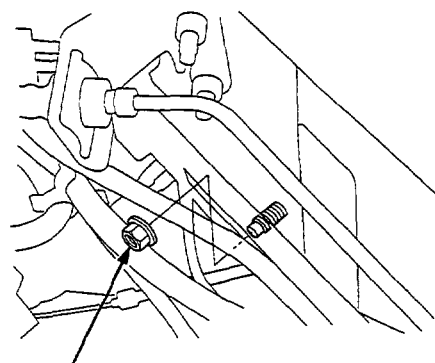

8 x 1.25 mm
22 N·m (2.2 kgf-m, 16 lbf-ft)



5. Remove the dashboard (see section 20).
6. Remove the heater duct (see page 21-12) or the evaporator (see page 22-21).
7. Remove the mounting bolts and the steering hanger beam.

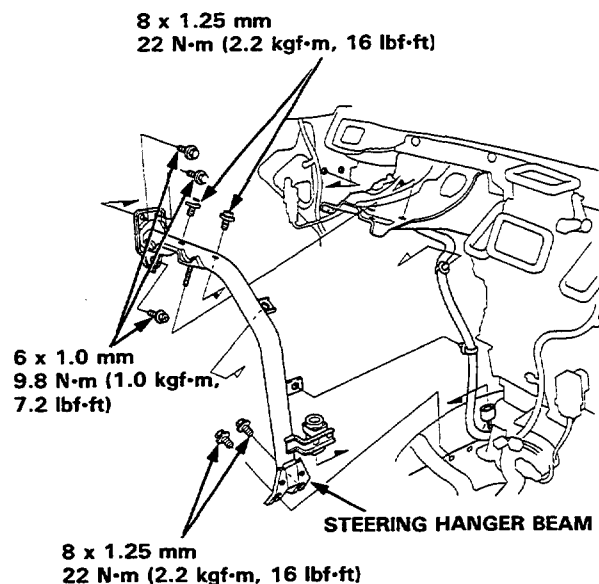

8. Remove the two mounting nuts and the heater unit.

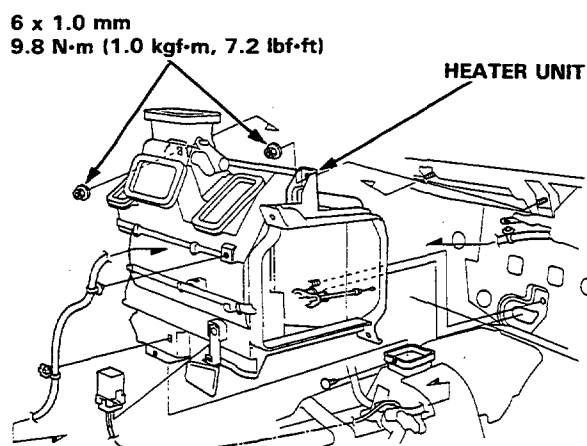

9. Install in the reverse order of removal, and:

- apply sealant to the grommets.
- do not interchange the inlet and outlet hoses. Make sure that the hose clamps are secure.
- loosen the bleed bolt on the engine and refill the radiator and coolant reservoir with the proper engine coolant mixture (see section 10). Tighten the bleed bolt when all the trapped air has escaped and engine coolant begins to flow from it (see section 10).
- connect all cables and make sure they are properly adjusted (see page 21-20, 21).