

Opener Cables

Replacement

NOTE:

- When removing the clips, use a clip remover.
- Take care not to bend the opener cables.

Hood Opener Cable:

A▷, LHD: 7
RHD: 5



B▷, 7



▷: Screw locations, 4

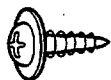

LHD:

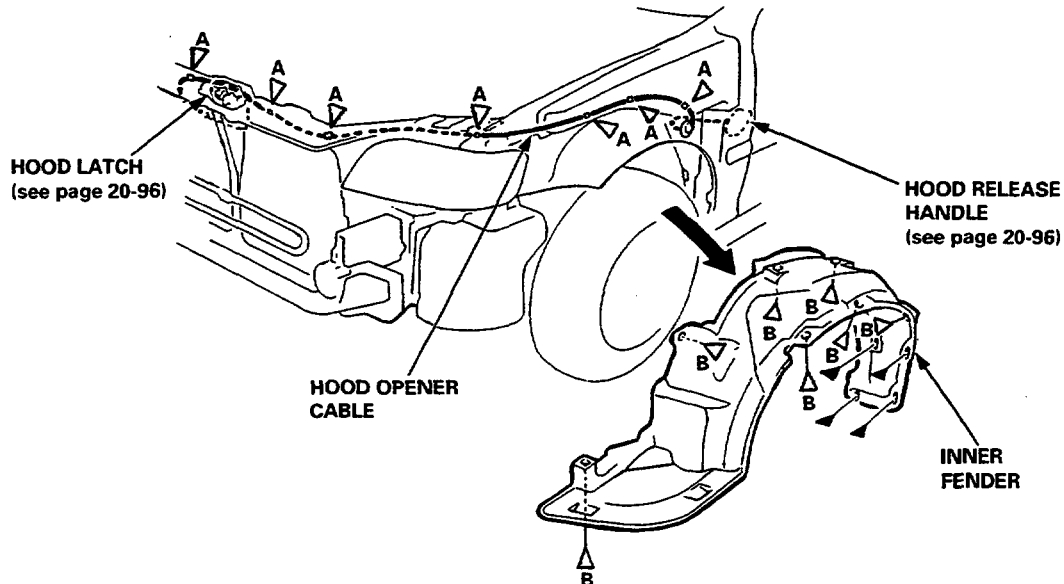

RHD:

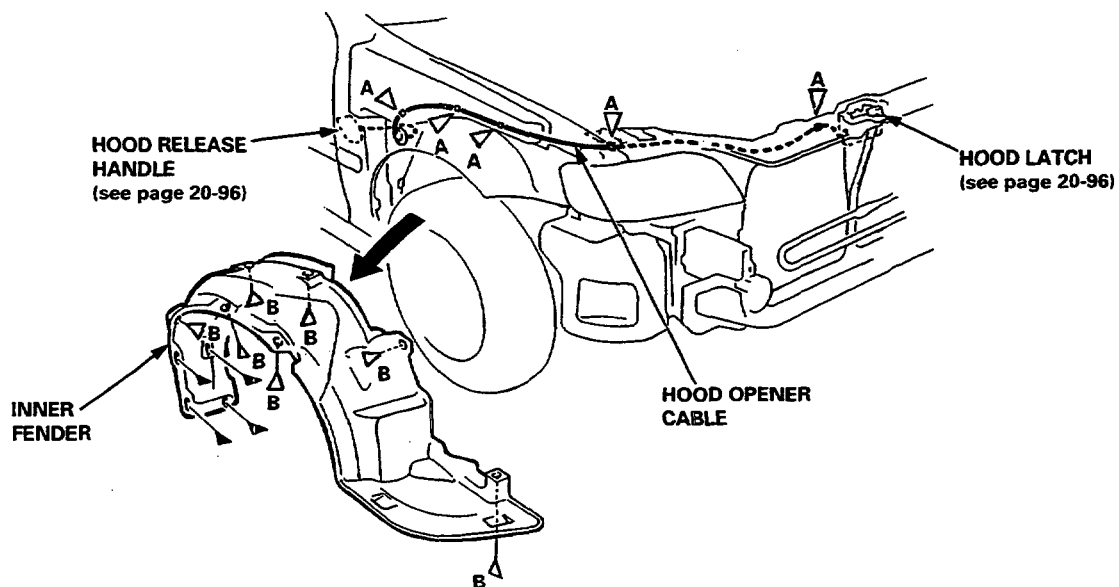



Tailgate/Fuel Lid Opener Cables:

Remove the following parts:

- Rear Seat-back and rear seat cushion (see page 20-66)
- Front and rear door sill moldings (see pages 20-55, 57)
- Center pillar lower trim (see page 20-56)
- Rear carpet (see page 20-76) and trunk mat (see page 20-58)
- Rear shelf, rear side shelf and rear seat side trim (see pages 20-56, 57)
- Rear trim panel and trunk side panel (see page 20-58)
- Pull the carpet back, as necessary (see page 20-75)

LHD:

▷: Clip, cable cushion locations

A▷, LHD: 9
RHD: 12

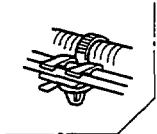

B▷, 2

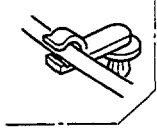

C▷, 2

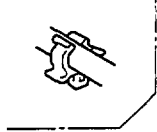

D▷, 1

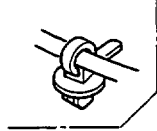

E▷, 1

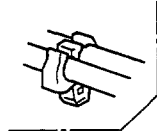

F▷, 2

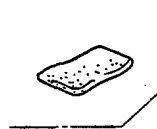

STRIKER
(see page 20-97)

Route the opener cable through the hole in the body.

FUEL LID LATCH
(see page 20-97)

TAILGATE OPENER CABLE

WIRE HARNESS

TAILGATE OPENER CABLE

FUEL LID OPENER CABLE

TAILGATE/FUEL LID OPENER
(see page 20-96)

RHD:

STRIKER
(see page 20-97)

Route the opener cable through the hole in the body.

FUEL LID LATCH
(see page 20-97)

FUEL LID OPENER CABLE

FUEL LID OPENER CABLE

WIRE HARNESS

TAILGATE OPENER CABLE

TAILGATE/FUEL LID OPENER
(see page 20-96)

Installation is the reverse of the removal procedure.

NOTE:

- Make sure each opener cable is routed and connected properly.
- Make sure the hood, tailgate and fuel lid open properly.